



Guide Price

£360,000

Freehold

NEWMANS CLOSE, WIMBORNE BH21 1XA



- ◆ TOWN CENTRE LOCATION
- ◆ SOUTH FACING RIVER VIEWS
- ◆ TWO DOUBLE BEDROOMS
- ◆ TWO BATHROOMS

A beautifully appointed and versatile two bedroom home boasting delightful river views as well as two full bathrooms, allocated off road parking and within close proximity to Wimborne Town Centre.

Property Description

The property sits within this development that was completed by Linden Homes in 2007 located along the bank of the River Stour. The development comprises a selection of two and three bedroom properties with this particular home benefiting from a prominent position that boasts river views. The accommodation comprises of a newly fitted kitchen with integrated appliances, living room and cloakroom on the ground floor and two double bedrooms and two fully refurbished bathrooms (one an ensuite) to the first floor. The ground floor also boasts a versatile cloaks cupboard and the home offers gas fired heating as well as double glazing throughout.

Gardens and Grounds

There is a paved courtyard style patio area which has a slight elevation over the river and gives a south facing aspect to enjoy the pleasant views.

Service Charge Details: £663.96 per annum paid half yearly (£331.98)

Location

Wimborne is a vibrant and thriving market town in East Dorset with a comprehensive mix of shopping facilities, restaurants, and attractions to appeal to everyone. Easily accessed by car from all directions via the A31, A35 and B3081 Wimborne has great public transport links to Bournemouth, Poole and surrounding areas including a comprehensive network of bus routes. Wimborne is immersed in a varied history, preserved and on-show in the c.705 AD Minster Church of Cuthburga with its chained library which is one of only four world-wide. The beautiful twin towers of the Minster provide an elegant backdrop to the town's historic architecture and alongside The Priest's House Museum & Gardens, Wimborne Model Town and the 1930's Art Deco Tivoli theatre, combine to make Wimborne a popular tourist attraction. Wimborne is well served by an excellent range of services for residents including doctors, a local hospital, a pyramid of sought-after schools and strong health and social care. Leisure facilities are well catered for and the town is within easy access to the county's areas of outstanding natural beauty offering miles of bridleways, footpaths and coastal routes to explore.



Size: 724 sq ft (67.3 sq m)

Heating: Gas fired (Combi) (Less than 1 yr old)

Glazing: Double glazed

Parking: 1 parking space

Garden: South facing

Main Services: Electric, water, gas, drains, telephone

Local Authority: Dorset Council

Council Tax Band: C

GROUND FLOOR
361 sq.ft. (33.5 sq.m.) approx.

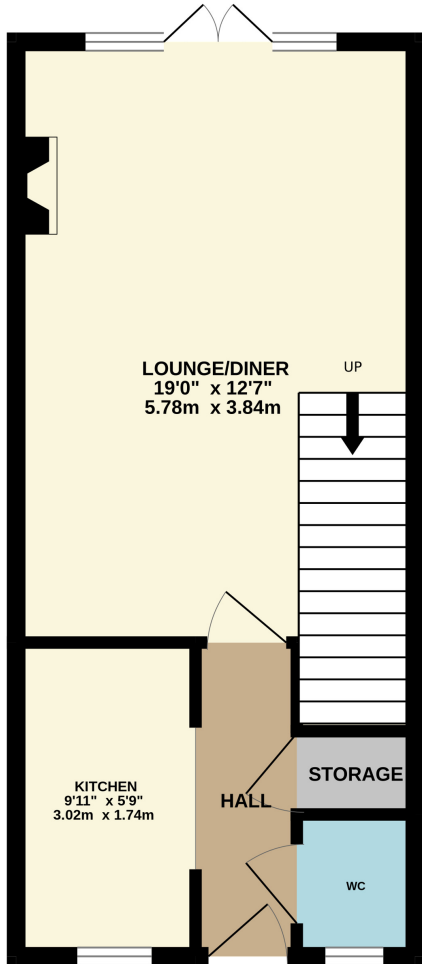

1ST FLOOR
364 sq.ft. (33.8 sq.m.) approx.

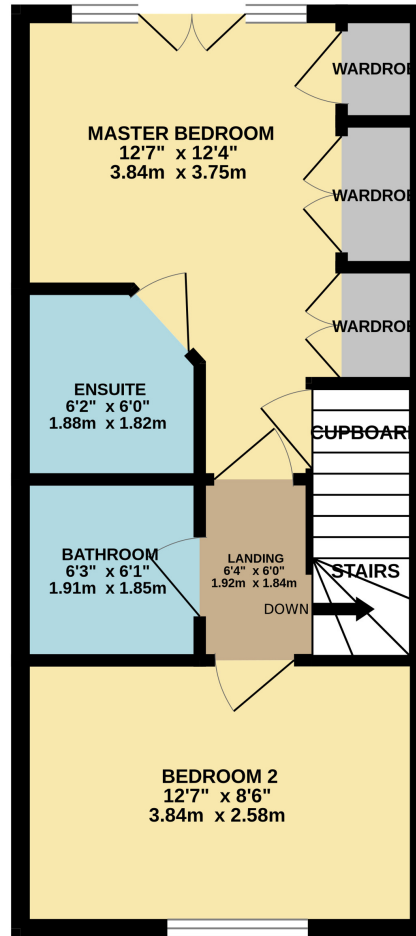

TOTAL FLOOR AREA : 724 sq.ft. (67.3 sq.m.) approx.
Measurements are approximate. Not to scale. Illustrative purposes only
Made with Metropix ©2024

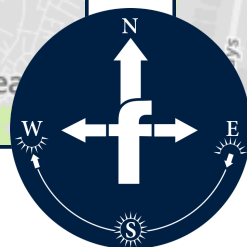
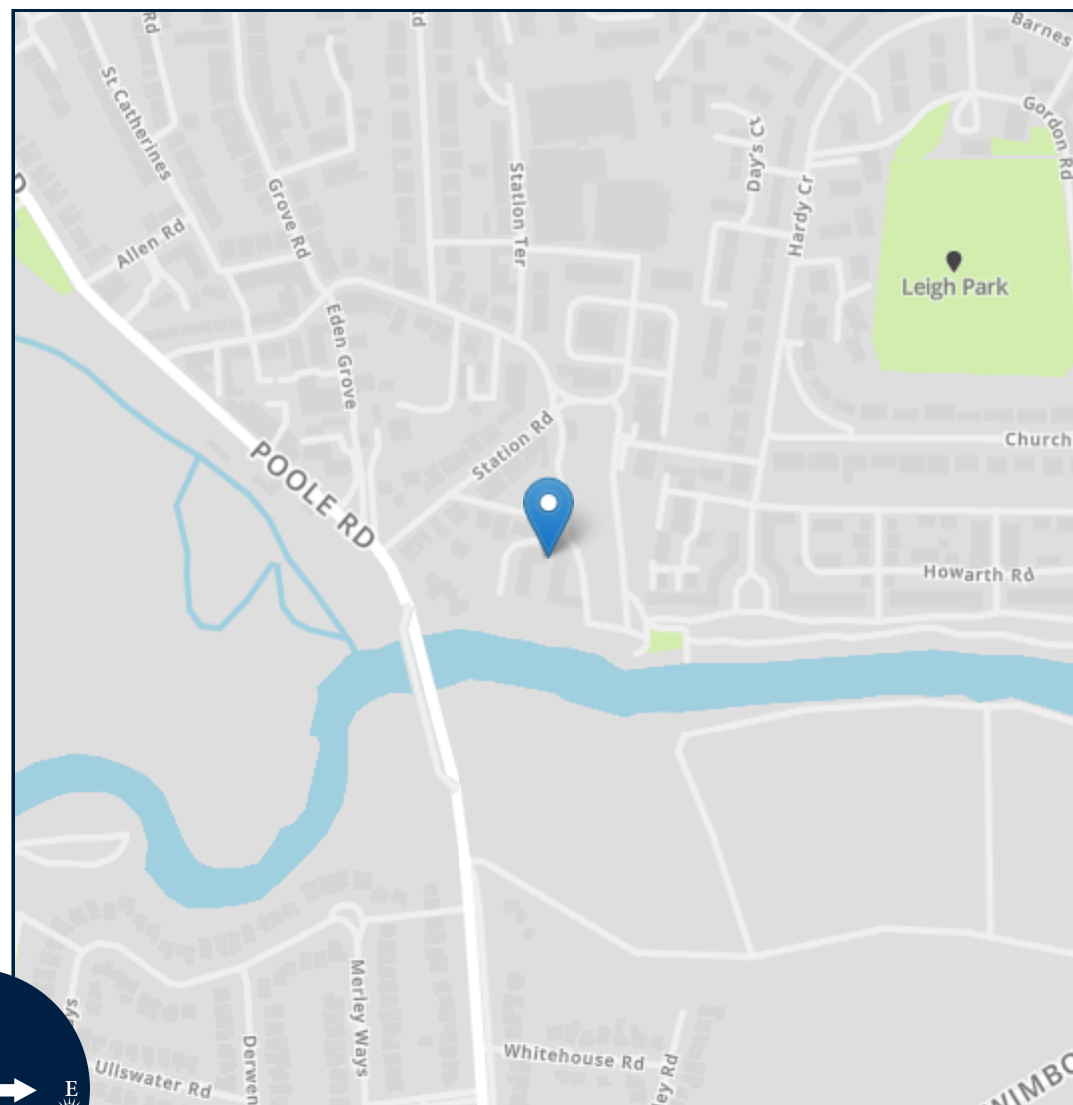
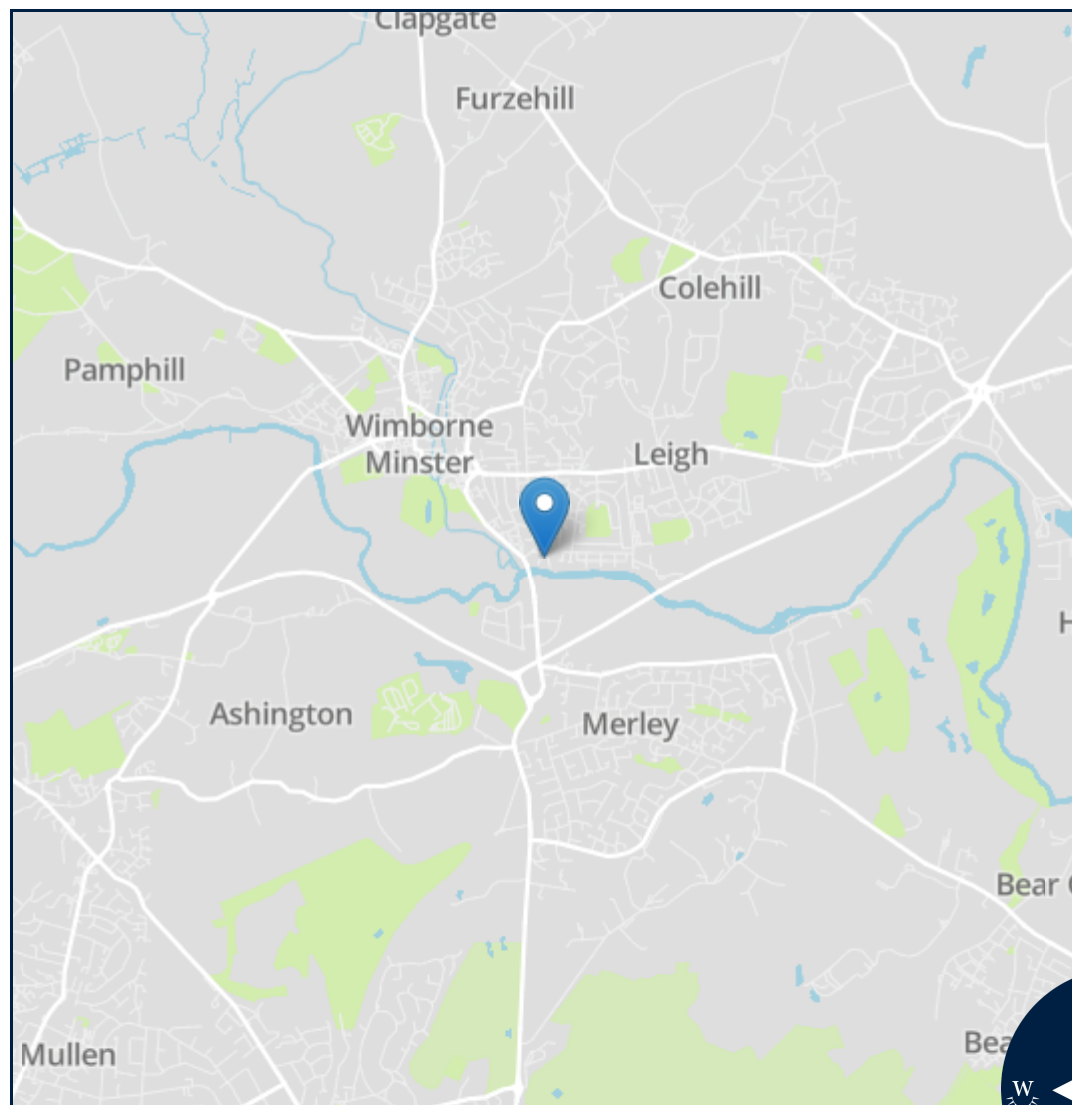

Energy Efficiency Rating		Current	Potential
Very energy efficient - lower running costs			
(92+)	A		
(81-91)	B		87
(69-80)	C	72	
(55-68)	D		
(39-54)	E		
(21-38)	F		
(1-20)	G		
Not energy efficient - higher running costs			
England, Scotland & Wales		EU Directive 2002/91/EC	



Important notice: Fisks Estate Agents, their clients and any joint agents give notice that 1: They are not authorised to make or give any representations or warranties in relation to the property either here or elsewhere, either on their own behalf or on behalf of their client or otherwise. They assume no responsibility for any statement that may be made in these particulars. These particulars do not form part of any offer or contract and must not be relied upon as statements or representations of fact. 2: Any areas, measurements or distances are approximate. The text, photographs and plans are for guidance only and are not necessarily comprehensive. It should not be assumed that the property has all necessary planning, building regulation or other consents and Fisks Estate Agents have not tested any services, equipment or facilities. Purchasers must satisfy themselves by inspection or otherwise.



12 East Street, Wimborne,
Dorset, BH21 1DS
www.fisksestateagents.co.uk
01202 880000