



Princess Road, Croydon, Surrey, CR0 2QY

£500,000 Freehold

- End of terrace
- Stunning Victorian home
- 22" lounge
- Double bedrooms with en-suite to master
- Off street parking
- Well maintained rear garden

Princess Road, Croydon, Surrey, CR0 2QY

£500,000 Freehold

Situated on the ever-popular Princess Road, this beautifully presented end-of-terrace family home offers the perfect blend of modern living with charming original features.

Boasting spacious accommodation throughout, this impressive property is ideal for families seeking style, comfort and convenience.

Princess Road

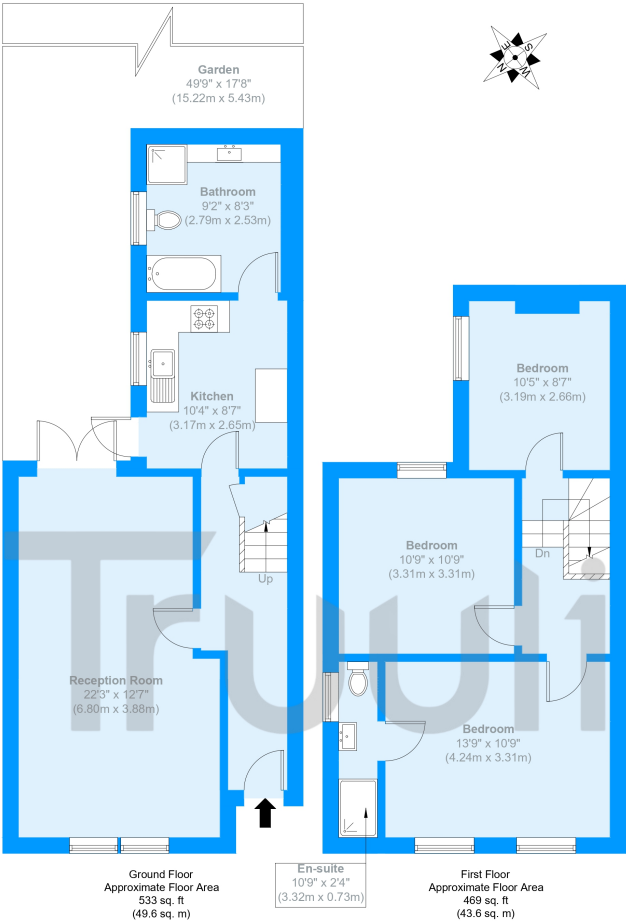

Approximate Gross Internal Area = 93.2 sq m / 1003 sq ft

The Floor plan is not to scale and measurements and areas shown are approximate and therefore should be used for illustrative purposes only. The plan has been prepared in accordance with the RICS code of Measuring Practice and whilst we have confidence in the information produced it must not be relied on. Maximum lengths and widths are represented on the floor plan. If there is any aspect of particular importance, you should carry out or commission your own inspection of the property.
Copyright © BleuPlan

