



Prime Street,
Northwood



OneAgency

01782 970222

hello@oneagencygroup.co.uk



£695 pcm

A one bedroom semi-detached bungalow within walking distance to Hanley Town Centre. The property benefits from gardens to front and rear, off road parking and well presented accommodation. Ideal for someone looking to downsize! The property is located close to amenities, commuter links and bus routes. Viewing is highly advised!





Ground Floor

Hallway

UPVC front door, storage cupboard, radiator and laminate flooring.

Lounge

5.37m x 2.95m (17' 7" x 9' 8") A double glazed window to the front and rear, gas fireplace, radiator and laminate flooring.

Kitchen

4.11m x 2.37m (13' 6" x 7' 9") A range of wall and base units with worktops, sink basin with mixer tap, space for a cooker, plumbing for a washing machine, space for a fridge/freezer, UPVC door to the rear, double glazed window, radiator and tiled flooring.

Bedroom

3.55m x 2.81m (11' 8" x 9' 3") A double glazed window, radiator and carpet flooring.

Wet Room

1.76m x 1.69m (5' 9" x 5' 7") A walk in shower with screen, pedestal hand wash basin, low level W/C, storage cupboard, tiled walls and vinyl flooring.

External

A paved private yard area with gated access and off road parking for one vehicle.

AGENTS NOTES

The council tax band is A. The local authority is Stoke-on-Trent.



GROUND FLOOR

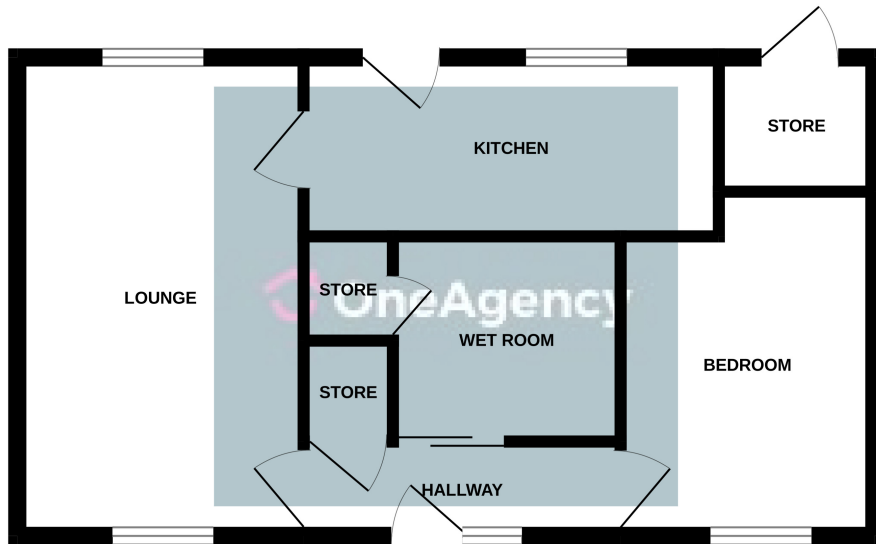

Whilst every attempt has been made to ensure the accuracy of the floorplan contained here, measurements of doors, windows, rooms and any other items are approximate and no responsibility is taken for any error, omission or mis-statement. This plan is for illustrative purposes only and should be used as such by any prospective purchaser. The services, systems and appliances shown have not been tested and no guarantee as to their operability or efficiency can be given.
Made with Metropix ©2024.



OneAgency, 9 & 10 Ridge House Drive, Festival Park, Stoke-on-Trent, ST1 5SJ

01782 970222

hello@oneagencygroup.co.uk

Every attempt has been made to ensure accuracy, however, all measurements are approximate and for illustrative purposes only. **Not to scale.**

In accordance with The Consumer Protection from Unfair Trading Regulations 2008 the following particulars have been prepared in good faith and they are not intended to constitute part of an offer or contract. We have not carried out a structural survey and the services, appliances and specific fittings have not been tested. All photographs, measurements, floor plans and distances referred to are given as a guide only and should not be relied upon for the purchase of carpets or any other fixtures and fittings. Lease details, service charges and ground rent (where applicable) are given as a guide only and should be checked and confirmed by your Solicitor prior to exchange of contracts.