

315 Vicarage Farm Road,
Hounslow, TW5 0DR

Tel: 02085707900
gavin@bluestateagents.co.uk



15 Houstoun Court, Vicarage Farm Road, Hounslow, Greater London, TW5 0DY

£229,950 Leasehold

- One Bedroom Second Floor Flat For Sale
- Perfect Property For Investors and First Time Buyers
- Large Reception Room with Linked Kitchen
- Family Bathroom Suite
- One Double Bedroom
- Allocated Parking And Parking For Visitors
- Situated Moments From Local Amenities, Reputable Schools and Bus Links
- 108 Year Lease
- Reasonable Service Charge / Ground Rent
- Contact Blue Estate Agents to Book Your Viewing Today
- EPC Rating





Blue Estate Agents bring to market this one bedroom apartment located just off Vicarage Farm Road, TW5. The property has a generous lease, low service charge and would be the perfect fit for first time buyers and investors. This apartment boasts, a double bedroom, a large reception room which leads on to a modern fitted kitchen. In addition to this, there is a family bathroom suite, allocated parking and use of communal garden. Further benefits include, gas central heating, double glazed windows and access to local amenities, reputable schools and ample bus routes within a short walk from the property. The property will have a related chain and is available to view by contacting a dedicated member at Blue Estate Agents.

Lease: 108 years remaining (125 years as of 9th January 2004)

Service Charge: £111.84 per month (as advised)

Ground Rent: £10.00 per annum (as advised)

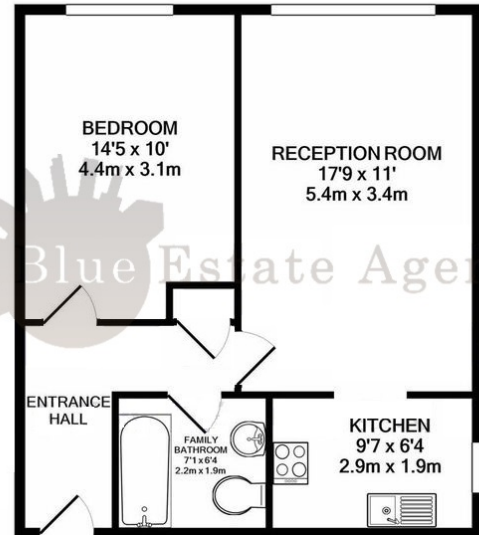

TOTAL APPROX. FLOOR AREA 508 SQ.FT. (47.2 SQ.M.)

Whilst every attempt has been made to ensure the accuracy of the floor plan contained here, measurements of doors, windows, rooms and any other items are approximate and no responsibility is taken for any error, omission, or mis-statement. This plan is for illustrative purposes only and should be used as such by any prospective purchaser. The services, systems and appliances shown have not been tested and no guarantee as to their operability or efficiency can be given
Made with Metropix ©2020

Reception Room

5.4m x 3.4m (17' 9" x 11' 2")

Kitchen

2.9m x 1.9m (9' 6" x 6' 3")

Bedroom

4.4m x 3.1m (14' 5" x 10' 2")

Bathroom Suite

2.2m x 1.9m (7' 3" x 6' 3")

Disclaimer

Whilst we have endeavoured to prepare our sales particulars accurately none of the services, appliances or equipment have been tested. A buyer should satisfy themselves on such matters prior to purchase. Any measurements or distances mentioned in these particulars are for guide reference only. If such particulars are fundamental to a purchase, buyers should rely on their own enquiries. All enquiries should be directed to Blue Estate Agents in the first instance.