

TO
LET



67 Spring Road, Feltham, Greater London. TW13 7JA

£1,525 pcm



54, Church Road, Ashford, TW15 2TS 01784 255 633 ashford@gregory-brown.co.uk

PROPERTY DESCRIPTION

Available immediately, this well-presented two-bedroom first floor maisonette is located on a popular residential road in Feltham and is offered unfurnished. The property features a spacious living area, separate kitchen, two good-sized bedrooms, and a family bathroom. Outside, the home benefits from a private garden and a garage, providing useful storage or off-street parking. Ideally situated close to local amenities, schools, and transport links, this property is perfect for professionals, couples, or small families. Early viewing is highly recommended.

POINTS OF INTEREST

- AVAILABLE NOW
- PRIVATE GARDEN
- GARAGE
- OFF ROAD PARKING
- WALKING DISTANCE TO HIGH STREET
- CLOSE TO BUS ROUTES
- FIRST FLOOR MAISONETTE
- PRIVATE ENTRANCE

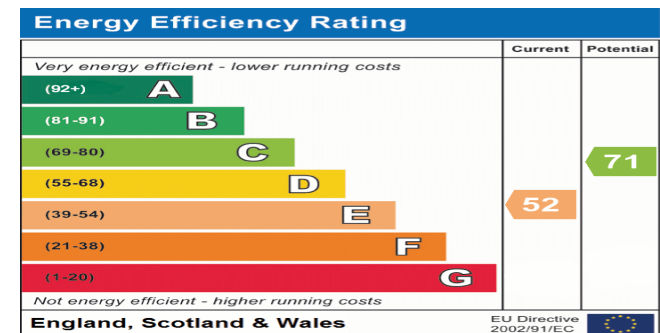

ROOM DESCRIPTIONS

FIRST FLOOR
603 sq.ft. (56.0 sq.m.) approx.

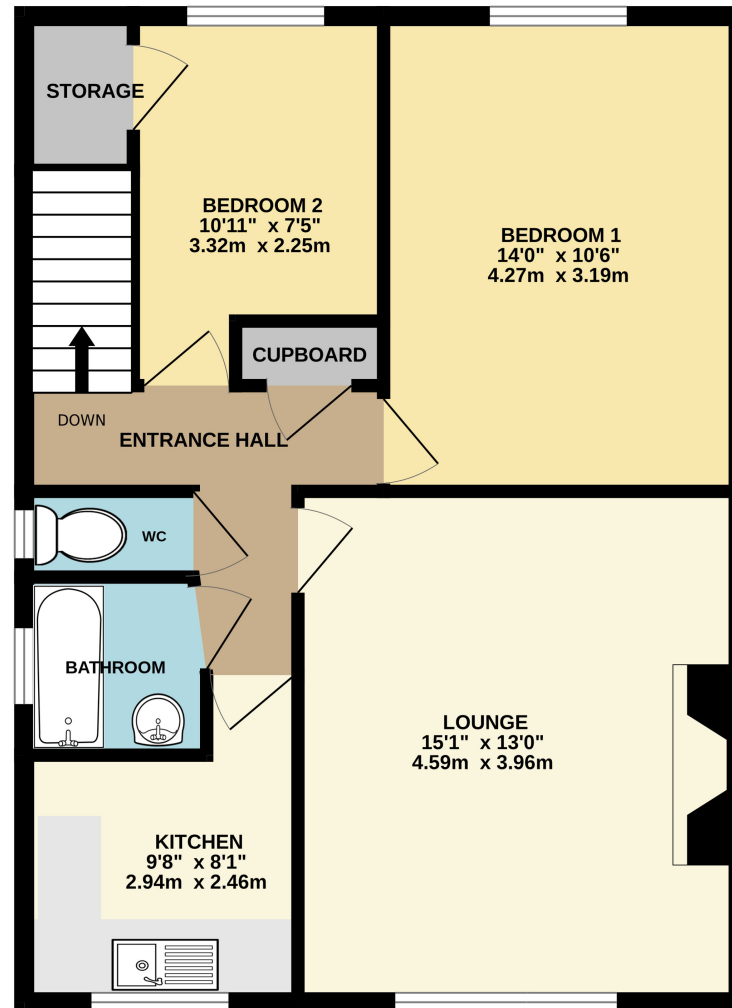

TOTAL FLOOR AREA : 603 sq.ft. (56.0 sq.m.) approx.

Whilst every attempt has been made to ensure the accuracy of the floorplan contained here, measurements of doors, windows, rooms and any other items are approximate and no responsibility is taken for any error, omission or mis-statement. This plan is for illustrative purposes only and should be used as such by any prospective purchaser. The services, systems and appliances shown have not been tested and no guarantee as to their operability or efficiency can be given.
Made with Metropix ©2025