



The Manor House

Bancroft, Hitchin,
Hertfordshire, SG5 1JW
Guide Price £900,000

COUNTRY PROPERTIES
PART OF HUNTERS

A stunning Grade II Georgian residence located in the heart of Hitchin town centre.

Formally the premises of Phillips of Hitchin antiques since 1884, this exceptional home has been refurbished to an exacting standard and is bursting with charm and character. Inside the property, you are greeted with an impressive open plan grand reception room with wonderfully high ceiling, sash windows and fireplace as well as a beautiful fitted kitchen with large central island. The ground floor also features a shower room/utility and separate W.C.

The incredible sweeping staircase leading up to the galleried landing, provides access to the two double bedrooms which our client has informed us feature wood panelling from Sir Isaac Newton's bedroom and the Master bedroom boasting its own luxury en-suite bathroom.

Outside, set behind the the imposing double gates is a low maintenance court yard garden and off road parking as well as a door providing access to the cellar, ideal for storage.

Hitchin is a charming medieval market town and has many fine Tudor and Georgian buildings, particularly around the market square. Near to the market square stands the large medieval parish church of St Mary. The town provides good shopping as well as a swimming pool, football team, two theatres, a wide variety of restaurants and pubs and highly regarded girls and boys schools. There is also a mainline railway station providing direct access to Kings Cross and Cambridge.

- Georgian
- Stunning condition
- Superb town centre location
- Sweeping staircase
- Grand reception room
- Parking
- Garden
- 0.8 miles, 15 min walk to Hitchin train station (as per Google maps)







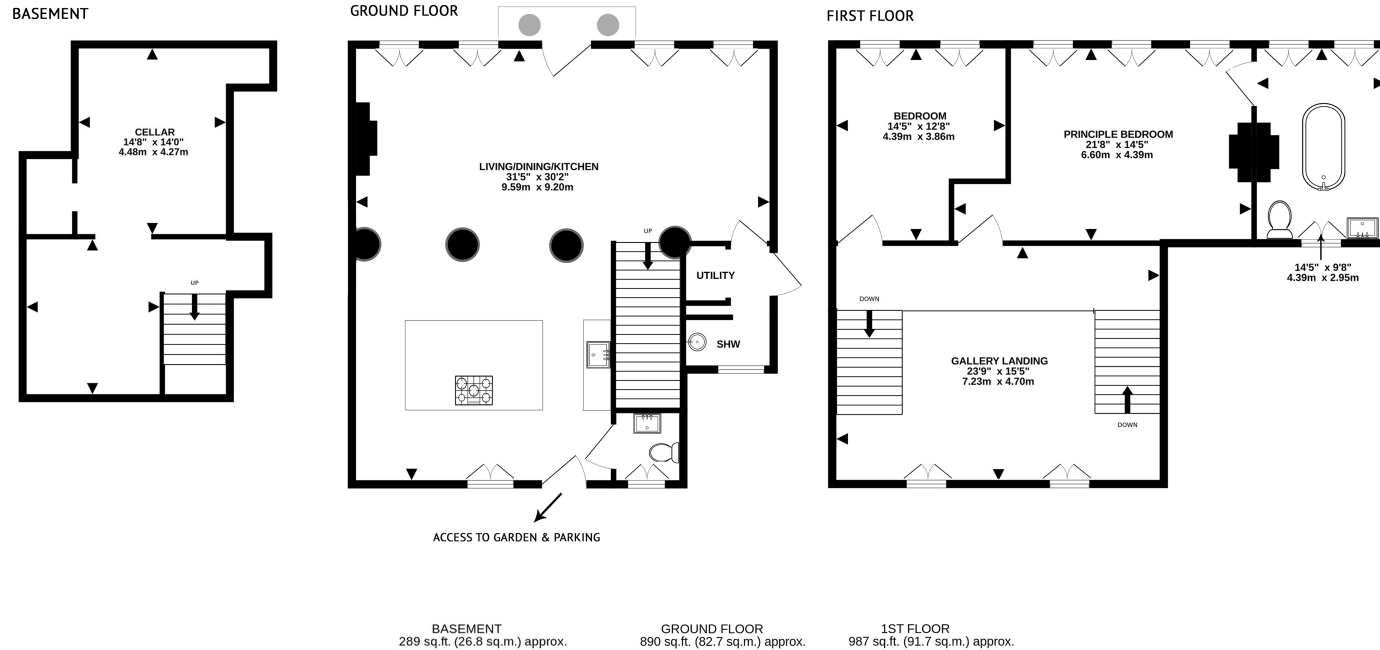

TOTAL APPROXIMATE FLOOR AREA 2165 SQ.FT. (201.1 SQ.M.)

produced & copyright by darrylrixonphotography on behalf of Country Properties, Hitchin Tel: 01462 452951

Whilst care is taken in the production of this floorplan, its intended use is solely for layout guidance only to assist you when making a decision to physically view the property in person. Windows, door opening, appliances, fixtures & fittings are only approximate & not guaranteed. When making a legal commitment to purchase you should personally check all dimensions, shapes & room layouts before making a final decision that you may later be reliant upon.

All measurements are approximate and quoted in metric with imperial equivalents and for general guidance only and whilst every attempt has been made to ensure accuracy, they must not be relied on. The fixtures, fittings and appliances referred to have not been tested and therefore no guarantee can be given and that they are in working order. Internal photographs are reproduced for general information and it must not be inferred that any item shown is included with the property. For a free valuation, contact the numbers listed on the brochure.

Viewing by appointment only

Country Properties | 6, Brand Street | SG5 1HX

T: 01462 452951 | E: hitchin@country-properties.co.uk

www.country-properties.co.uk





COUNTRY PROPERTIES

PART OF HUNTERS®
