

hastings
INTERNATIONAL



Rotherhithe Street

£225,000

Windsor Court Rotherhithe Street, London SE16 5SJ

Guide Price £225,000-£250,000 A well presented studio apartment with private balcony, side river views, secure allocated parking and share of freehold, located within King & Queen Wharf, a secure gated riverside development with concierge located moments from the Thames Path, Stave Hill Ecological Park and Surrey Quays Shopping Centre. The nearest station is Canada Water [Jubilee and Overground] with regular riverboat services to Canary Wharf via nearby Rotherhithe Pier.

Occupying part of the second floor, this well presented studio apartment comprises entrance hall with storage cupboard, generous reception room with dining area, French doors lead to private balcony providing side river views, sleeping area, open plan fitted kitchen with works tops and integrated appliances and bathroom. The apartment has the benefit of lift access, secure allocated parking, 24hr concierge facilities, residents swimming pool, spa and sauna and comes with a share of freehold.

- Windsor Court SE16
- Side River Views
- Well Presented Interior
- Concierge And Residents Pool
- Studio Apartment
- Private Balcony
- Riverside Development
- Excellent Location

Windsor Court, King & Queen Wharf, SE16

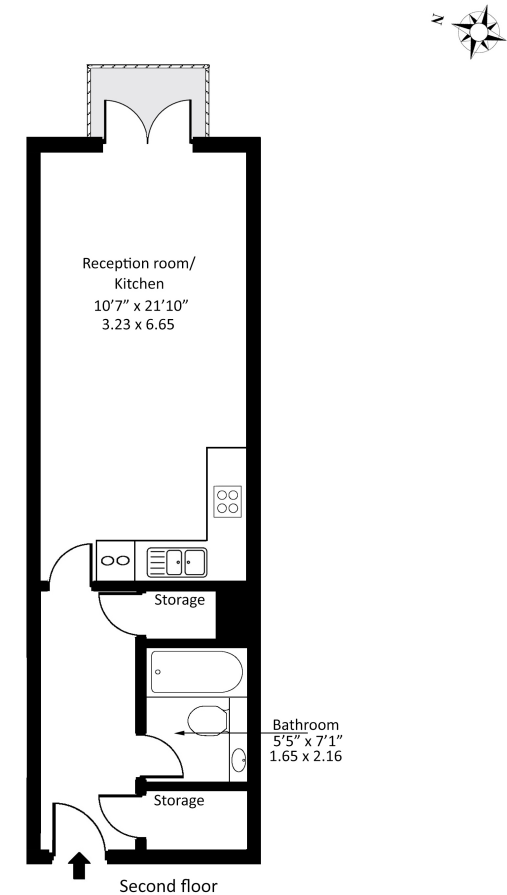

Approx gross internal area : 371 sq ft - 34.5 sq m

Measured in accordance with RICS guidelines. Every attempt is made to ensure accuracy
However all measurements are approximate.
The floor plan is illustrative purposes only and is not to scale





Energy Efficiency Rating		
	Current	Potential
Very energy efficient - lower running costs		
(92+) A		
(81-91) B		82
(69-80) C	71	
(55-68) D		
(39-54) E		
(21-38) F		
(1-20) G		
Not energy efficient - higher running costs		
England, Scotland & Wales	EU Directive 2002/91/EC	