



Glanmire | Billericay | £425,000



Glanmire

Billericay | Essex | CM11 1DU

The Property Specialists of Billericay are delighted to offer for sale this deceptively spacious three bedroom family house. This property is located on the sought after north side of Billericay, in a quiet cul de sac and within the catchment areas of Buttsbury Primary School and Mayflower High School.

The Property has been extended to the side to provide a fantastic size utility room and also there is a good conservatory to rear which provides a great space for entertaining.

In total there are three defined reception areas including a good size living room with feature fireplace which is in addition to spacious open plan entrance hallway and porch.

On the first floor there are three good size bedrooms and a large family bathroom with three piece suite and overhead shower.

The Property boasts a secluded rear garden and off-road parking to the front leading to an attached garage. The house also offers further potential to extend to the side.

An internal viewing is strongly advised to fully appreciate the size and space on offer.





- Extended Three Bedroom End Of Terraced House
- Spacious Entrance Porch / Hallway
- Large Utility Room
- Fitted kitchen With Dining Area
- Open Plan Double Glazed Conservatory
- Living Room With Feature Fireplace
- Three good Size Bedrooms
- Three Piece Family Bathroom With Shower Over
- Off Road Parking Leading To Attached Garage
- Quiet Cul De Sac Location



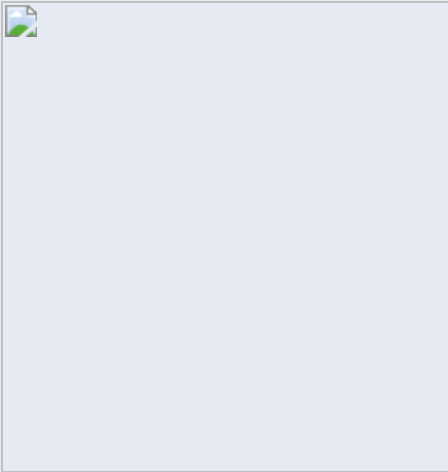
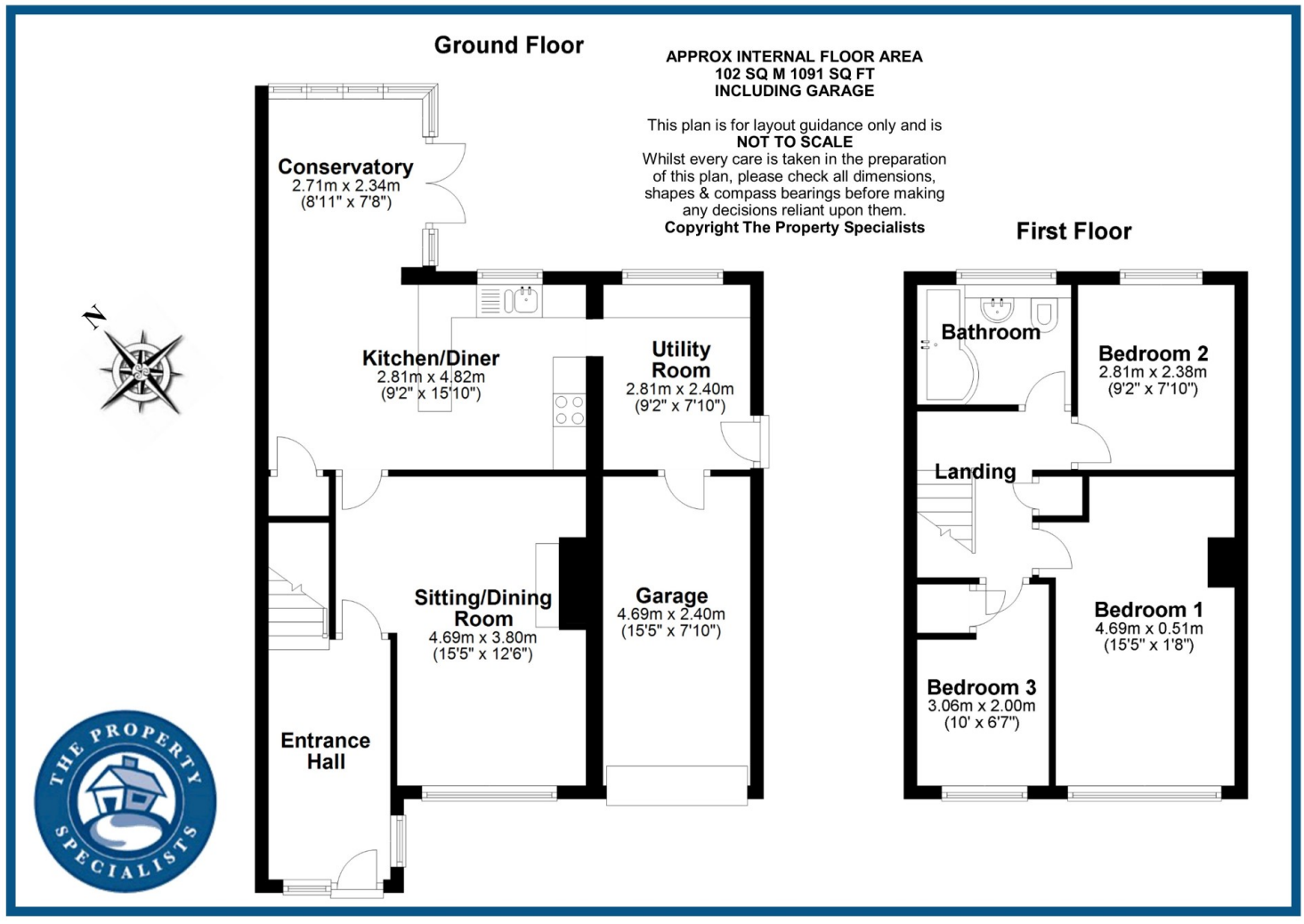

Viewing strictly by appointment with The Property Specialists



Making Moving Home
Less Stressful

135 High Street, Billericay,
Essex, CM12 9AB
Tel: 01277 654446
sales@thepropertyspecialists.co.uk