



Day & Co
ESTATE AGENTS

28 Cavendish Street
Keighley
BD21 3RG



7 North View Street, Beechcliffe,
Keighley, West Yorkshire, BD20
6AD

£95,000

T: 01535 664609

W: www.dayandcoestateagents.co.uk

E: keighley@dayandcoestateagents.co.uk

- THROUGH TERRACE
 - TWO DOUBLE BEDROOMS
 - NO ONWARD CHAIN
- REQUIRES MODERNISATION
 - FRONT GARDEN, REAR YARD
 - EPC RATING F

SUMMARY

** STONE THROUGH TERRACE, REQUIRES MODERNISATION, TWO DOUBLE BEDROOMS, SPACIOUS LOUNGE, PART DOUBLE GLAZED, FRONT GARDEN, REAR YARD, NO ONWARD CHAIN, EPC RATING F **

FULL DESCRIPTION

Situated in the Beechcliffe area of Keighley is this two double bedroom through terrace house which is in need of modernisation. In brief the accommodation comprises of an entrance vestibule, spacious lounge, kitchen, cellar. First Floor - landing, two double bedrooms and a shower room. Outside - front garden, yard to the rear. No onward chain. EPC Rating F.

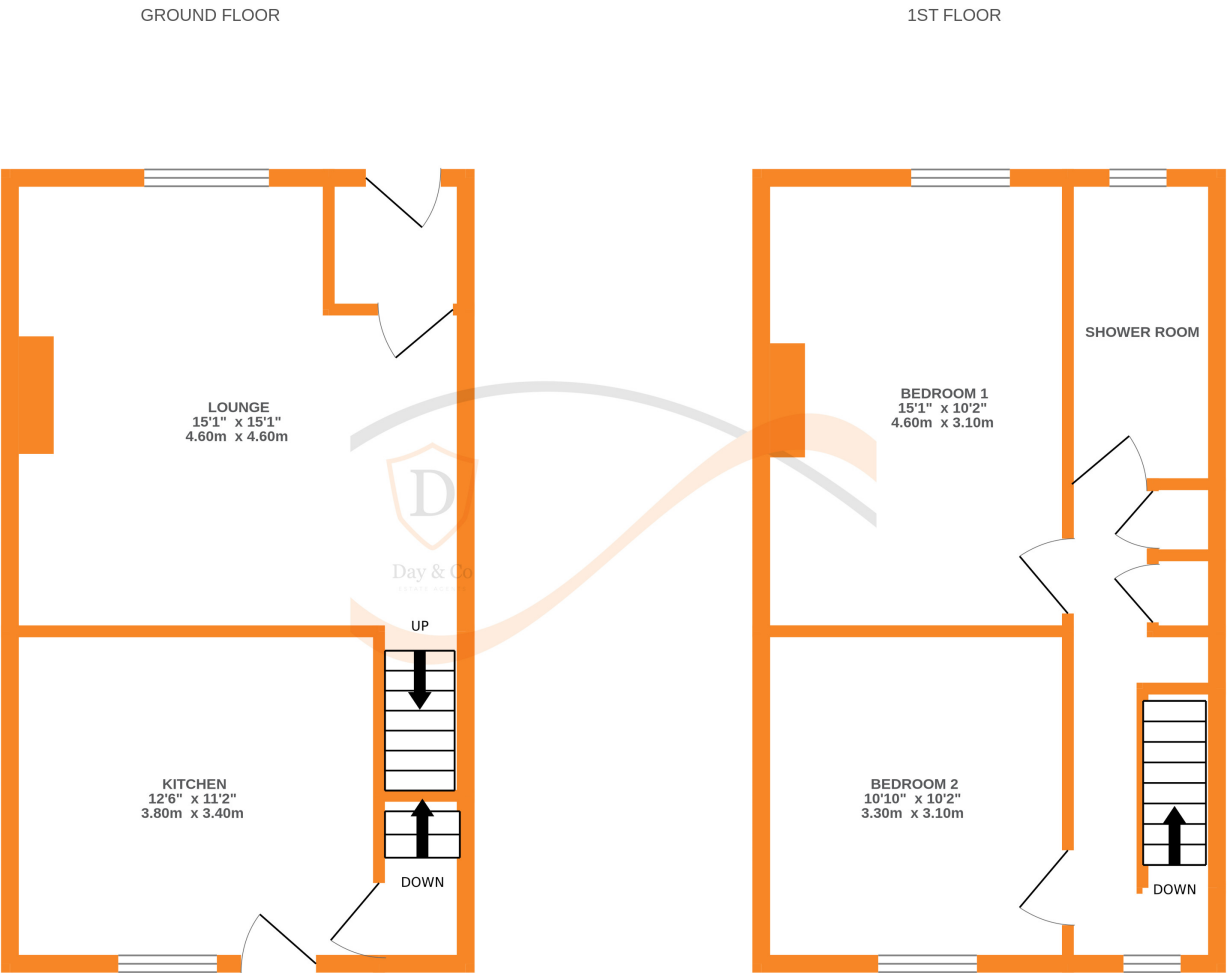

Whilst every attempt has been made to ensure the accuracy of the floorplan contained here, measurements of doors, windows, rooms and any other items are approximate and no responsibility is taken for any error, omission or mis-statement. This plan is for illustrative purposes only and should be used as such by any prospective purchaser. The services, systems and appliances shown have not been tested and no guarantee as to their operability or efficiency can be given.
Made with Metropix ©2025