



Two Bedroom Terraced House
Cookham Hill, Rochester, Kent, ME1 3HD

Guide Price £240,000
Freehold

Cookham Hill, Rochester, Kent, ME1 3HD

Guide Price £240,000

Freehold

Description

Guide Price £240,000 - £250,000 Set on Cookham Hill this two bedroom mid terraced house would make the perfect home for a first time buyer or investor due to its proximity to historic Rochester town centre with mainline station and riverside walks. The lounge is a cosy place to relax after a long day and the kitchen diner provides a great entertaining space. Leading off of the utility room, you will find a well sized bathroom and upstairs you will find 2 well sized double rooms. Call the Greyfox Sales Team today to arrange your viewing.

Key Features

- Walking distance to Rochester Town Centre
- Close to Amenities
- Riverside Walks
- Must be seen

Local Area

Historic Rochester offers a variety of historic buildings including Rochester Castle and Cathedral. The area also offers a variety of restaurants, coffee shops and bars. There is a selection of schools in the area including Rochester Grammar for girls and Sir Joseph Williamson Mathematical for boys, along with further secondary and Primary schools near by.

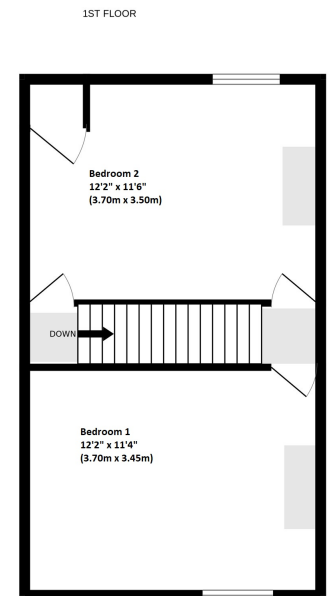
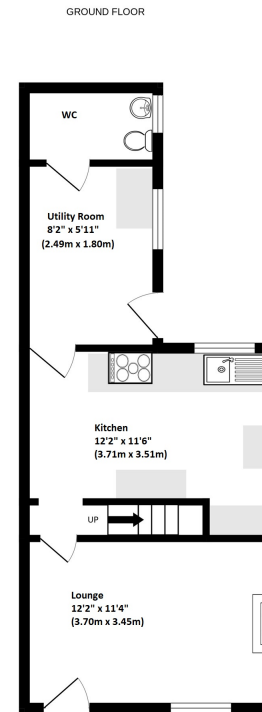



Property Location

Cookham Hill, Rochester, Kent, ME1 3HD

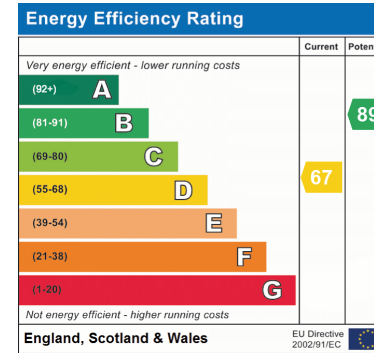
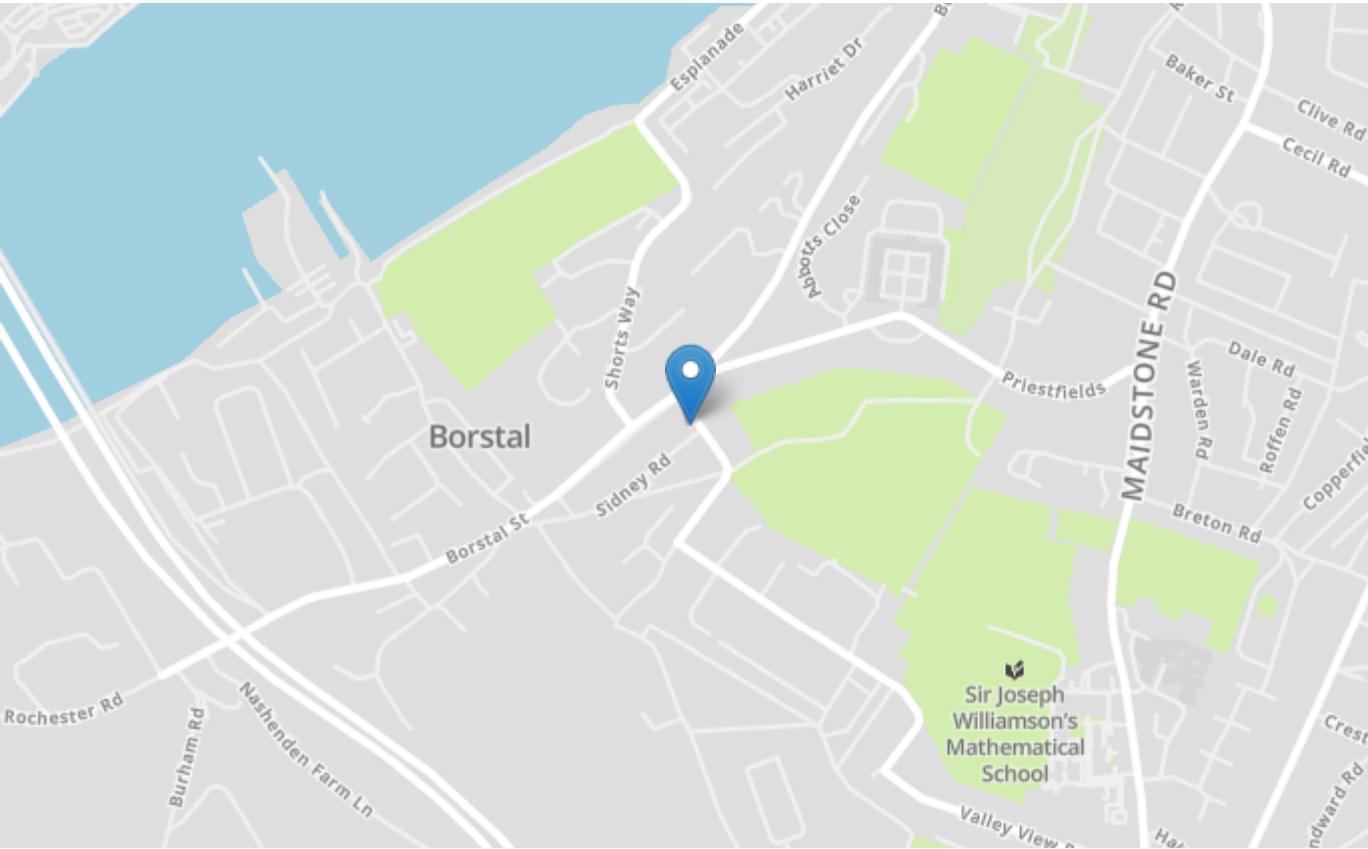

Tenure	Freehold
Lease Term	N/A
Ground Rent	N/A
Service Charge	N/A
Local Authority	Medway
Council Tax	Band B

Greyfox Walderslade

Unit 2, Thetford House
Walderslade Village Centre
Walderslade Road
Chatham
Kent
ME5 9LR
Tel: 01634 672227 Email:
walderslade@greyfox.co.uk

Greyfox Rainham

67C High Street
Rainham
Kent
ME8 7HS
Tel: 01634 377737 Email:
rainham@greyfox.co.uk

Agent Notes

These particulars are prepared as a general guide to a broad description of the property and should not be relied upon as a statement or representation of fact and do not constitute part of an offer or contract. The seller does not make or give nor do our employees or Greyfox have authority to make or give any representation or warranty to the property. We have not carried out a structural survey and the services, appliances and specific fittings have not been tested. All photographs, measurements, floorplans and distances referred to are given as a guide only and should not be relied upon for the purchase of carpets or any other fixtures or fittings. Lease details, service charges and ground rent (where applicable) and council tax are given as a guide only and should be checked and confirmed by you on inspection and your solicitor prior to exchange of contracts. If there are any points of particular importance to you we will be pleased to check the information for you and to confirm that the property remains available. This is particularly important should you be travelling some distance to view and where statements have been made by us to the effect that the information has not been verified. The copyright of all details, photographs and floorplans remain exclusive to Greyfox. For details of our privacy policy and referral fee arrangements with any of our selected partner companies please visit <https://www.greyfox.co.uk/legal/privacy> and <https://www.greyfox.co.uk/referral-fees>.