



Stamford Brook Road, London, W6 0XL

Cow & Co
LONDON



An imposing six bedroom period family offering excellent living accommodation throughout, spread over three floors and opening out onto a stunning landscaped garden. The property is bright, spacious with ample natural light with many original features.

Situated on the borders of Chiswick and Ravenscourt Park overlooking Stamford Brook common. Stamford Brook Underground station (District line) is approximately 0.3 miles. Turnham Green Underground station (District & Piccadilly lines) is approximately 0.5 miles and has excellent access to the shops on Turnham Green Terrace and Chiswick High Road. There is also easy access to central London via the A4, and to Heathrow Airport and the west of England via the M4



- Six bedroom family home
- Two large reception rooms
- Large kitchen diner leading onto a lovely sunny conservatory
- Spectacular view over Stamford Brook Common
- Impressive master bedroom with en-suite shower room.
- Excellent location close to amenities and transport links
- Well proportioned accommodation spread over three floors
- Well presented throughout with lots of natural light

Stamford Brook Road, London, W6

Approximate Area = 2552 sq ft / 237 sq m

Limited Use Area(s) = 22 sq ft / 2 sq m

Total = 2574 sq ft / 239 sq m

For identification only - Not to scale

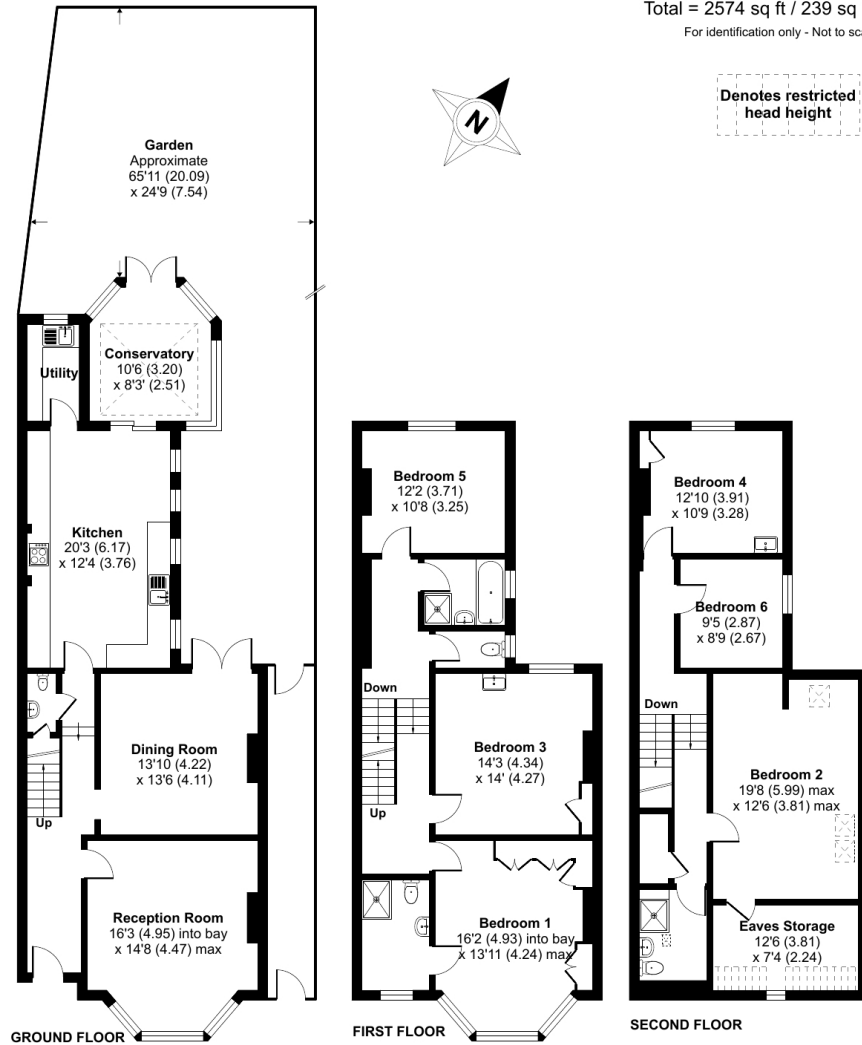

Floor plan produced in accordance with RICS Property Measurement Standards incorporating International Property Measurement Standards (IPMS2 Residential). © nchecon 2024. Produced for Cow & Co Properties Ltd. REF: 1105808

Tel: 0208 065 0010
 Email: thehub@cowandco-london.com
 Web: cowandco-london.com

Agents note: All measurements are approximate and whilst every attempt has been made to ensure accuracy they are for general guidance only and must not be relied on. The fixture and fittings referred to have not been tested and therefore no guarantee can be given that they are in working order. Internal photographs are reproduced for general information and it must not be inferred that any item shown is included with the property.

Cow & Co
 LONDON