

Offers Over £385,000
Howard Avenue, Bexley, Kent, DA5 3BB

Christopher
Russell
PROPERTY SERVICES



AGENTS NOTES: No statement in these particulars is to be relied upon as representations of fact and purchasers should satisfy themselves by inspection, or otherwise, as to the accuracy of the statements contained herein. These details do not constitute any part of any offer or contract. Christopher Russell have not tested any equipment or heating system mentioned and purchasers are advised to satisfy themselves as to their working order. Great care is taken when measuring but measurements should not be relied upon for ordering carpets, equipment etc.

Christopher Russell LLP. Registered in Cardiff. Partnership No. OC329088

Extended two bedroom terrace house situated within a short walk of Albany Park train station and Hurst Primary school.

The property has been subject to some modernisation which includes double glazed windows, modernised bathroom suite and a retired roof.

The property features gas central heating, off street parking and a rear garden extending over 100ft.

The property is offered chain free.

Council Tax Band D.



GROUND FLOOR
514 sq.ft. (47.8 sq.m.) approx.

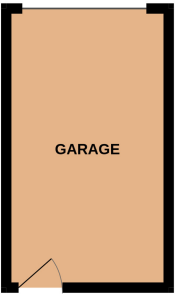

1ST FLOOR
269 sq.ft. (25.0 sq.m.) approx.

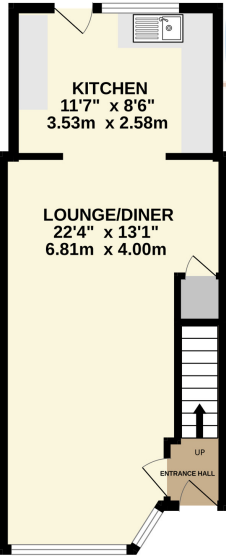
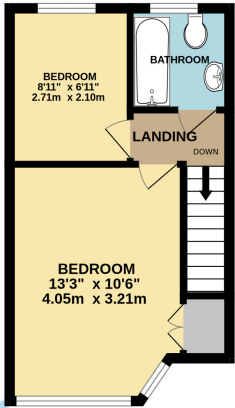

Christopher
Russell
PROPERTY SERVICES

TOTAL FLOOR AREA : 783 sq.ft. (72.7 sq.m.) approx.

Whilst every attempt has been made to ensure the accuracy of the floorplan contained here, measurements of doors, windows, rooms and any other items are approximate and no responsibility is taken for any error, omission or mis-statement. This plan is for illustrative purposes only and should be used as such by any prospective purchaser. The services, systems and appliances shown have not been tested and no guarantee as to their operability or efficiency can be given.
Made with Metropix ©2025