



11 Brisbane Street, Douglas, Isle of Man. IM1 3JH

Spacious traditional town house in need of some modernisation situated close to amenities.



£220,000 Freehold

PROPERTY DESCRIPTION

Accommodation This traditional town house is located close to amenities of town and offers spacious accommodation over 2 floors. The property would benefit from some modernisation.

On the ground floor there is an entrance vestibule leading to a traditional hallway providing access into the lounge, dining room and kitchen leading onto the utility room. From the utility is a door leading out to a paved patio area and lawned garden.

On the first floor there are 2 bedrooms and large family bathroom. An enclosed staircase provides access to a boarded attic space with Velux window.

The property is priced reasonably to sell and is offered with no onward chain.

THINKING OF SELLING? We are professionally qualified estate agents and licensed members of the National Association of Estate Agents (NAEA). We provide free of charge walk through valuations based on properties that have sold so the valuation is far more accurate and realistic in this buoyant market. We will also advise and listen to your thoughts and plans. Give us a call on 01624 61 99 66 or email us at info@manxmove.im

DISCLAIMER Whilst Manxmove Ltd believe that these details are correct, neither Manxmove Ltd or their clients guarantee their accuracy in any way. Consequently, these details are not to be used to form part of any legally binding contract. Prospective purchasers or tenants are advised to visit this property to satisfy themselves as to the correctness of these details. Please note, we use wide angle camera lenses in order to show as much of each room as possible. This is not intended to mislead any prospective purchasers or tenants in any way and an honest verbal description is always available prior to viewing if required.

FEATURES

- Traditional Town House
- In Need of Some Modernisation
- Town Centre Location
- Close to Amenities
- Lounge and Separate Dining Room
- Kitchen and Utility
- 2 Bedrooms plus Attic Room
- Front and Rear Garden
- No Onward Chain



Property Images



FLOORPLAN



GROUND FLOOR
577 sq.ft. (53.6 sq.m.) approx.

1ST FLOOR
492 sq.ft. (45.8 sq.m.) approx.

2ND FLOOR
207 sq.ft. (19.2 sq.m.) approx.

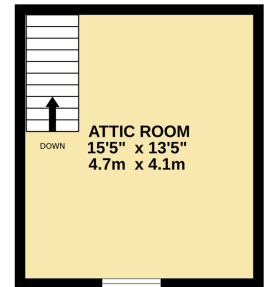
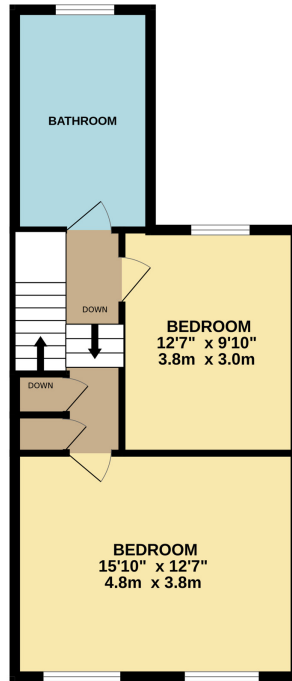
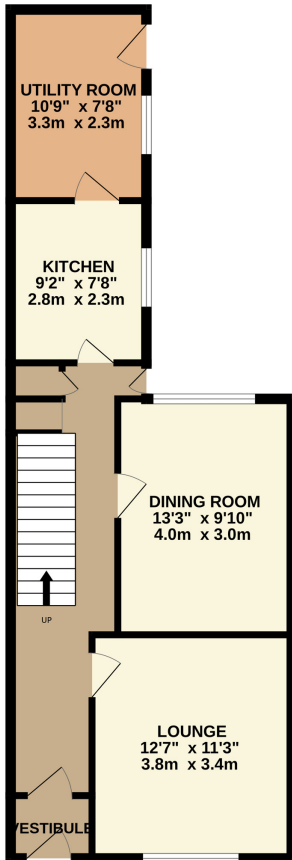

TOTAL FLOOR AREA: 1276 sq.ft. (118.5 sq.m.) approx.

Whilst every attempt has been made to ensure the accuracy of the floorplan contained here, measurements of doors, windows, rooms and any other items are approximate and no responsibility is taken for any error, omission or mis-statement. This plan is for illustrative purposes only and should be used as such by any prospective purchaser. The services, systems and appliances shown have not been tested and no guarantee as to their operability or efficiency can be given.
Made with Metropix ©2025

DISCLAIMER: Whilst Manxmove Ltd believe that these details are correct, neither Manxmove Ltd or their clients guarantee their accuracy in any way. Consequently, these details are not to be used to form part of any legally binding contract. Prospective purchasers or tenants are advised to visit this property to satisfy themselves as to the correctness of these details. Please note, we use wide angle camera lenses in order to show as much of each room as possible. This is not intended to mislead any prospective purchasers or tenants in any way and an honest verbal description is always available prior to viewing if required.

Manxmove Estate Agents - Douglas
Victoria Road, Douglas, IM2 4HD
01624 619966
info@manxmove.im