

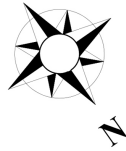

Westbere Road, London, NW2

£2,150 pcm

- Newly Refurbished Throughout
- First Floor Flat
- Furnished
- Two Bedroom Flat
- Family Bathroom
- Available 13th August 2024



Westbere Road NW2

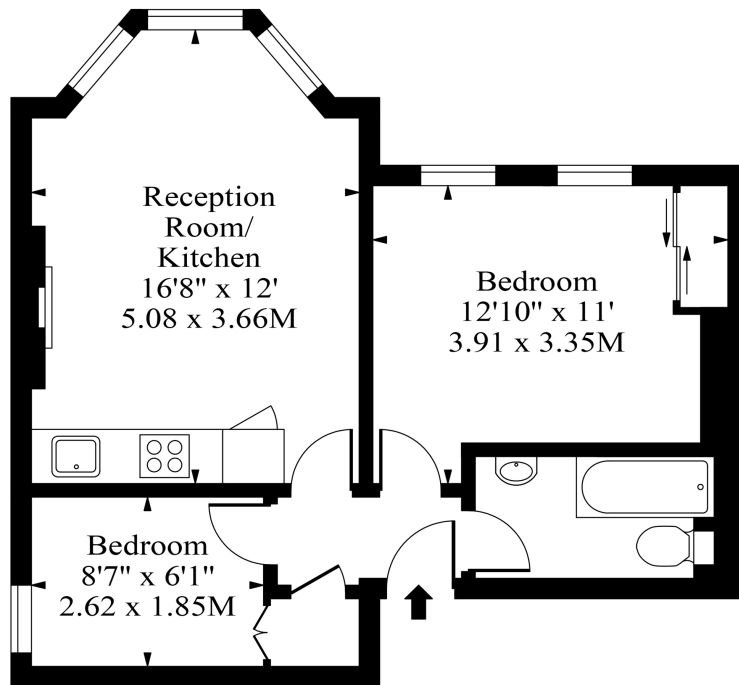

First Floor

Approx Gross Internal Area 452 Sq Ft - 41.99 Sq M

Measured in accordance with RICS guidelines. Every attempt is made to ensure accuracy

However all measurements are approximate.

The floor plan is illustrative purposes only and is not to scale

www.tomekphotography.co.uk

