

Truuli



Montague Road, Croydon, Surrey, CR0 3SS

£425,000 Freehold

- Central location, close to West Croydon Overground Station
- Large open plan downstairs
- Two double bedrooms
- Two bathrooms
- Wooden decking in the garden
- Boiler installed in November 2023
- Fully insulated loft
- Scope to extend into the loft
- Quiet road

Southbridge Place, Surrey, CR0 4HA

Tel: 0330 043 0002

Email: save@truuli.co.uk Web: www.truuli.co.uk

Montague Road, Croydon, Surrey, CR0 3SS

£425,000 Freehold

Vendor's comments: "'Monty Castle' was our first home together and we believe it was built in the 1930s. We have lived here since the summer of 1999 and our decision to move is quite bittersweet and purely based on us wanting to grow (even) older outside of the busier London Borough.

We are of course really close to everything, with lots of local shops, cafés, and restaurants right on our doorstep, as well as the town centre, green areas, and parks, plus a bus and 2 train stations all within a 5-15 minute walk and with frequent, fast links to central London and beyond."

Ground Floor
480 sq.ft. (44.6 sq.m.) approx.

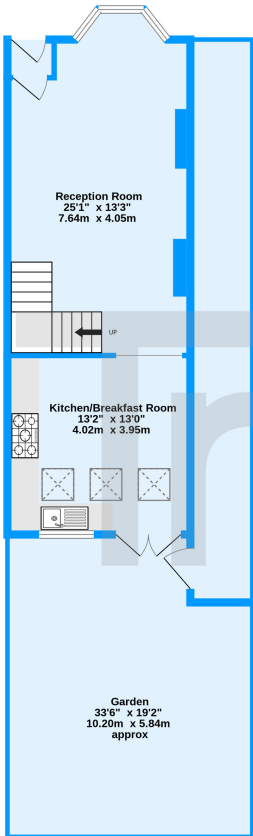

1st Floor
413 sq.ft. (38.4 sq.m.) approx.

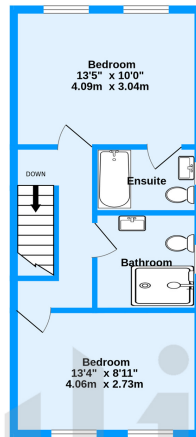

Montague Road, Croydon, CR0
TOTAL FLOOR AREA: 893 sq.ft. (82.9 sq.m.) approx.
Measurements are approximate. Not to scale. Illustrative purposes only.
Made with MetroPix ©2024

