



14 Mill Lane

Bold Heath

Widnes , WA8 3UU



0151 424 5100
info@mylerestates.com



Mill Lane

Bold Heath, Widnes , WA8 3UU

Asking Price - £450,000

This immaculate detached bungalow is currently on the market for sale. Positioned in an area renowned for its green spaces, the property is perfect for those who appreciate the tranquillity and beauty of nature.

The bungalow boasts an impressive three bedrooms, making it an ideal home for a growing family or for those who fancy a bit of extra space. The bedrooms, like the rest of the property, are in superb condition and offer a peaceful retreat from the hustle and bustle of daily life.

A key feature of this property is its exquisite kitchen. This space is brand-new and includes a dining area, allowing for family meals and entertaining guests. The quality of the fixtures and fittings in the kitchen is evident, demonstrating the care and attention that has gone into maintaining this property to a high standard.

The property also includes a comfortable reception room, perfect for relaxing evenings in or hosting friends and family. Like the rest of the house, the reception room is in impeccable condition and adds to the overall welcoming atmosphere of the property.

Additionally, the property features a newly refurbished, well-appointed bathroom, which serves the three bedrooms. Clean lines and modern fixtures contribute to the overall pristine condition of the bungalow.

In summary, this detached bungalow is a fantastic opportunity to acquire a property that has been maintained to an immaculate standard, located in a desirable area with easy access to green spaces.



MYLER&Co

MYLER&Co



Ground Floor

Entrance Porch

Entrance Hall

Lounge

5.42m x 3.94m (17' 9" x 12' 11")

Kitchen/Diner

2.85m x 6.74m (9' 4" x 22' 1")

Bedroom One

4.81m x 3.30m (15' 9" x 10' 10")

Bedroom Two

3.65m x 4.26m (12' 0" x 14' 0")

Bedroom Three

4.28m x 3.41m (14' 1" x 11' 2")

Bathroom

Utility Room

1.49m x 1.93m (4' 11" x 6' 4")

Externals

Driveway

Rear Garden



14 Mill Lane, WA8 3UU

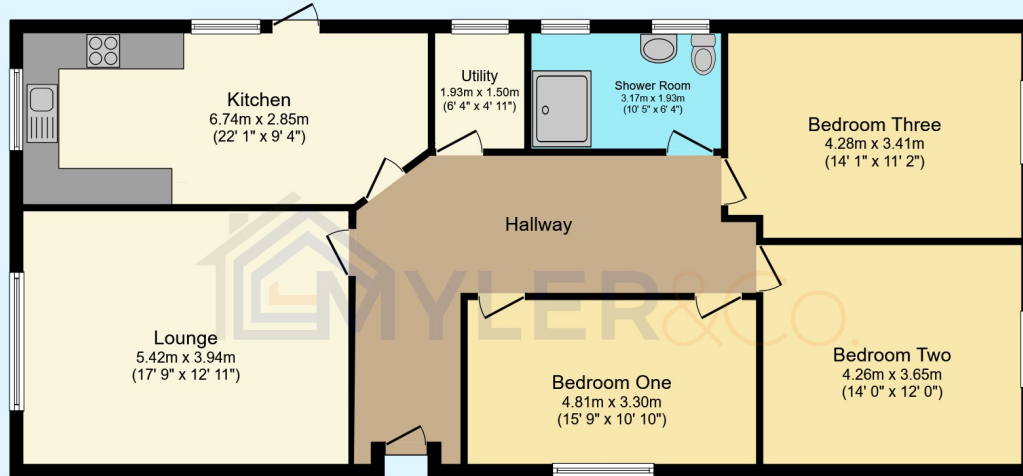

Floor Plan

Floor area 118.4 sq.m. (1,274 sq.ft.)

Total floor area: 118.4 sq.m. (1,274 sq.ft.)

This floor plan is for illustrative purposes only. It is not drawn to scale. Any measurements, floor areas (including any total floor area), openings and orientations are approximate. No details are guaranteed, they cannot be relied upon for any purpose and do not form any part of any agreement. No liability is taken for any error, omission or misstatement. A party must rely upon its own inspection(s). Powered by www.Propertybox.io

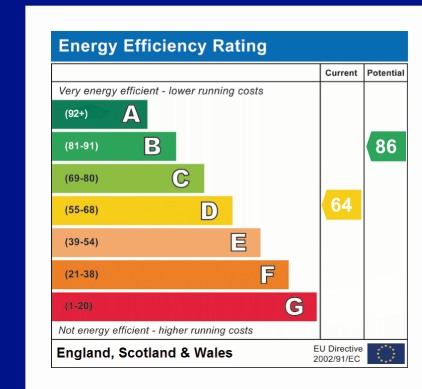

Myler & Co

77, Albert Road, Widnes, Cheshire, WA8 6JS

0151 424 5100

info@mylerestates.com