

7 Sunray Avenue, Bromley, Kent, BR2 8EN

**Property Images**





### Ground Floor

Approx. 41.2 sq. metres (443.1 sq. feet)

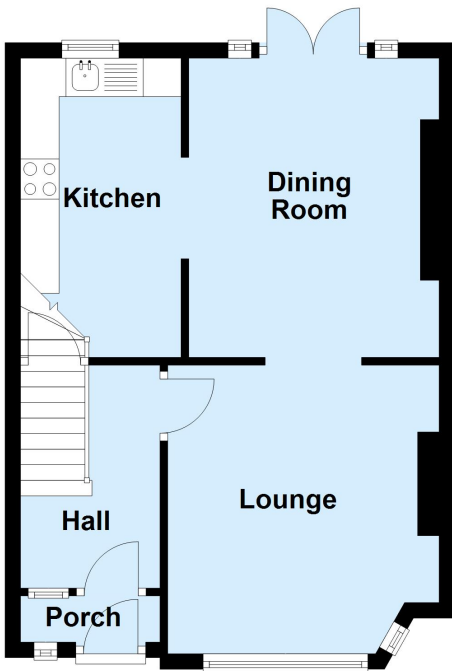

### First Floor

Approx. 44.2 sq. metres (476.2 sq. feet)

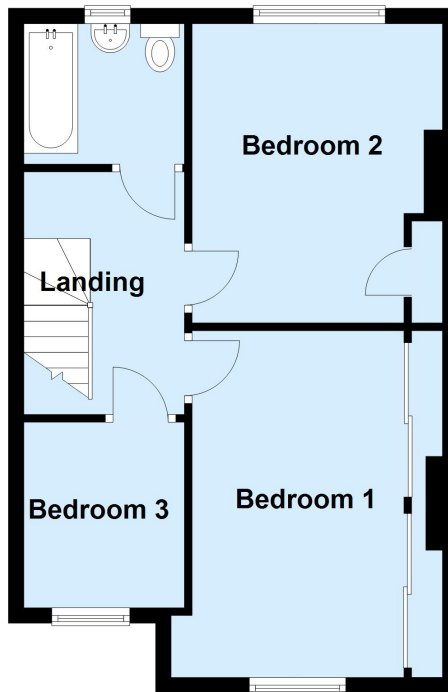

### Outbuilding

Approx. 19.0 sq. metres (204.3 sq. feet)

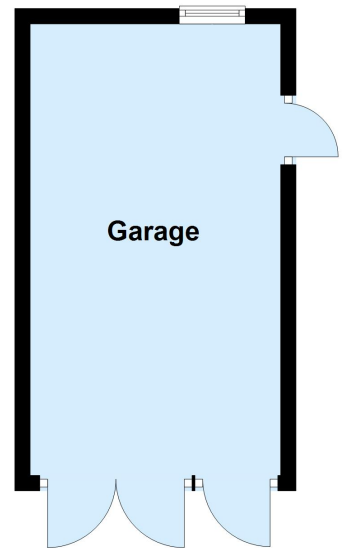

Total area: approx. 104.4 sq. metres (1123.6 sq. feet)

This plan is for general layout guidance and may not be to scale.  
Plan produced using PlanUp.