

FOR SALE

£325,000

Deverill Court, Avenue Road, London, SE20



A refurbished three bedroom apartment with a share of freehold, located close to Penge High Street and Kent House train station. Offered chain free and comes with gated off street parking, communal gardens, large private storage unit and a communal roof terrace with 360 views of London.

A spacious three bedroom apartment in excellent condition throughout, which has been completely refurbished by the current owner and making it ideal for first-time buyers or investors alike.

This inviting home offers three generously sized bedrooms, a modern family bathroom with separate toilet, a bright lounge filled with natural light, and a separate fitted eat-in kitchen with excellent storage and workspace. Further benefits include new flooring, ample storage, new radiators, gated off street parking and an outside private storage unit.

Residents will also love the stunning communal roof terrace with panoramic views and beautifully maintained communal gardens – perfect for unwinding or entertaining.

Perfectly positioned, the property is just moments from multiple train stations, bus routes, and the lively Penge High Street, with its array of shops, cafés, restaurants, and independent businesses.

- Share of Freehold
- Three Bedrooms
- Secure Off Street Parking
- Roof Terrace
- Communal Gardens & Storage Unit
- EPC Rating D





Avenue Road, London, SE20

Approximate Area = 877 sq ft / 81.5 sq m

For identification only - Not to scale

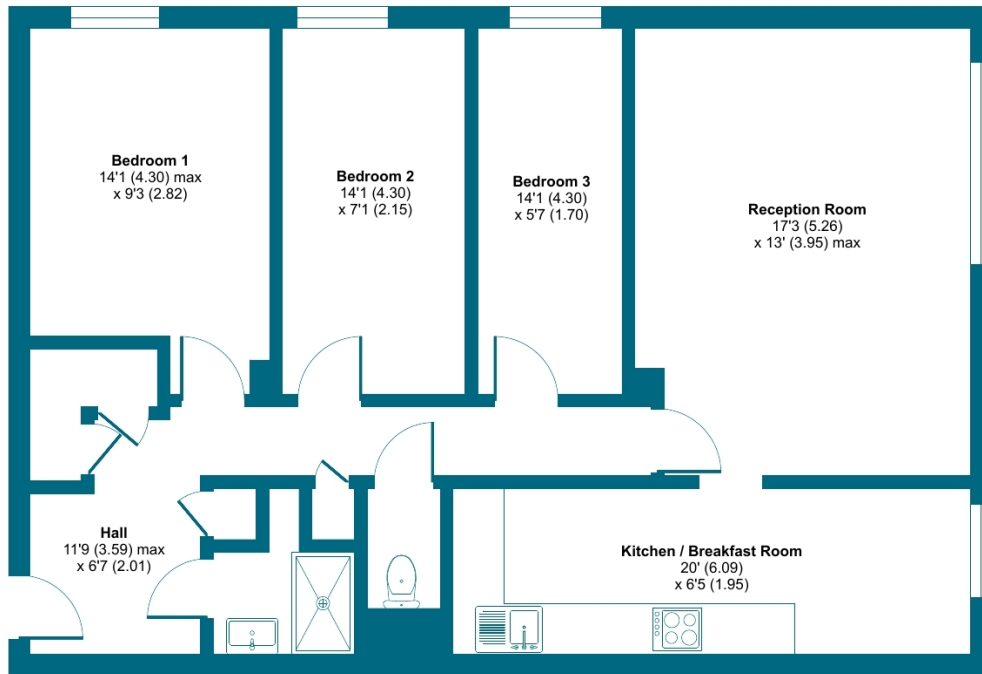

TENTH FLOOR



Floor plan produced in accordance with RICS Property Measurement 2nd Edition, Incorporating International Property Measurement Standards (IPMS2 Residential). © nitchecom 2025. Produced for Grafton Estate Agents. REF: 1360632

