

Peter Lane & Partners, for themselves as agents for the Vendors or Lessors of this property give notice that these particulars are produced in good faith and are to act purely as a guide to the property and therefore do not constitute any part of any contract. Peter Lane & Partners or any employee thereof do not have the authority to make or give any warranty, guarantee or representation whatsoever in relation to this property.

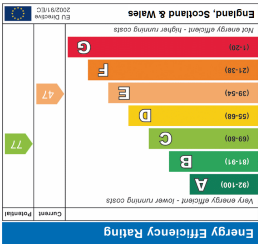

Huntingdon
60 High Street
Huntingdon
Tel : 01480 414800

St Neots
32 Market Square
St Neots
Tel : 01480 406400

Kimbolton
24 High Street
Kimbolton
Tel : 01480 860400

Mayfair Office
Cashel House
15 Thayer St, London
Tel : 0870 1127099

www.peterlane.co.uk Web office open all day every day
Kimbolton Office: 01480 860400



This plan is for layout guidance only. Not drawn to scale unless stated. Windows and door openings are approximate. Whilst every care is taken in the preparation of this plan, please check all dimensions, shapes and compass bearings before making any decisions reliant upon them. (ID1170134)

Housepix Ltd

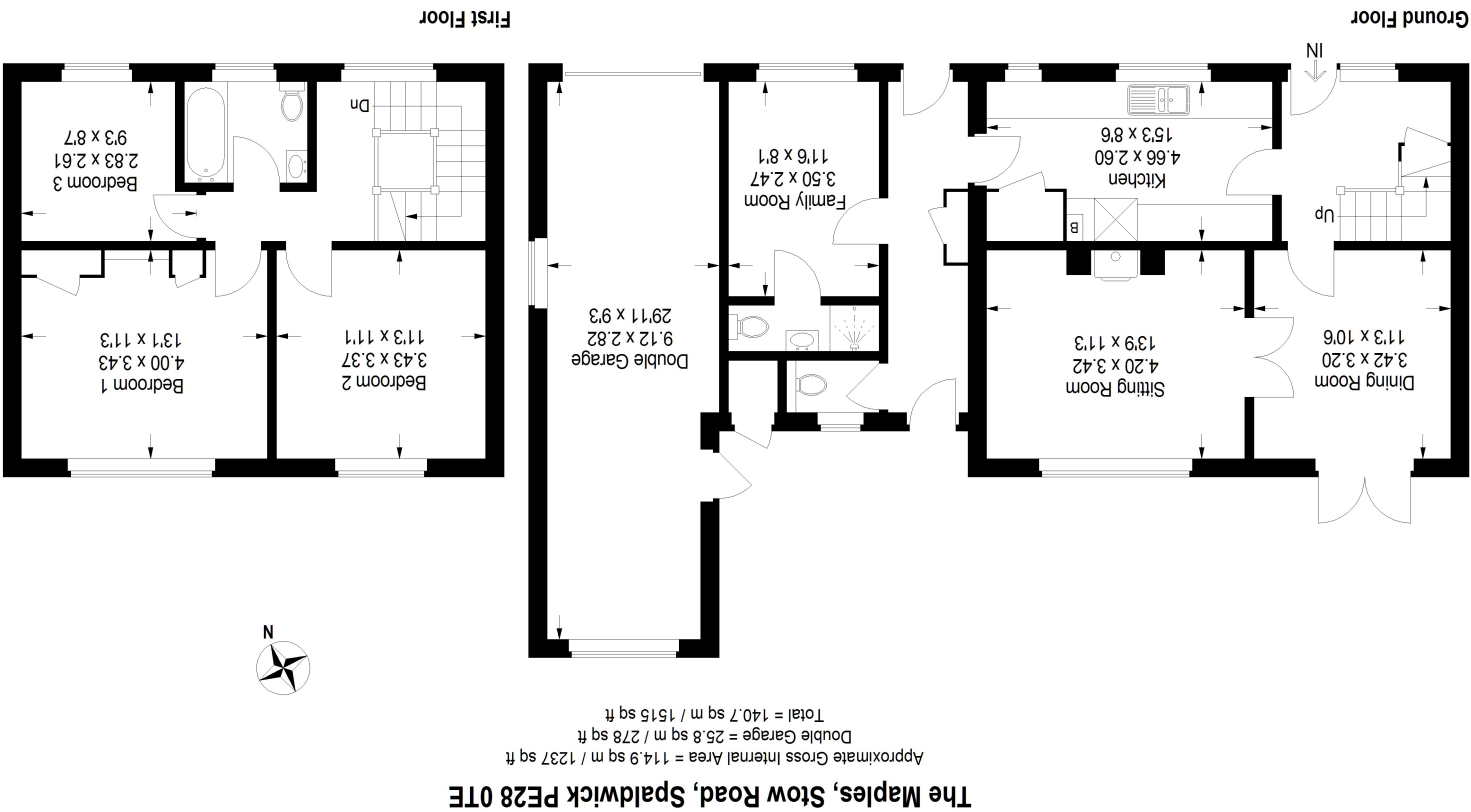

The Maples, Stow Road, Spaldwick PE28 0TE



37 The Maples • Stow Road • Spaldwick • Cambridgeshire • PE28 0TE

37 THE MAPLES • STOW ROAD •
SPALDWICK • CAMBRIDGESHIRE
• PE28 0TE

GUIDE PRICE £499,995

- Generous gardens with pleasant southerly aspect.
- Over 1,500 square feet including double 'tandem' garage with utility area
- Planning permission for extension, plans available upon request.
- Recently remodelled family room/bedroom 4 with en suite shower room.
- Sitting room with stone fireplace and wood burning stove.
- Separate dining/breakfast room with patio doors opening onto the garden.
- Spacious kitchen with comprehensive range of fitted cabinets.
- Recently refreshed family bathroom, ground floor guest cloakroom
- Attractive village location convenient for local school and facilities and access to major road and rail links.



Thoughtfully remodelled family home, ideal for families and homeworkers. Fine plot of approx. 0.22 acres with delightful southerly aspect. Over 1,500 square feet including double garage, with PP for large extension.

