



**24 Ravenstone Road, CAMBERLEY, Surrey GU15 1SN**

**OFFERS IN REGION OF £575,000**

Jigsaw Estates welcome you to this beautifully extended link detached home situated on the popular Heatherside development. Nestled in a sought-after location, this versatile residence offers a superb blend of spacious living and modern comforts, designed to meet the needs of families and professionals alike.

Step inside to discover a thoughtfully arranged layout featuring two large bedrooms and a refitted shower room on the first floor, providing ample space for rest and relaxation. To the ground floor, the property also boasts a separate study which can easily be utilised as a third bedroom, offering flexibility to accommodate your working-from-home lifestyle or growing family needs. The extended ground floor enhances the living experience with a separate, comfortable living room perfect for unwinding or entertaining guests.

The heart of this home is undoubtedly the exceptional kitchen/dining/living room – a truly large, all-encompassing space that is both stylish and practical. Whether you're preparing meals, enjoying family





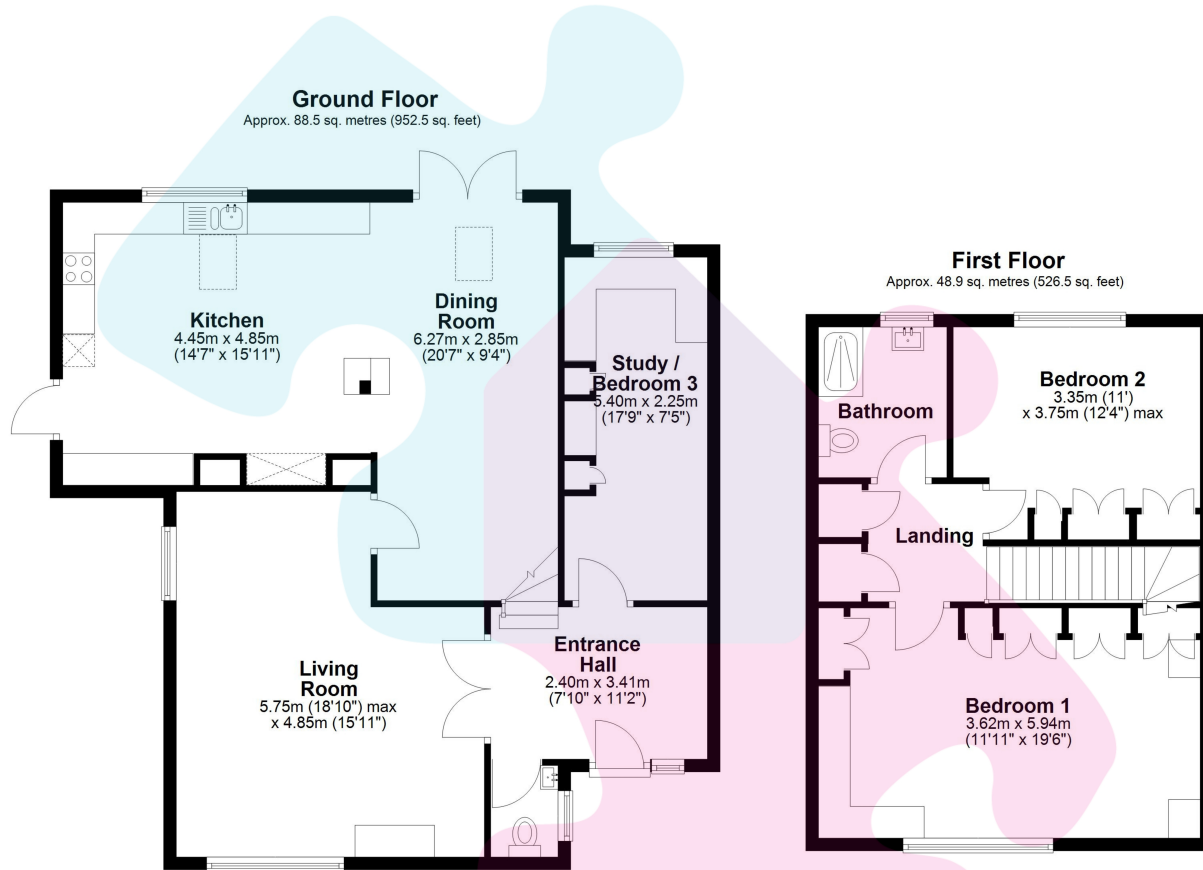

Floorplan is for illustration purposes only. All measurements are approximate and should be verified. Total Floor Area includes any garages, outhouses or ancillary buildings shown on the floorplan  
EPC and Floorplan produced by WWW.G-Whis.net  
Plan produced using PlanUp.

- TWO/THREE BEDROOMS
- EXTENDED LINK DETACHED HOME
- SEPARATE LIVING ROOM
- TWO LARGE DOUBLE BEDROOMS ON FIRST FLOOR
- WESTERLY FACING GARDEN AND DRIVEWAY PARKING
- STUNNING CONDITION
- LARGE ALL ENCOMPASSING KITCHEN/DINING/LIVING ROOM
- SEPARATE STUDY/BEDROOM 3
- REFITTED SHOWER ROOM & SEPARATE CLOAKROOM

Energy Efficiency Rating		Current	Potential
Very energy efficient - lower running costs			
(92+)	<b>A</b>		
(81-91)	<b>B</b>		
(69-80)	<b>C</b>	73	76
(55-68)	<b>D</b>		
(39-54)	<b>E</b>		
(21-38)	<b>F</b>		
(1-20)	<b>G</b>		
Not energy efficient - higher running costs			
England, Scotland & Wales		EU Directive 2002/91/EC	

