



DERBYSHIRE
PROPERTIES
— SALES & LETTINGS —



Shaw Lane, Milford, BELPER, Derbyshire DE56 0RE
£475,000 - Freehold (to be confirmed)



PROPERTY DESCRIPTION

A charming stone-built converted former chapel offering a magnificent open-plan lounge, dining, study, and kitchen area.

Situated within a highly sought-after conservation area between Duffield and Belper, this property combines period character with convenient location. Believed to have been constructed around 1825, this unique brick and stone-built period home offers style and character rarely found in this desirable conservation setting.

This link-detached property is only partially attached to one wall, providing a greater sense of privacy and space. We strongly recommend a viewing to fully appreciate the accommodation on offer. Constructed of brick and stone beneath a tiled roof, the main elevation presents an attractive double-fronted facade, complemented by sealed unit character sash-style double glazed windows, stone lintels and sills.

The property is set back behind a foregarden featuring flowerbeds and a retaining wall. Inside, you'll find light, spacious, and characterful living accommodation with gas central heating throughout. An internal inspection is essential to fully appreciate all this charming home has to offer

POINTS OF INTEREST

- Located in Milford's conservation area
- Countryside Views Of The Derwent Valley
- Magnificent Lounge/Dining/Study/Kitchen
- Four Bedrooms, En Suite, Bathroom
- Useful Road Links
- Charm & Character Throughout

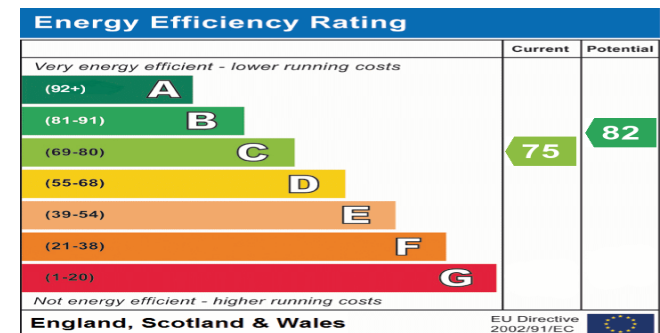

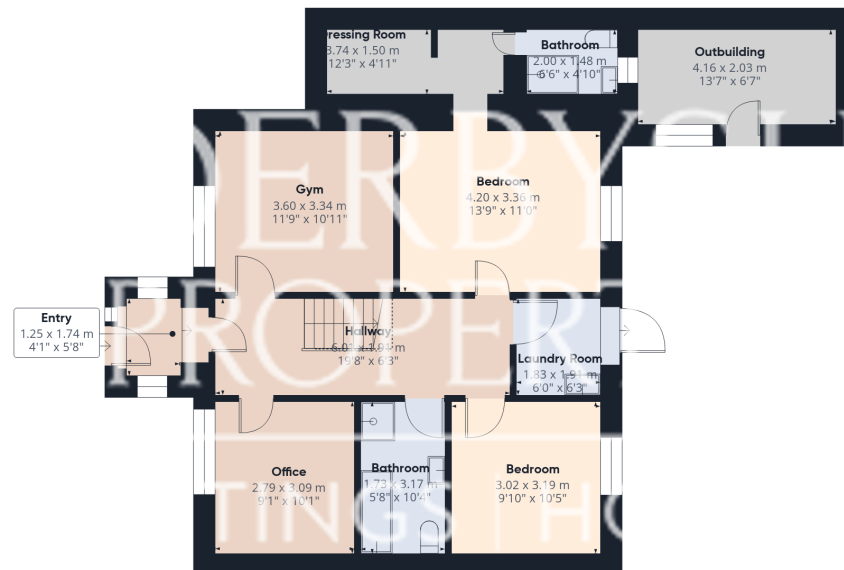

Ground Floor



Floor 1

Approximate total area⁽¹⁾

159 m²

1711 ft²

Reduced headroom

1.5 m²

16 ft²

(1) Excluding balconies and terraces

Reduced headroom

..... Below 1.5 m/5 ft

Calculations reference the RICS IPMS 3C standard. Measurements are approximate and not to scale. This floor plan is intended for illustration only.

GIRAFFE360