



Knareborough Place, London, SW5 0TN

Cow & Co
LONDON



A large two double bedroom, two bathroom apartment offering excellent fixtures and fittings along with bright and spacious accommodation throughout.

Knarborough Place is located just moments from both Earls Court and South Kensington for access to all the shops, boutiques, restaurants and cafes close by as well as transport links on the Piccadilly and District Lines.



- Two double bedroom apartment situated in a popular prime London location
- Fully fitted kitchen open plan to a large bright and spacious living area
- Security entry phone system
- Two well proportioned bedrooms
- Two bathrooms with one being an ensuite of the master bedroom
- A very good sized and well kept apartment
- Viewing by appointment only

Knaresborough Place, London, SW5

Approximate Area = 668 sq ft / 62 sq m

For identification only - Not to scale

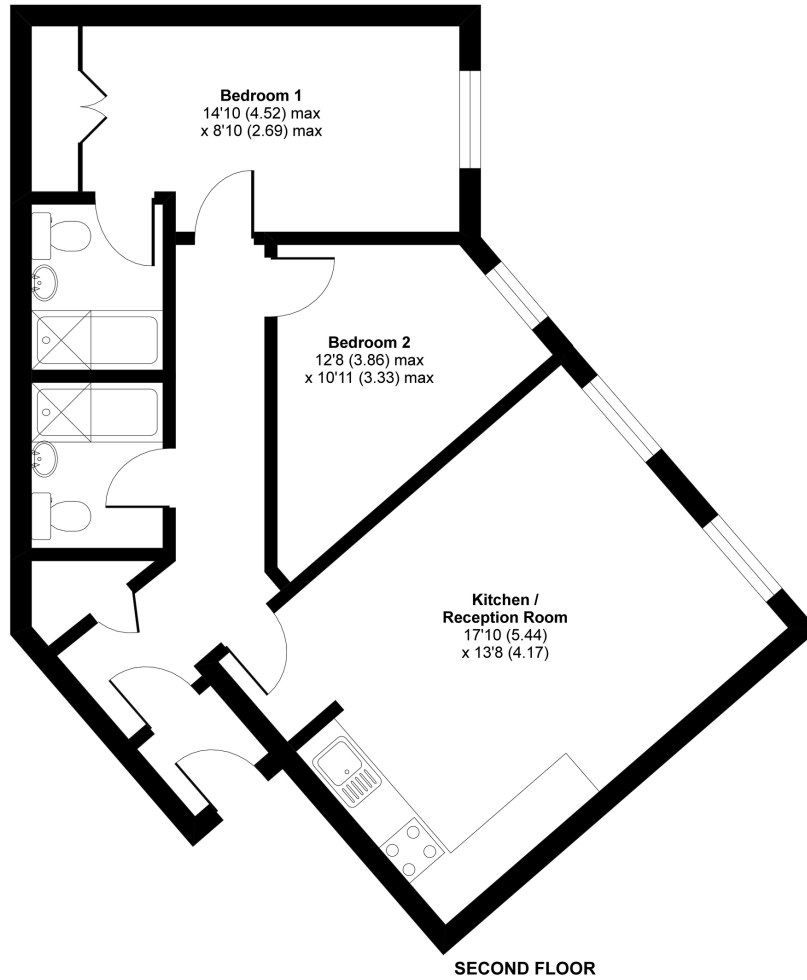

Floor plan produced in accordance with RICS Property Measurement Standards incorporating International Property Measurement Standards (IPMS2 Residential). © nichecom 2021. Produced for Cow & Co Properties Ltd. REF: 685226

Tel: 0208 065 0010
Email: thehub@cowandco-london.com
Web: cowandco-london.com

Agents note: All measurements are approximate and whilst every attempt has been made to ensure accuracy they are for general guidance only and must not be relied on. The fixture and fittings referred to have not been tested and therefore no guarantee can be given that they are in working order. Internal photographs are reproduced for general information and it must not be inferred that any item shown is included with the property.

Cow & Co
LONDON