



Kingswood Road, London, W4 5ET

Cow & Co
LONDON



GUIDE PRICE OF £550,000-650,000. A lovely bright and spacious two double bedroom garden flat situated in a popular residential road in Chiswick. The property offers contemporary style fixtures and fittings, along with a sleek open plan fitted kitchen opening out onto a large living area, with ample space to dine and entertain. The apartment offers an abundance of natural light throughout, coupled with direct access onto a lovely sunny garden.

Kingswood Road is part of a popular enclave of residential period architecture close to Chiswick Park Underground station (District Line). It is also within close distance of South Acton Overground station (Richmond 12 minutes) and close to the many amenities of Chiswick High Road. This location offers easy access to central London via the A4, and via the M4 for Heathrow Airport and the west of England.



- Well presented two double ground bedroom ground floor garden flat
- Contemporary fitted kitchen with integrated appliances
- Two well proportioned bedrooms
- Direct access onto a lovely sunny terrace
- Additional courtyard garden
- Own private entrance
- Bright and spacious throughout with ample space to dine and entertain
- Close proximity to local transport links and amenities

Kingswood Road, London, W4

Approximate Area = 700 sq ft / 65 sq m

For identification only - Not to scale

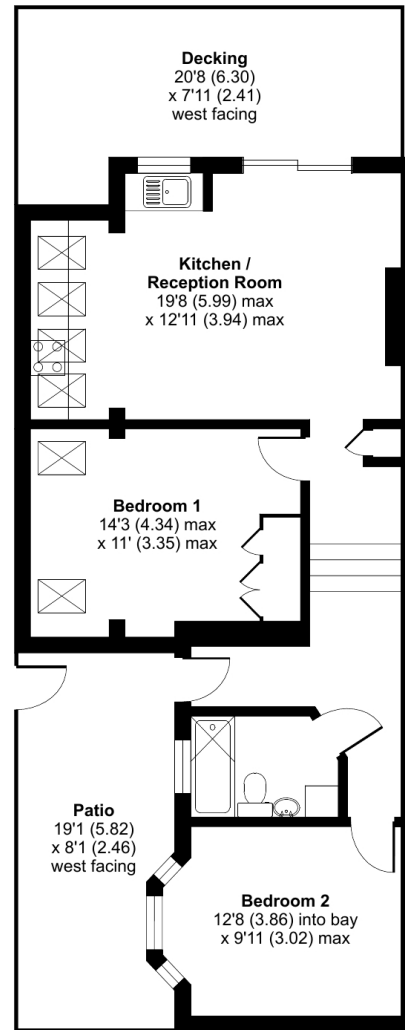

GROUND FLOOR



Floor plan produced in accordance with RICS Property Measurement Standards incorporating International Property Measurement Standards (IPMS2 Residential). © nchecon 2022. Produced for Cow & Co Properties Ltd. REF: 828990

Tel: 0208 065 0010
Email: thehub@cowandco-london.com
Web: cowandco-london.com

Agents note: All measurements are approximate and whilst every attempt has been made to ensure accuracy they are for general guidance only and must not be relied on. The fixture and fittings referred to have not been tested and therefore no guarantee can be given that they are in working order. Internal photographs are reproduced for general information and it must not be inferred that any item shown is included with the property.

Cow & Co
LONDON