

## Lyttelton Court, Lyttelton Road, London, N2

# £400,000

Set within a prestigious mansion block in the highly sought-after Hampstead Garden Suburb, this south-facing two-bedroom, purpose-built apartment is located on the first floor and benefits from two private balconies. The property offers spacious, light-filled accommodation, including a bright reception room with lovingly restored parquet flooring, a kitchen/breakfast room, two comfortable bedrooms, and a modern bathroom/WC. Additional features include access to beautifully maintained communal gardens, resident parking, and the convenience of a day porter. With local shops, bus routes, and East Finchley tube (Zone 3) within a mile, and 1.1 miles to Golders Green, this apartment offers both luxury and convenience in a tranquil, highly desirable location.



- Two Private Balconies
- 112 Years Lease
- South Facing Balcony
- Restored Parquet Flooring
- Gas Central Heating
- Resident Parking (first come basis)















Approx Gross Internal Area  
60 sq m / 645 sq ft

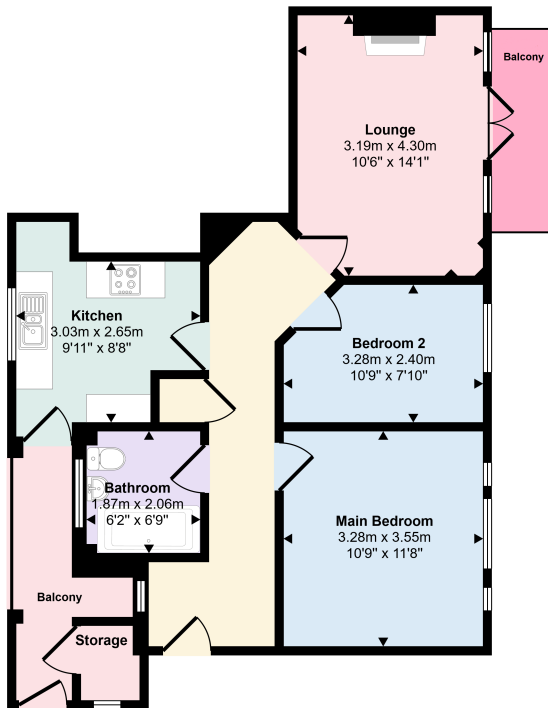

Floorplan

This floorplan is only for illustrative purposes and is not to scale. Measurements of rooms, doors, windows, and any items are approximate and no responsibility is taken for any error, omission or mis-statement. Icons of items such as bathroom suites are representations only and may not look like the real items. Made with Made Snappy 360.

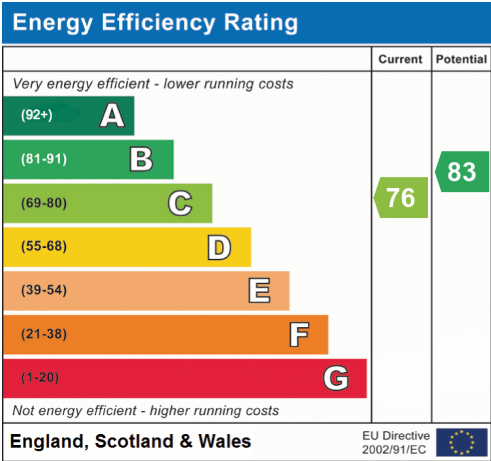

When you are considering a property we recommend that you instruct a surveyor to ensure the property is in sound structural order and that equipment, fitting, services, etc are in working order and/or fit for their purpose and a solicitor to verify tenure and title of the property. We can give no assurances in this regard nor can we verify accuracy of measurements or distance.

**Jeremy Leaf & Co.,** for themselves and for their client, whose agent they are, give notice that:

1. Under the terms of the Anti Money Laundering Act 2007, intending purchasers will be asked to produce identification documentation at a later stage and we would ask for your co-operation in order that there will be no delay in agreeing the sale.
2. These particulars do not constitute any part of an offer or a contract.
3. All statements contained in these particulars are made without responsibility on the part of Jeremy Leaf & Co or their client.
4. None of the statements contained in these particulars is to be relied upon as a statement, warranty or representation of fact.
5. Please note we have not tested the services or any of the equipment or appliances in this property, accordingly we strongly advise prospective buyers to commission their own survey or service reports before finalising their offer to purchase.
6. Any intending purchaser or tenant must satisfy himself by inspection, or otherwise as to the correctness of each of the statements contained in these particulars.
7. No person in the employment of Jeremy Leaf & Co has any authority to make any representation or warranty whatsoever in relation to this property.
8. Unless otherwise stated, all prices and rents are quoted exclusive of Value Added Tax (VAT) . Any intending purchasers or lessees must satisfu themselves independently as to the incidents of VAT in respect of any transaction.
9. This document is not intended for distribution and may not be reproduced or further distributed or published for any purpose. In particular, any tenants detailed in this property should not be approached without prior written permission.