

Rent
Me



The Clock Tower, Elphins Drive, Warrington.

£850 pcm

Two Double Bedrooms | Family Bathroom & En-Suite Shower Room | Modern Kitchen with Appliances | Impressive Balcony | Open Plan Living | Sought After & Desirable Location |



Situated within the Grade II listed Clock Tower development, the FIRST FLOOR APARTMENT couple both CHARM and CHARACTER of exposed brickwork with the benefit and style of modern day living. The accommodation comprises hallway, OPEN PLAN living room/ diner and kitchen with brand new appliances. There property benefits from two doubles bedrooms, en-suite shower room to the master and a family bathroom. The property also benefits from a large balcony area, great for entertaining. Conveniently located for both Warrington Town Centre and Stockton Heath with **ALLOCATED PARKING**. Offered to let on an unfurnished basis. Viewings are essential to appreciate the standard of this unique property.

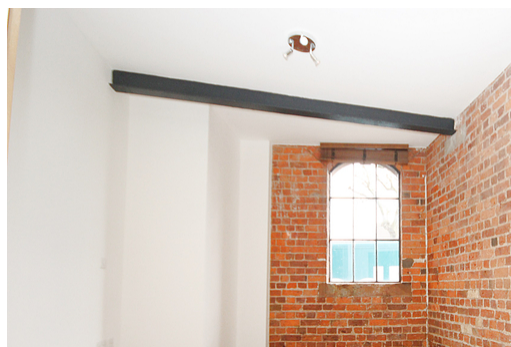

*Contact your local office
to arrange a viewing:*

Padgate: 01925 479334
Great Sankey: 01925 454300
Winwick: 01925 232146
Stockton Heath: 01925 453400
St.Helens: 01744 754120
Wigan: 01942 498862
Culcheth: 01925 764744
Ashton-In-Makerfield: 01942 364446
Newton-Le-Willows: 01925 907770
Commercial Office: 01925 907709
Lettings Head Office: 01925 873533
Financial Services: 01925 221234

Viewing Arrangements

Viewing is strictly by appointment only through Ashtons Estate Agency.

Disclaimer Property Details

These particulars, whilst being believed to be accurate are set out as a general outline only for guidance and do not constitute any part of an offer or contract. Intending purchasers should not rely on them as statements of representation of fact, but must satisfy themselves by inspection or otherwise as to their accuracy. We have not carried out a detailed survey nor tested the services, appliances and specific furnishings. The measurements given are approximate. No person in this firm's employment has the authority to make or give any representation or warranty in respect of the property.

All details, photographs and floorplans are the copyright of Ashtons Estate Agency.



How much you can borrow?
 Speak to a mortgage expert in your local office.

Ashtons Financial Services

Ashtons.net **rightmove**

PrimeLocation.com **Zoopla.co.uk**

Ashtons