



Bayleaf Avenue, Swindon
Wiltshire, Offers Over £190,000

Waymark

Bayleaf Avenue, Swindon SN2 2RU

Wiltshire
Freehold

Mid Terrace Property | Two Double Bedrooms | Open Plan Sitting/Dining Room | Rear Garden | Off-Street Parking | Chain Free | Popular & Established Location

Description

A fantastic opportunity for first time buyers and investors to purchase this mid-terrace two double bedroom which is offered to the market chain free. The property is situated in a popular and established location in Haydon Wick, North Swindon and is only a short walk from local amenities, schooling as well as Moulden Hill Country Park.

The property comprises; Entrance hall, kitchen, open plan sitting/dining room with patio doors out to your garden, landing, family bathroom and two double bedrooms.

Outside there is off-street parking for one car as well as a private rear garden which is easy to maintain. The garden also benefits from a large storage shed.

The property is freehold and is connected to mains gas, electricity, water and drainage. There is gas central heating and upvc double glazing throughout.

Location

This property boast great links to Swindon Town Centre, West Swindon and ORBITAL RETAIL PARK, and is just a short walk from Moulden Hill Country Park and further amenities and local schooling.

Viewing Information

By appointment only please.

Local Authority

Swindon Borough District Council.

Tax Band: B



Energy Efficiency Rating		Current	Potential
Very energy efficient - lower running costs			
(92-100)	A		
(81-91)	B		88
(69-80)	C		
(55-68)	D	66	
(39-54)	E		
(21-38)	F		
(1-20)	G		
Not energy efficient - higher running costs			
England, Scotland & Wales			
EU Directive 2002/91/EC			



Waymark
Faringdon Office

T: 01367 820070
E: faringdon@waymarkproperty.co.uk

Ground Floor

Approx. 29.1 sq. metres (313.6 sq. feet)

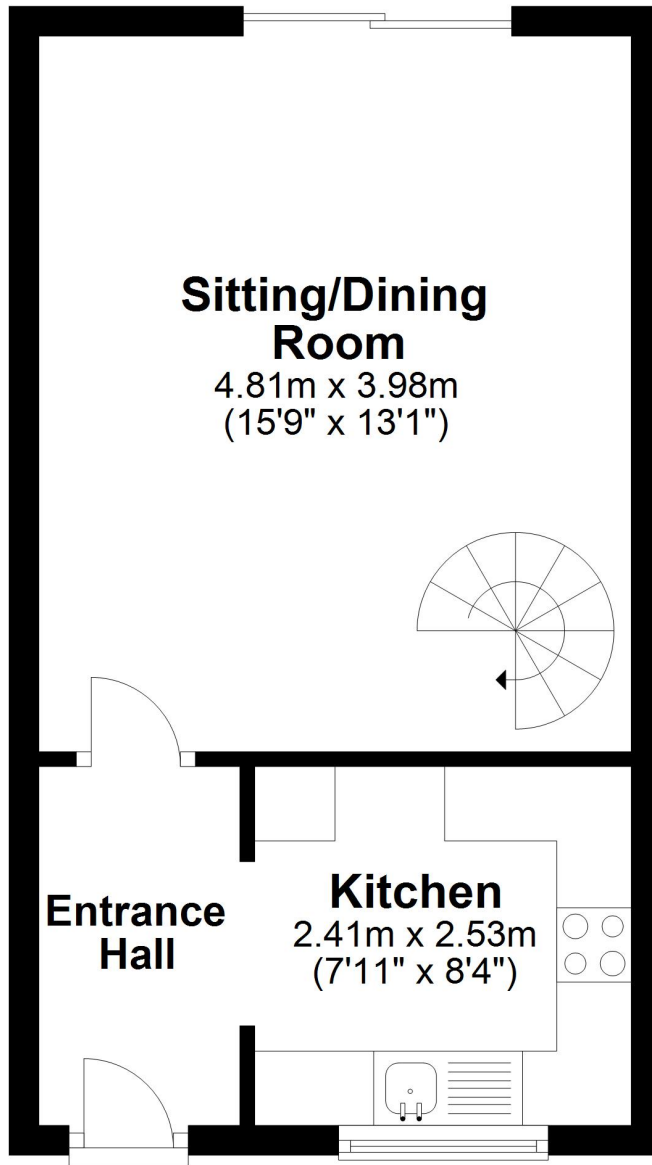

First Floor

Approx. 29.1 sq. metres (313.6 sq. feet)

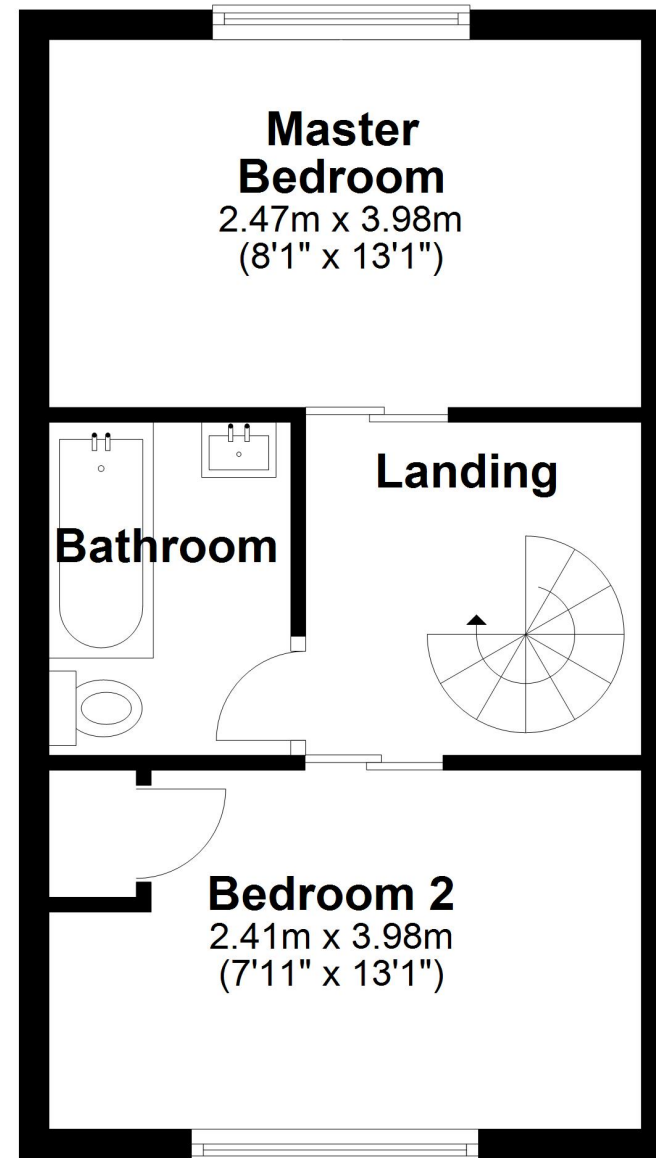

Total area: approx. 58.3 sq. metres (627.2 sq. feet)

Important Notice: These Particulars have been prepared for prospective purchasers for guidance only. They do not form part of an offer or contract. Whilst some descriptions are obviously subjective and information is given in good faith, they should not be relied upon as statements or representative of fact.

