

FOR SALE



Dorchester Way, Harrow, Greater London HA3

This three bedroom semi-detached property is situated on a pleasant road located on the prestigious 'Lindsay Drive' estate in Kenton and within close proximity to Kingsbury Station (Jubilee Line).

This home which stands out from its neighbouring properties benefits from a spacious through lounge for all the family to enjoy, a fitted kitchen with more than enough storage space, three well-proportioned bedrooms for those looking for extra living space and growing families, a contemporary fitted bathroom and a lovely family garden which blossoms into life during the summer months with a well looked after lawn with trees. In addition, you have a garage via share drive.

This property is sure to generate a huge amount of interest so call Mischa & Co without delay.

£599,950 Freehold

Floorplan

GROUND FLOOR
496 sq.ft. (46.1 sq.m.) approx.

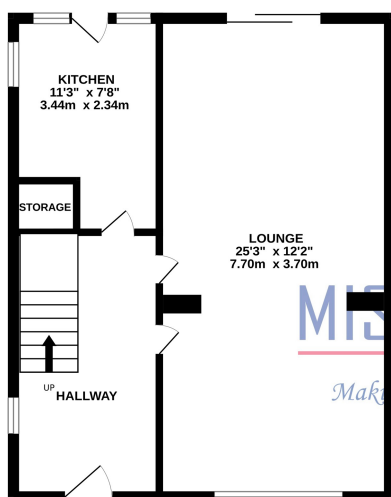

1ST FLOOR
488 sq.ft. (45.3 sq.m.) approx.

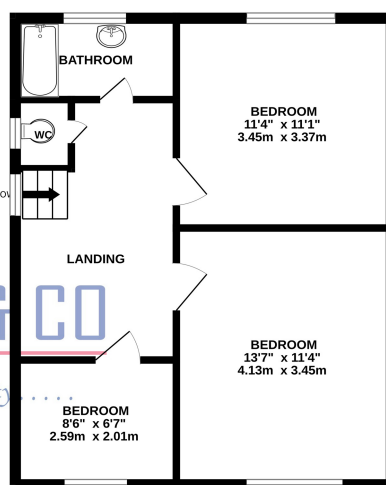

TOTAL FLOOR AREA: 984 sq.ft. (91.4 sq.m.) approx.

Whilst every attempt has been made to ensure the accuracy of the floorplan contained here, measurements of doors, windows, rooms and any other items are approximate and no responsibility is taken for any error, omission or mis-statement. This plan is for illustrative purposes only and should be used as such by any prospective purchaser. The services, systems and appliances shown have not been tested and no guarantee as to their operability or efficiency can be given.
Made with Metropix ©2025

NB: Please note that all fittings, kitchen appliances and heating systems have not been tested by Mishca & Co Sales & Lettings. Whilst we endeavour to make our sales details accurate and reliable. Room sizes should not be relied upon for carpets and furnishings. If there is any point, which is of particular important to you, please contact our office and we will be pleased to verify any information for you. Do so particularly if contemplating travelling some distance to view this property.