

FOR SALE

£180,000

Rosebrae Court, Pensby Road, Heswall, Wirral. CH60 7RP



A STYLISH MODERN APARTMENT NEAR HESWALL CENTRE! Situated just a stone's throw away from the centre of Heswall town this ground floor apartment is the perfect blend of modern living and practical access to local amenities. Excellent local shops, transport links, bars and restaurants all ensure that this home will be perfect for working professionals, early downsizers or first time buyers alike. Accessed via a secure communal entrance and reception area, this apartment offers plenty of scope with accommodation comprising a hallway with storage cupboards, a spacious lounge diner, well fitted breakfast/kitchen, two good sized bedrooms, a family bathroom and master featuring an en-suite shower. Externally there is visitor parking and allocated parking and beautiful communal gardens surrounding. Offered with no onward chain we expect this property will be extremely popular and encourage an early viewing so as not to miss out!!





Apt 10, Rosebrae Crt

Ground Floor

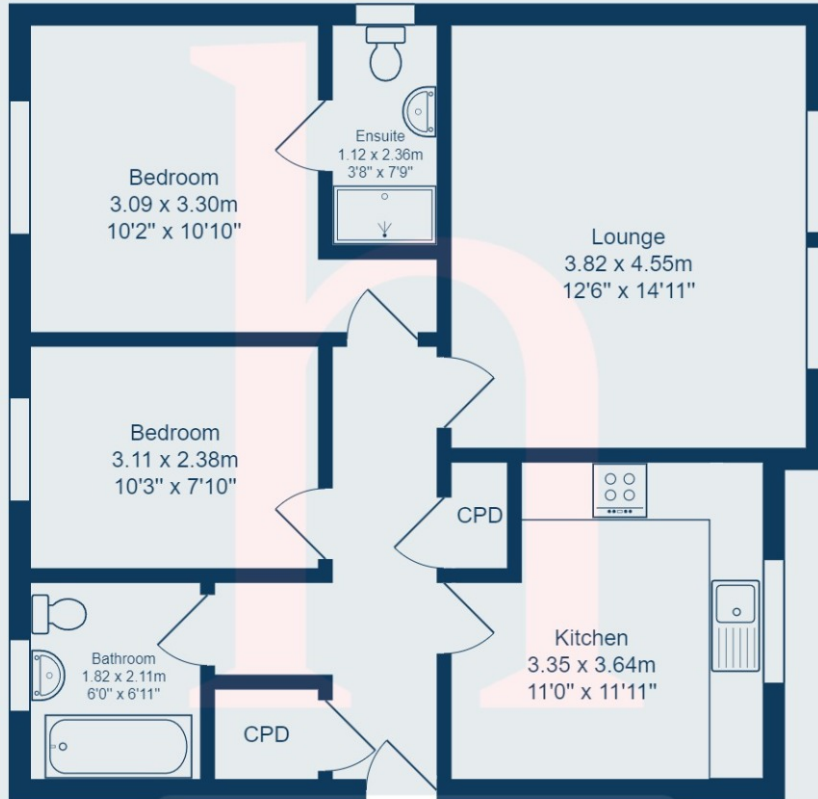

Total Area: 66.1 m² ... 712 ft²

All measurements are approximate and for display purposes only.