



**Dorman Gardens
Middlesbrough
North Yorkshire
TS5 5DS**

Offers in Excess of £55,000

bettermove

Dorman Gardens

Middlesbrough

Bettermove are proud to present this 1 bedroom flat in Middlesbrough.

The property is currently tenanted and it will be sold with tenants in situ for immediate investment. Rental yields can be obtained through Bettermove.

The property benefits from double glazing, electric heating throughout and has off street parking available.

The council tax band is B.

This is a leasehold property with 104 years remaining on the lease; the ground rent and service charge is £1,400 per annum.

The interior of this beautifully presented property comprises a spacious living room, fitted kitchen, bedroom and bathroom.

Located in the popular town of Middlesbrough, the property is close to a range of amenities, including shops, supermarkets, restaurants and pubs. Excellent transport connections can be found from the A19 and Linthorpe Village bus and coach station.

This exciting opportunity should not be missed! All enquiries can be made through Bettermove on 0330 004 0050.



80 Dorman Gardens

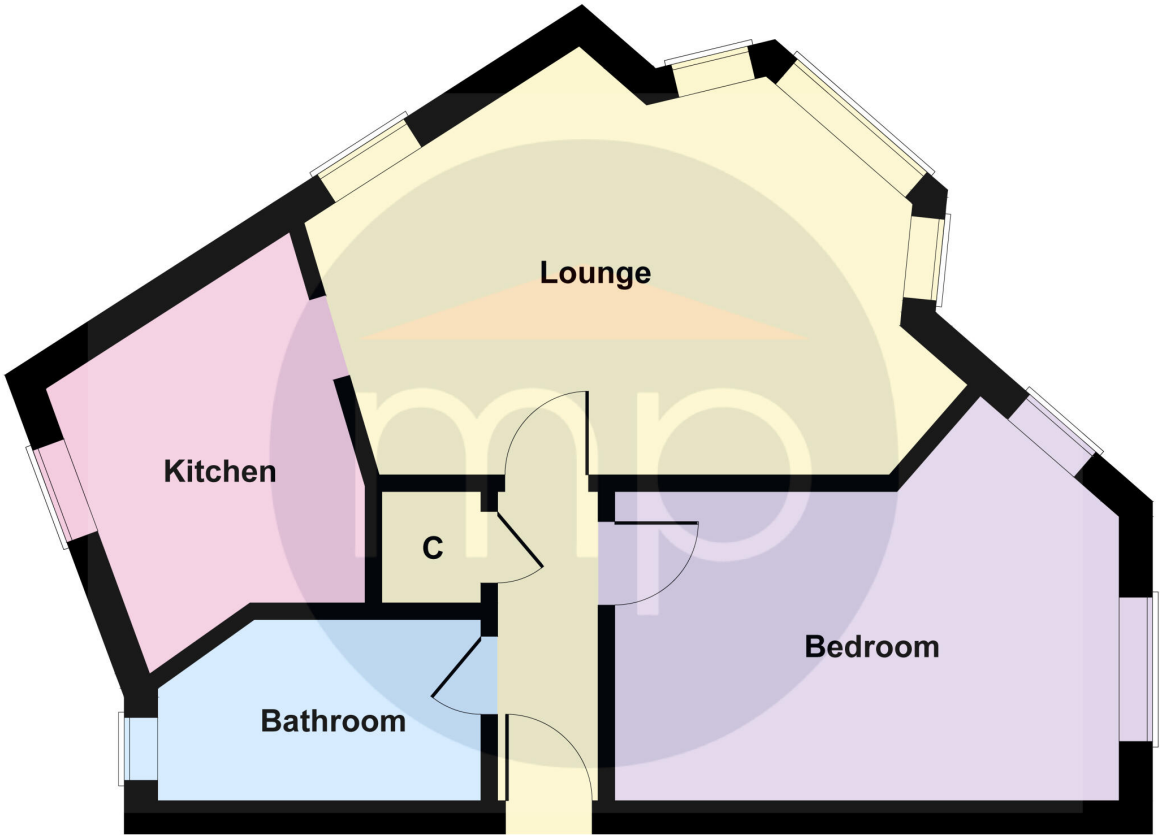

Not to Scale. Produced by The Plan Portal 2024
For Illustrative Purposes Only.

Energy Efficiency Rating		
	Current	Potential
Very energy efficient - lower running costs		
(92+) A		
(81-91) B		
(69-80) C	74	81
(55-68) D		
(39-54) E		
(21-38) F		
(1-20) G		
Not energy efficient - higher running costs		
England, Scotland & Wales	EU Directive 2002/91/EC	



20-22 Bridge End, Leeds, LS1 4DJ
t: 0330 004 0050 e: hello@bettermove.co.uk
www.bettermove.co.uk