



11 Raleigh Way, FRIMLEY, Surrey GU16 8RH

PRICE £325,000 Leasehold

Jigsaw Estates are pleased to offer this spacious first floor apartment, situated down a private drive on the exclusive Raleigh Way development of the Camberley/Frimley borders. In terms of accommodation there are two front aspect double bedrooms, one being the principal bedroom with a refitted en-suite shower room. The main bathroom has also been refitted to the same standard as the en-suite. Opening the double casement doors takes you into the spacious living/dining room which measures approximately 20ft x 14ft and has a Juliette balcony. The kitchen has also been refitted with modern, high gloss units.

There is communal parking to the front and this particular building has had the soffits and fascias upgraded to UPVC and the windows to the apartment are all UPVC.

Lease Length - 999 years from 2015 so 989 years remaining

Service Charge = £1761.24 pa



Rayleigh Way

Approximate Gross Internal Area = 76.3 sq m / 822 sq ft

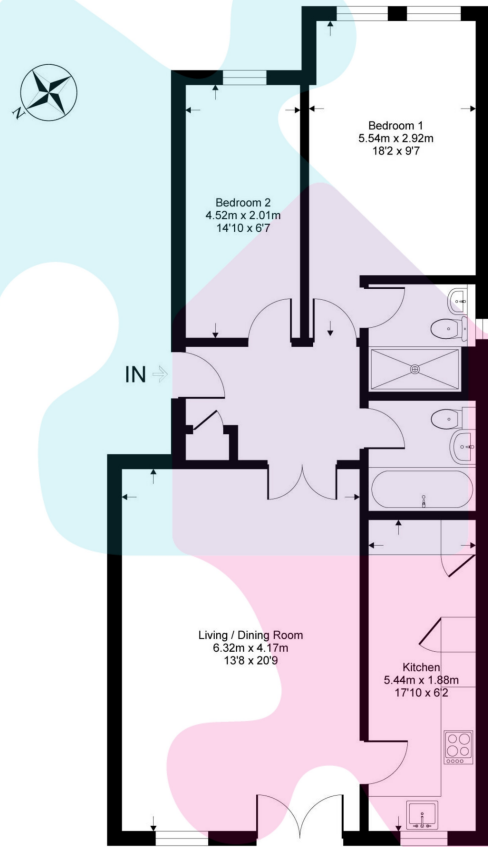

First Floor = 76.3 sqm / 822 sqft

Whilst every attempt has been made to ensure the accuracy of the floor plan contained here, measurements of doors, windows, rooms and any other items are approximate and no responsibility is taken for any error, omission or mis-statement. This plan is for illustrative purposes only and should be used as such by any prospective purchaser.

- LUXURY APARTMENT
- TWO DOUBLE BEDROOMS
- REFITTED EN-SUITE TO PRINCIPAL BEDROOM
- COMMUNAL PARKING
- CLOSE PROXIMITY TO SCHOOLS

- APPROX 20FT X 14FT LIVING/DINING ROOM
- REFITTED KITCHEN APPROX 17FT LONG
- REFITTED MAIN BATHROOM
- WALKING DISTANCE TO FRIMLEY PARK HOSPITAL
- 999 YEAR LEASE FROM 2015, NO GROUND RENT, £1761 PER ANNUM SERVICE CHARGE

Energy Efficiency Rating		
	Current	Potential
Very energy efficient - lower running costs		
(92+) A		
(81-91) B		
(69-80) C		79
(55-68) D	55	
(39-54) E		
(21-38) F		
(1-20) G		
Not energy efficient - higher running costs		
England, Scotland & Wales		EU Directive 2002/91/EC

