



9 Whittle Court,
Knowlhill, Milton Keynes, MK5 8FT

Tel: 01908 231 551
mail@elevationstateagents.com



**Flat 2 55 Aylesbury street, Fenny Stratford,
Milton Keynes, mk2 2bh**

£235,000

- Two Double Bedrooms
- Sought After Area
- Open Plan Living
- Balcony Off The Master
- Close to the Railway Station
- EPC-C
- Current rental value £1200pcm
- EPC Rating





LARGE Stylish first floor apartment with a balcony.

Brilliant investment opportunity

The open plan living space offers integrated oven with an induction hob and space for freestanding appliances. There are spotlights and a Juliet balcony off the lounge allowing for lots of natural light. The two double bedrooms are of great size, finally the family bathroom comprises of a bath with a glass screen door with an overhead shower, a vanity basin and a w/c.

In the popular area of Fenny Stratford there is the local Shopping facilities to include Bletchley Town and Fenny High Street with a range of restaurants and shops. It is within proximity to Bletchley railway station. It is also within great school catchments including first and secondary school.

Annual Service Charge: £1,010

Annual Ground Rent: £295

Lease Remaining: 999 years Council Tax Band: B

Disclaimer

Whilst we have endeavoured to prepare our sales particulars accurately none of the services, appliances or equipment have been tested. A buyer should satisfy themselves on such matters prior to purchase. Any measurements or distances mentioned in these particulars are for guide reference only. If such particulars are fundamental to a purchase, buyers should rely on their own enquiries. All enquiries should be directed to Elevation Estate Agents in the first instance.

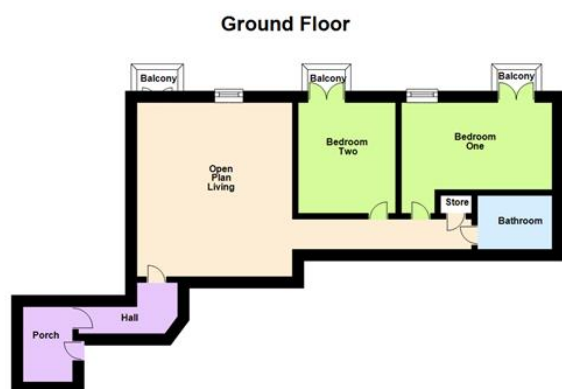

Floor plans are for layout purposes only. Measurements are approximate and subject to inaccuracies
Plan produced using PlanUp.

See our full selection of properties online at www.elevationestateagents.com