



- Modern Two Bedroom Top Floor Apartment
- Ideal First Home
- Colchester City Centre Location
- Two Double Bedrooms
- Focal Open Plan Living/Kitchen/Dining Area
- En-Suite Shower Room
- Bathroom
- Allocated Parking

11 Saw Mill Road, Colchester, Essex. CO1 2ZL.

Saw Mill Road, Central Colchester, CO1 - Modern Two Bedroom Top Floor Apartment **Guide Price £150,000 - £160,000** Michaels Property Consultants are pleased to present to the market this impressive two double bedroom top-floor apartment, ideally located on Saw Mill Road in a prime central Colchester position. The property is perfectly situated within easy reach of Colchester City Centre, Colchester Town Station with direct links to London Liverpool Street, a wide range of shops, cafés, restaurants and amenities, as well as the ever-popular Castle Park, all within comfortable walking distance.



Property Details.

Second Floor (Top Floor) Apartment

Entrance Hall

Kitchen/Dining/Living Room



13' 4" x 12' 11" (4.06m x 3.94m)

Bedroom One



12' 7" x 9' 5" (3.84m x 2.87m)

En-Suite



Bedroom Two



12' 11" x 9' 5" (3.94m x 2.87m)

Property Details.

Family Bathroom



6' 2" x 5' 9" (1.88m x 1.75m)

Property Details.

Floorplans

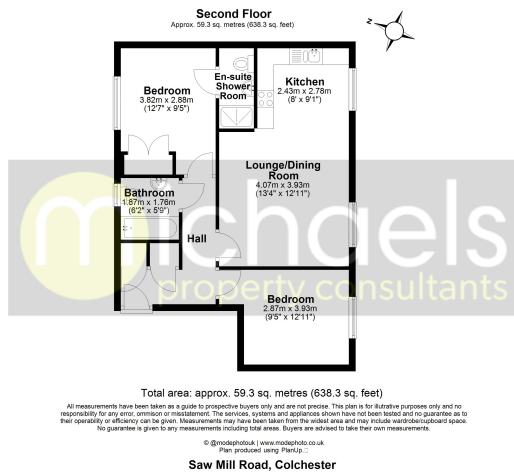

Location

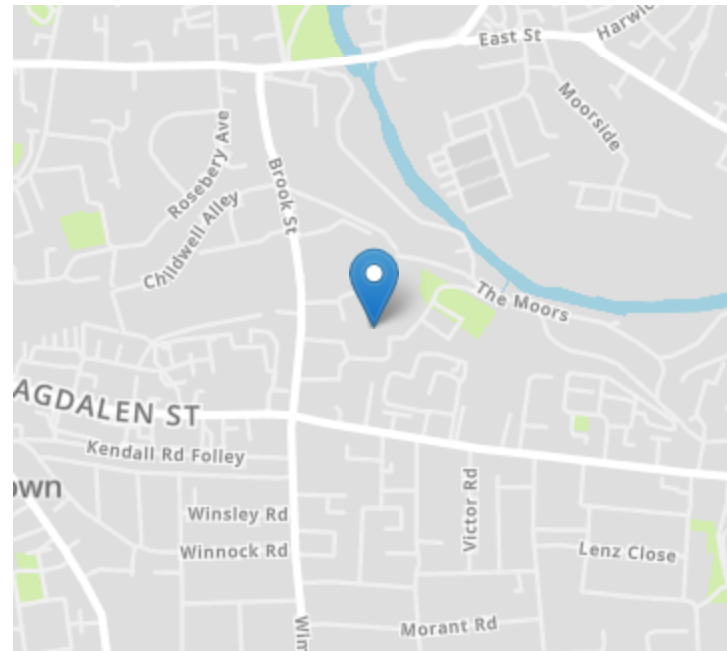

Energy Ratings

We have not carried out a structural survey and the services, appliances and specific fittings have not been tested. All photographs, measurements, floor plans and distances referred to are given as a guide only and should not be relied upon for the purchase of carpets or any other fixtures or fittings. Gardens, roof terraces, balconies and communal gardens as well as tenure and lease details cannot have their accuracy guaranteed for intending purchasers. Lease details, service ground rent (where applicable) are given as a guide only and should be checked and confirmed by your solicitor prior to exchange of contracts.