



# Taylor Avenue

May Bank

Newcastle Under Lyme, ST5 9NE



## OneAgency

01782 970222

[hello@oneagencygroup.co.uk](mailto:hello@oneagencygroup.co.uk)





# Offers In Excess Of £155,000

Well presented, two bedroom semi detached house, with stain glass featured above the bedroom and bathroom door frames. The property is situated in May Bank close to local Schools, shops and amenities with easy access to the A34 and within 2 miles from Newcastle town centre. Viewing of this property is recommended.





#### ENTRANCE HALLWAY

Door to the side, stairs to the first floor, tiled floor.

#### G.F WC

0.88m x 1.34m (2' 11" x 4' 5")

Window to the side elevation, tiled floor, w.c and wash hand basin.

#### LOUNGE

3.31m x 4.66m (Max) (10' 10" x 15' 3"(Max))

Window to the side elevation and bay window to the front, wood flooring, radiator, feature fire surround with gas fire.

#### KITCHEN DINER

4.28 m x 3.27m (narrowing to 2.39) (14' 1" x 10' 9")

Fitted with a range of wall base and drawer units, tiled floor, radiator, windows to the rear elevation and door leading to rear garden. Combi Boiler.

There is a storage cupboard leading off the kitchen.

#### LANDING

Carpeted.

#### BEDROOM ONE

3.32m x 4.64m (max) (10' 11" x 15' 3"(max))

Spacious double room with wood flooring, bay window to the front elevation and radiator.

#### BEDROOM TWO

2.39m x 4.68m (7' 10" x 15' 4")

Window to the rear elevation, carpeted, radiator.

#### BATHROOM

2.06m x 1.81m (6' 9" x 5' 11")

Window to the side elevation, tiled floor, fitted with a white suite comprising, bath, w.c and wash hand basin. Ladder style towel radiator. Loft Hatch.

#### EXTERIOR

To the front of the property is a large driveway providing ample parking.

To the rear of the property is an enclosed garden with a lawn and patio area.

GROUND FLOOR  
355 sq. ft. (33.0 sq. m.) approx.

1ST FLOOR  
355 sq. ft. (33.0 sq. m.) approx.

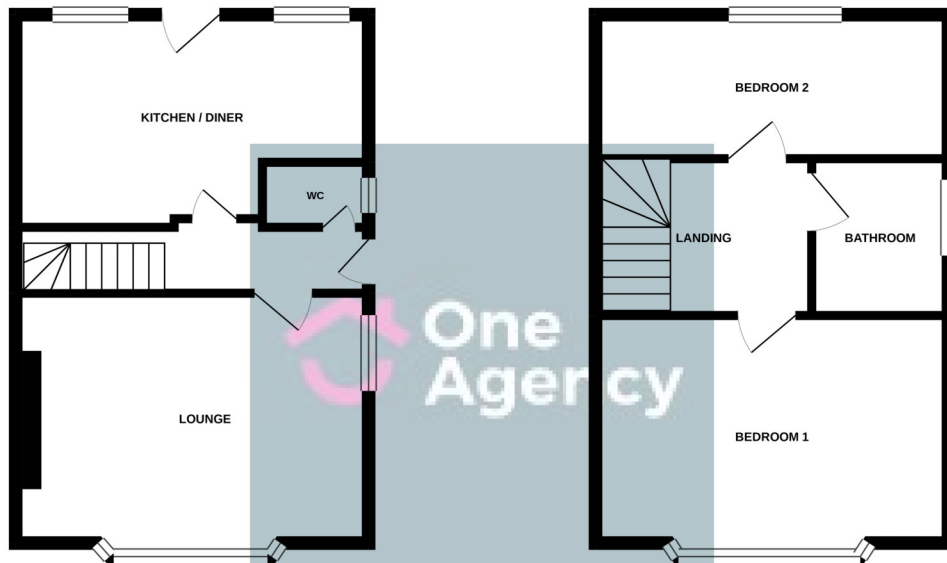

2 BED SEMI DETACHED

TOTAL FLOOR AREA: 710 sq. ft. (65.9 sq. m.) approx.

Whilst every attempt has been made to ensure the accuracy of the floorplan contained here, measurements of doors, windows, rooms and any other items are approximate and no responsibility is taken for any error, omission or mis-statement. This plan is for illustrative purposes only and should be used as such by any prospective purchaser. The services, systems and appliances shown have not been tested and no guarantee as to their operability or efficiency can be given.  
Made with Metropix ©2020

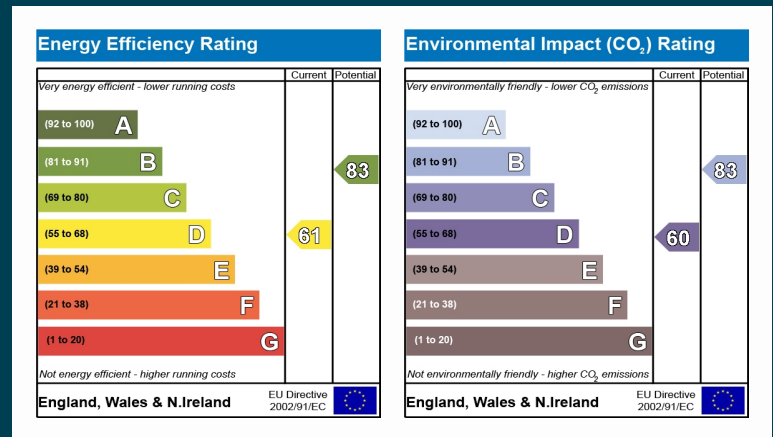

OneAgency, 9 & 10 Ridge House Drive, Festival Park, Stoke-on-Trent, ST1 5SJ

01782 970222

hello@oneagencygroup.co.uk

Every attempt has been made to ensure accuracy, however, all measurements are approximate and for illustrative purposes only. **Not to scale.**

In accordance with The Consumer Protection from Unfair Trading Regulations 2008 the following particulars have been prepared in good faith and they are not intended to constitute part of an offer or contract. We have not carried out a structural survey and the services, appliances and specific fittings have not been tested. All photographs, measurements, floor plans and distances referred to are given as a guide only and should not be relied upon for the purchase of carpets or any other fixtures and fittings. Lease details, service charges and ground rent (where applicable) are given as a guide only and should be checked and confirmed by your Solicitor prior to exchange of contracts.