



Flat F, 13 Mill Street, Kirkcaldy, Fife, KY1 1AD

Beautifully Presented, Two Bedroom, Corner Flat.

Up to date price and viewing info at mov8realestate.com/property

espc rightmove  Zoopla
find your happy

Property Description

Beautifully presented, two-bedroom, corner flat on the first floor of a modern, factored apartment block, set in a residential development in Kirkcaldy, in Fife.

Comprises an entrance hall, living room, dining kitchen, master bedroom with en-suite, a further double bedroom and a bathroom.

Features include good room sizes, uPVC double glazing, gas central heating including a combi-boiler less than six months old, and excellent integral storage space. The property also includes a secure entry system, ample parking in the resident's car park, and well-tended communal grounds.

The entrance hall has carpeted flooring, two storage cupboards, the secure entryphone and serves each room within the flat. With aspects to the front and side, the bright and spacious living room has carpeting and ample room for freestanding dining furniture.

With space for dining furniture, the dining kitchen is fitted with contemporary units, stone effect worktops and a stainless steel sink, with integrated Hotpoint appliances including a gas hob, electric oven, washer/dryer and freestanding fridge/freezer.

The master bedroom features a built-in wardrobe, and a stylish en-suite shower room fitted with a two-piece suite and shower cubicle with an electric shower, whilst the second bedroom likewise has carpeted flooring. Set internally off the hall, the bathroom is fitted with a white three-piece suite with storage and tiled splashbacks.

A 360 Virtual Tour is available online.

mov⁸ REAL ESTATE Flat F 13 Mill Street Kirkcaldy KY1 1AD
Estate Agents and Solicitors Approximate Gross Internal Area: (753 sq ft - 70 sq m.)

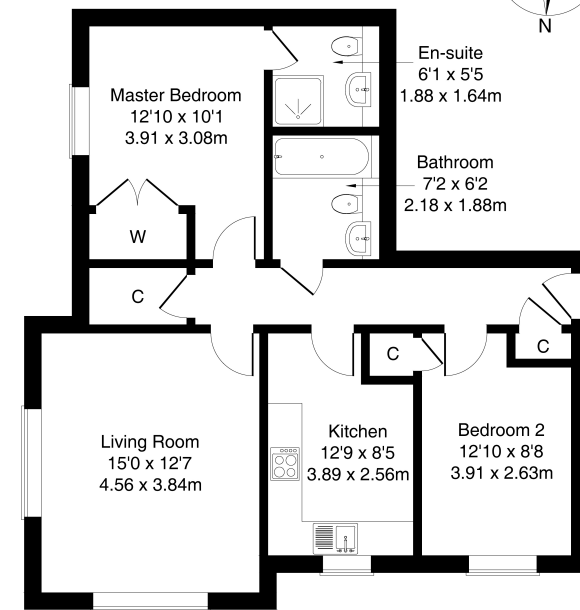

Legal Disclaimer : Floor-plan and measurements are for illustrative guidance only, and not intended to form part of any contract.

Area Description

Kirkcaldy is located on the north coast of the Firth of Forth, and is one of Fife's principal towns. It provides a wide range of retail, cultural and leisure services, as well as primary and secondary schooling, and further education at the Adam Smith College. It is home to a museum and an art gallery, as well as the renowned Adam Smith Theatre. Shopping facilities to be found in the Fife Central Retail

Park include a Sainsbury's, B&Q and Next, with many other high-street names also to be found in the town centre, whilst the modern Victoria Hospital serves much of Fife. The railway station brings Edinburgh and Dundee within easy commuting distance, whilst the A92 allows easy access to the motorway network and Edinburgh Airport.





Our Services

-  Free pre-sale property valuations
-  Great value fixed estate agency fees
-  Extensive buyer matching database
-  Purchase and sale conveyancing

Contact Us

0345 646 0208

sales@mov8realestate.com

www.mov8.com

Head Office

6 Redheughs Rigg, Edinburgh, EH12 9DQ

Glasgow Office

77 Renfrew Street, Glasgow, G2 3BZ



Estate Agents and Solicitors



These particulars do not form part of any contract and the statements or plans contained herein are not warranted nor are they to scale. All descriptions, dimensions, areas, reference to condition and necessary permissions for use and occupation and other details are given in good faith, and are believed to be correct, but any prospective purchaser should not rely on them as statements or representations of fact, and any prospective purchaser must satisfy themselves by inspection or otherwise as to the correctness of each of them. The Seller shall not be bound to accept the highest or any offer nor to accept a full offer of the Fixed Price where this is applicable. Approximate measurements have been taken by sonic device and measurements are most often taken to the widest point of any room or space. Services and appliances have not been tested for efficiency or safety and no warranty is given as to their compliance with any Regulations. Offers should be made using the Combined Standard Clauses.