



Day & Co  
ESTATE AGENTS

28 Cavendish Street  
Keighley  
BD21 3RG



13 Mannville Walk, Keighley,  
West Yorkshire, BD22 6AQ

£109,995

T: 01535 664609

W: [www.dayandcoestateagents.co.uk](http://www.dayandcoestateagents.co.uk)

E: [keighley@dayandcoestateagents.co.uk](mailto:keighley@dayandcoestateagents.co.uk)



- MID TOWN HOUSE
  - POPULAR LOCATION
  - GARDEN & YARD
- TWO BEDROOMS
  - GAS CENTRAL HEATING & DOUBLE GLAZING
  - EPC RATING D

SUMMARY

\*\* MID TOWN HOUSE, TWO BEDROOMS, LOUNGE & DINING KITCHEN, POPULAR LOCATION, GAS CENTRAL HEATING, DOUBLE GLAZING, FRONT GARDEN, REAR YARD, MAY APPEAL TO A VARIETY OF BUYERS, NO ONWARD CHAIN, EPC RATING D \*\*

FULL DESCRIPTION

Day & Co are pleased to be marketing for sale this two bedroom through terrace, handily placed for access to local schools, amenities, and Keighley town centre. This property offers accommodation which may suit a variety of buyers briefly comprises of a lounge with double glazed window and front entrance door. The dining kitchen has a range of base and wall mounted units, cooker, useful under stairs storage cupboard, double glazed window and door to the rear. To the first floor there are two bedrooms, the second bedroom having a built in wardrobe. The house bathroom completes the accommodation having a three piece modern suite in white comprising of a bath WC, wash hand basin.

Gas central heating and double glazing.

Externally there is a front garden and a yard at the rear.

No onward chain.

EPC Rating D

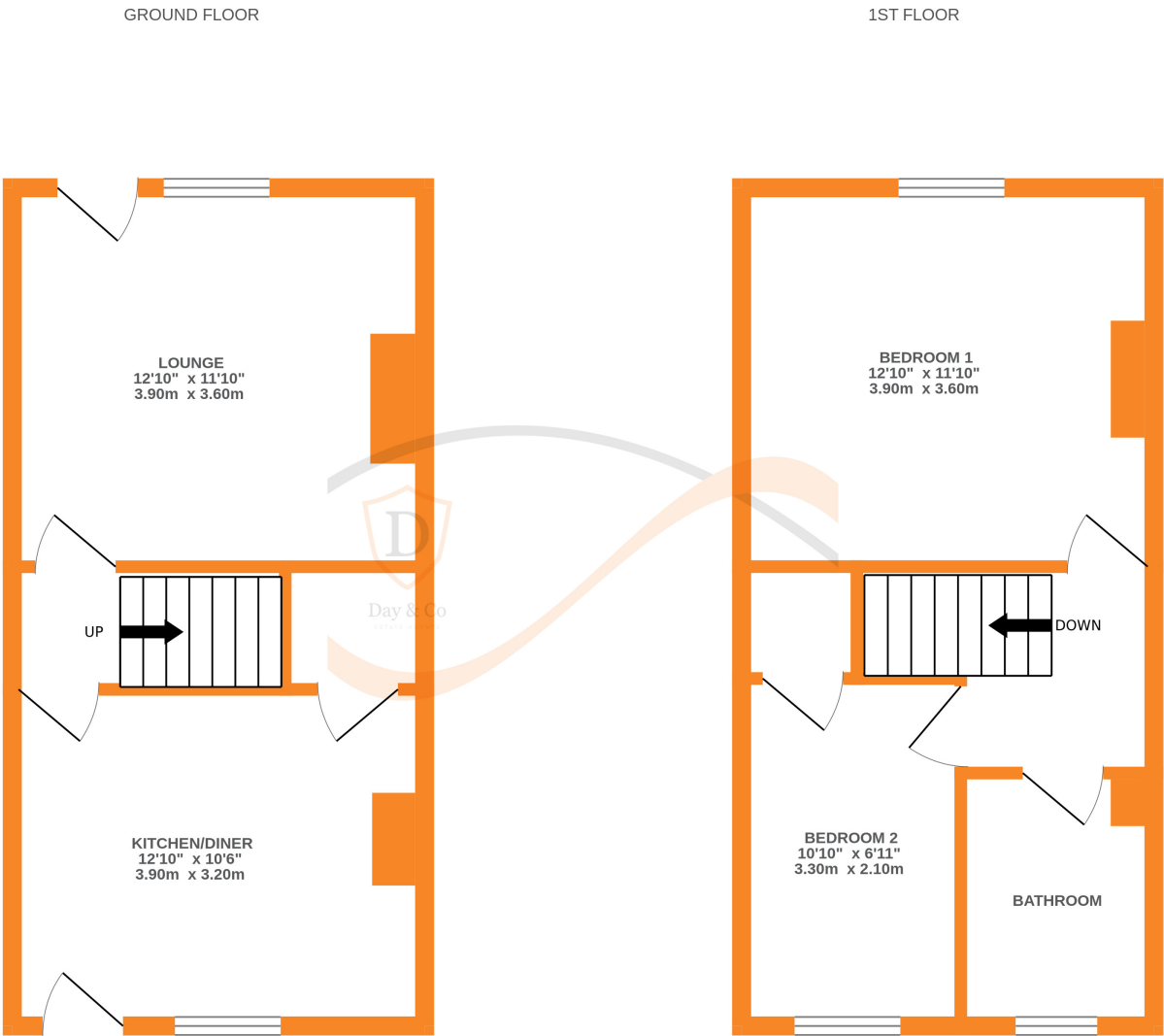

Whilst every attempt has been made to ensure the accuracy of the floorplan contained here, measurements of doors, windows, rooms and any other items are approximate and no responsibility is taken for any error, omission or mis-statement. This plan is for illustrative purposes only and should be used as such by any prospective purchaser. The services, systems and appliances shown have not been tested and no guarantee as to their operability or efficiency can be given.  
Made with Metropix ©2025