



11 The Green, St Leonards-on-Sea, East
Sussex, TN38 0SU

£1,000,000



- Stunning Detached Family Home
- Dual Aspect Lounge Overlooking Rear Garden
- Grand Dining Room Boasting Original Features
- Fitted Kitchen With Additional Larder & Laundry Room
- Spacious additional Family Room
- Separate Study Area
- Five Well Proportioned Double Bedrooms
- Two 1st Floor Fully Equipped Bathrooms
- Impressive Entrance Hall & Landing
- Ground Floor WC
- Very Accessible Loft Areas
- Private & Manicured Gardens
- Gated Driveway & Parking For Several Cars
- Single Detached Garage
- Excellent Condition Throughout
- Sought After St Leonards Location
- Viewing Highly Recommended

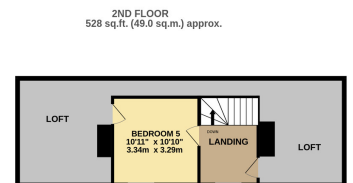
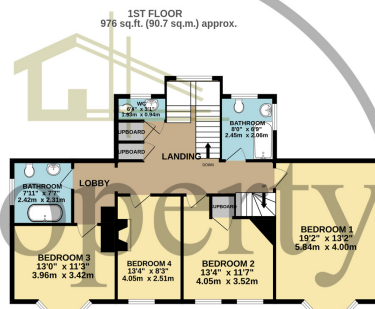

TOTAL FLOOR AREA: 2721 sq.ft. (252.7 sq.m.) approx.

Whilst every attempt has been made to ensure the accuracy of the floorplan contained here, measurements of doors, windows, rooms and any other items are approximate and no responsibility is taken for any error, omission or mis-statement. This plan is for illustrative purposes only and should be used as such by any prospective purchaser. The services, systems and appliances shown have not been tested and no guarantee as to their operability or efficiency can be given.
Made with Metropro ©2024