



- Situated Within Easy Reach Of Colchester's City Centre
- Tastefully Decorated & Upgraded
- On Street Parking Available
- 'New Town' District Of Colchester City Centre
- Newly Fitted Bathroom Suite
- Large Loft Space Ideal For Storage
- Ideal First Time Purchase & Suitable For Any Working Professional

26 Albion Grove, Colchester, Colchester, Essex. CO2 7RZ.

Situated in the heart of New Town and just moments from Colchester's historic and vibrant city centre, this charming three-bedroom end-of-terrace period home offers the perfect blend of character and convenience. Only a stone's throw from a wide range of amenities including shops, restaurants, bars, and excellent transport links it makes an ideal first-time purchase or a fantastic home for working professionals.



Property Details.

Ground Floor

Living Room



14' 9" x 11' 2" (4.50m x 3.40m)

Kitchen



11' 2" x 8' 0" (3.40m x 2.44m)

Utility Room



Bathroom



First Floor

Bedroom One



11' 2" x 10' 0" (3.40m x 3.05m)

Bedroom Two



12' 9" x 6' 4" (3.89m x 1.93m)

Property Details.

Bedroom Three



11' 6" x 6' 6" (3.51m x 1.98m)

Property Details.

Floorplans

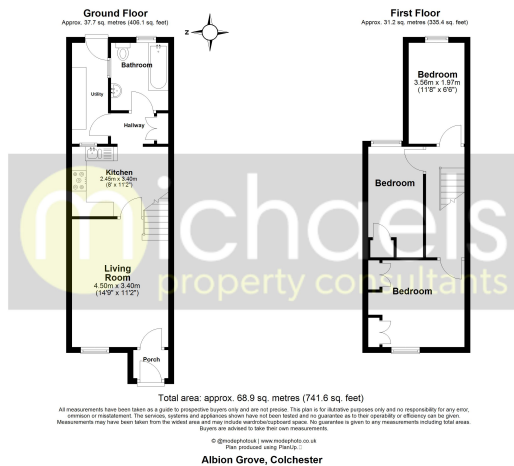

Location

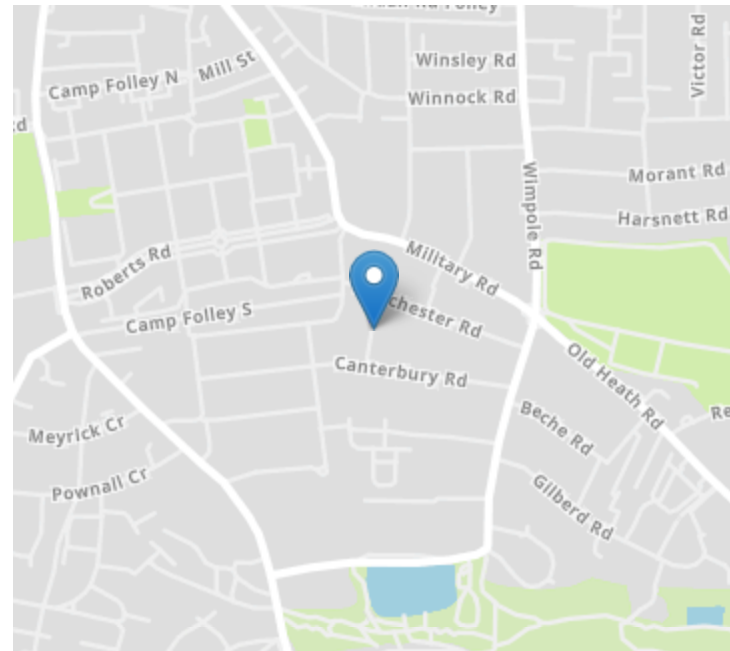

Energy Ratings

We have not carried out a structural survey and the services, appliances and specific fittings have not been tested. All photographs, measurements, floor plans and distances referred to are given as a guide only and should not be relied upon for the purchase of carpets or any other fixtures or fittings. Gardens, roof terraces, balconies and communal gardens as well as tenure and lease details cannot have their accuracy guaranteed for intending purchasers. Lease details, service ground rent (where applicable) are given as a guide only and should be checked and confirmed by your solicitor prior to exchange of contracts.