

TO LET
£1,300 pcm

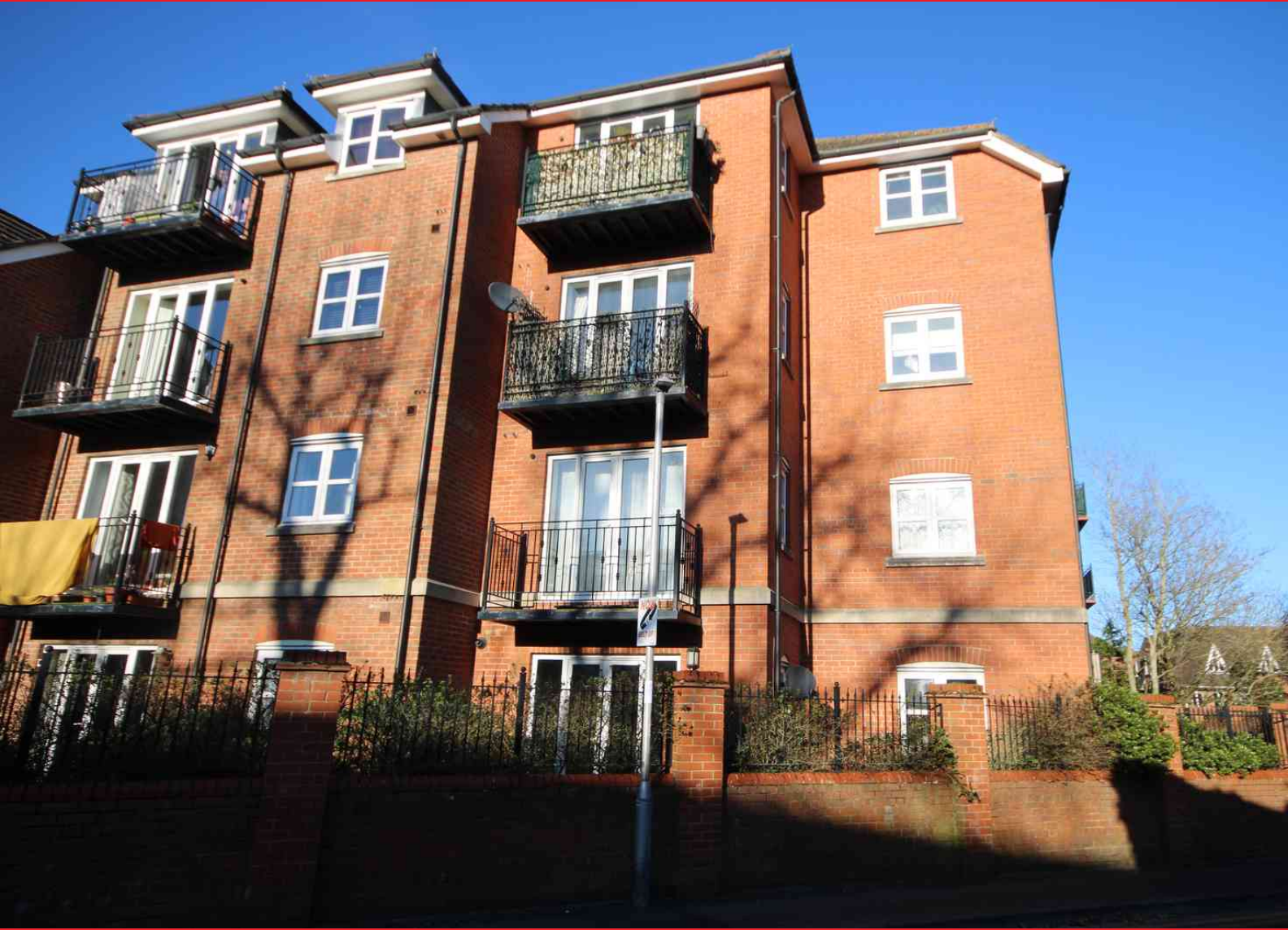

DESCRIPTION

A luxurious ground floor apartment situated behind imposing wrought iron electronic gates in the heart of the medieval market town of Newbury within walking distance of the railway station.

INTERNAL VIEWING IS HIGHLY RECOMMENDED

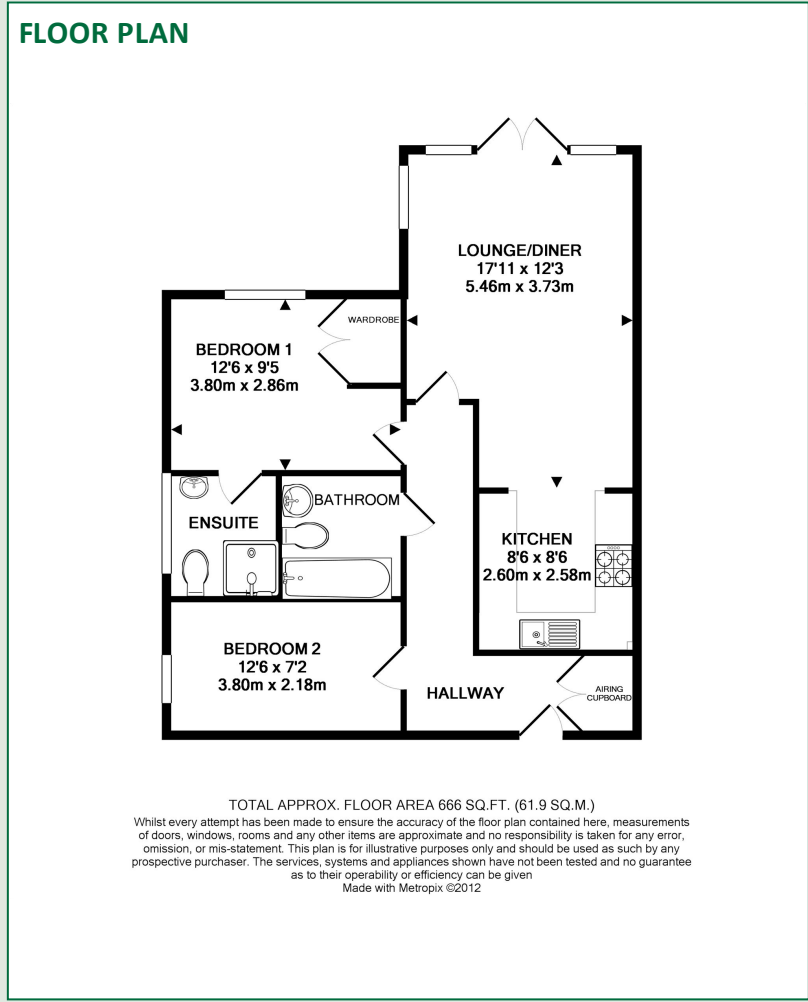

- Town centre location**
- Parking**
- set behind electric gates**
- Ground floor apartment**
- Two bedrooms**
- Two bathrooms**
- Available immediately**

