

Whilst every attempt has been made to ensure the accuracy of the floor plan contained here, measurements of doors, windows, rooms and any other items are approximate and no responsibility is taken for any error, omission, or mis-statement. This plan is for illustrative purposes only and should be used as such by any prospective purchaser. The services, systems and appliances shown have not been tested and no guarantee as to their operability or efficiency can be given.  
Made with Metropix ©2016

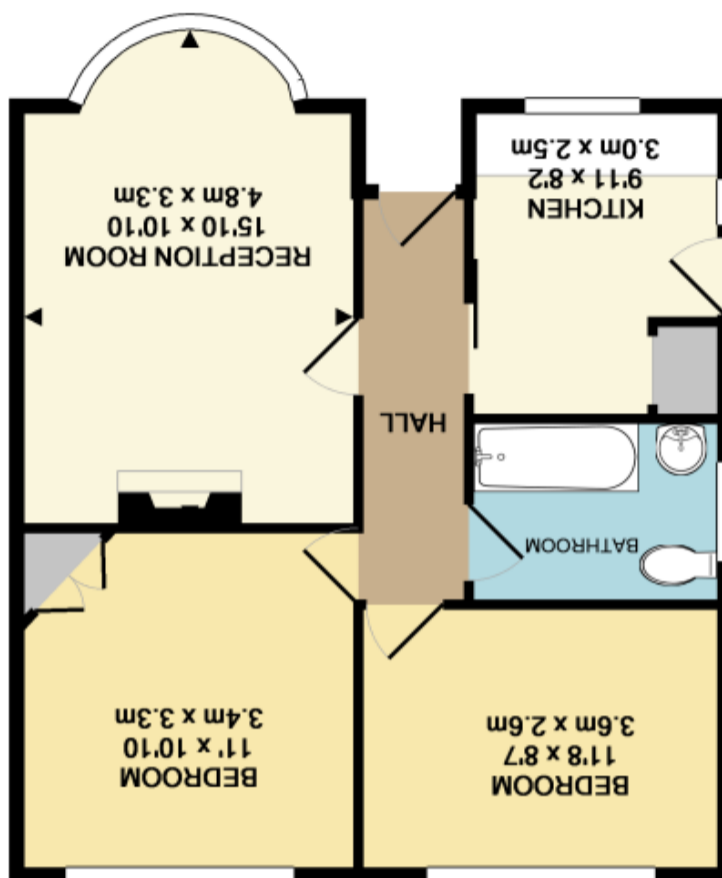

TOTAL APPROX. FLOOR AREA 555 SQ.FT. (51.5 SQ.M.)



## 19 Ashley Park Crescent, YORK YO31 1HJ

Situated in this popular area just off Stockton Lane is this two bedroom semi detached bungalow in need of modernisation. Briefly comprising; spacious sitting room with a large bay window, two good sized bedrooms, three piece bathroom and a kitchen. Externally the bungalow benefits from front and rear gardens, garage and ample off street parking.

Likely to appeal to a wide range of buyers, early viewing is highly recommended to avoid disappointment.

- Semi Detached Bungalow
- Bay Window in the Lounge
- Two Bedrooms
- Front and Rear Gardens
- Driveway
- Garage
- Desirable Location
- Potential to Improve

Travelling on Stockton Lane from the City Centre, turn right on to Algarth Road which in turn leads on to Applecroft Road. The turning for Ashley Park Crescent will be seen to the left and the bungalow can be found on the left hand side. Please note that there is NO for sale sign here.

Located off Stockton Lane ideal for access into York City Centre, the local amenities, Vangarde and Monks Cross Retail and Leisure Parks. For commuters the A64 and A1237 is accessible and local bus routes.

