



## 73 Whitecraigs, Kinnesswood, Kinross-shire, KY13 9JN

Exceptionally Spacious Four Bedroom Detached Bungalow

Up to date price and viewing info at [mov8realestate.com/property](https://www.mov8realestate.com/property)

éspc rightmove  Zoopla  
find your happy

# Property Description

Beautifully presented and exceptionally spacious, four-bedroom, detached bungalow, with uninterrupted views of Loch Leven, private gardens and a double garage. Set within a quiet residential cul-de-sac, the property is located in a rural setting in the village of Kinnesswood, Kinross-shire. Externally, the property benefits from a multi-car mono-bloc driveway leading to the attached double garage with an up and over electric door, and there are gardens on all sides that are bordered by timber fencing and laurel hedging. The mature rear garden is laid to lawn with mono-bloc patios and pathways, and has a sizeable summer house with adjoining timber decking.

A recessed doorway leads to an entrance vestibule where there are doors to a storage cupboard and the cloakroom/WC. A further door opens into the expansive reception hall that is presently used as a family room and has French doors to the lounge and to the rear garden. There is also access to the dining room and to the kitchen. The bright living room benefits from windows to three aspects, accentuating the impressive views across open farmlands to Loch Leven. There is also a feature fireplace, coving, carpeted flooring and recessed spot lighting. The dining room, which is accessed from the family room and the kitchen, features a bay window overlooking the front garden with views towards Bishop Hill, and has ample space for freestanding furniture.

The spacious dining kitchen has French doors out to the side garden, which can also be accessed via the separate utility room. The kitchen itself has fitted wall and base units, a sink with drainer, tiled splashbacks, and integrated appliances including a double oven, fridge, ceramic hob with canopy above, and a dishwasher. The freestanding fridge/freezer, washing machine, and condenser dryer housed in the utility room may be available by negotiation.

A door separates the living spaces from the bedrooms and opens into an inner hallway where there are doors to the four bedrooms, to the family bathroom, and to a storage cupboard which houses the hot water tank. All four double bedrooms are well-proportioned and have carpeted flooring, coving, spot lighting, and built-in wardrobes with sliding mirrored doors. The spacious master bedroom offers an en-suite shower room with a shower cubicle, bidet, and tiled splashwalls. The family bathroom consists of a contemporary five-piece suite with a jacuzzi bath, a high-specification shower, and tiled flooring and splashwalls.

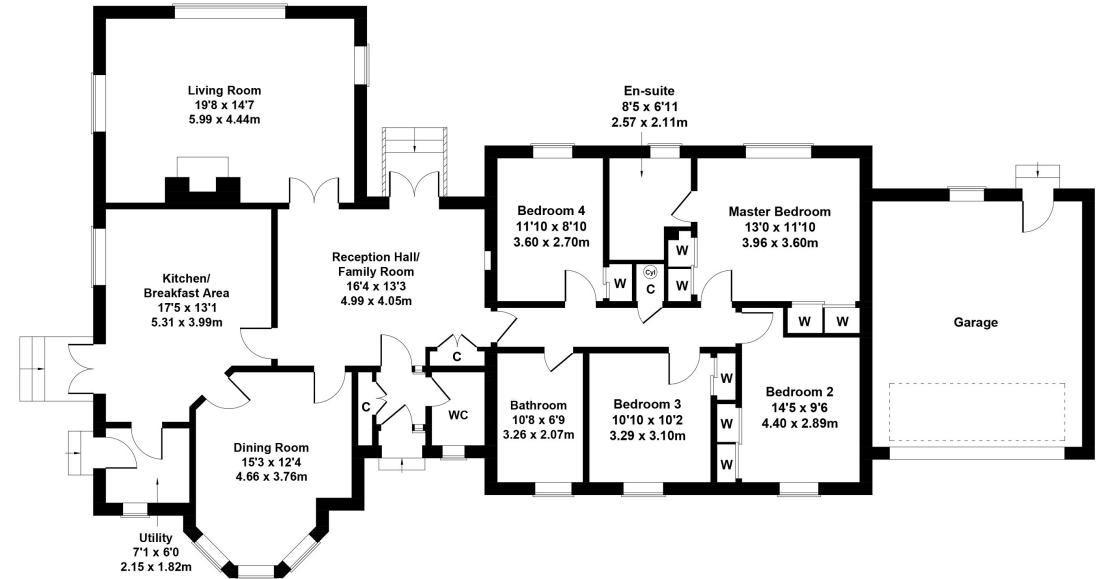

# Area Description

Lying just to the east of Loch Leven, and nestled along the base of the Lomond Hills, the village of Kinnesswood is situated in Kinross-shire and offers a quiet idyll with excellent links to amenities throughout the region. The village itself has a local shop and Portmoak Primary School, while additional supermarkets, entertainment, and amenities are easily accessible in the nearby towns

of Kinross, Perth and Glenrothes. The property is very conveniently placed for access to the M90, and there is also a railway station at Thornton and Lochgelly for further onward travel as well as a Park & Ride facility in Kinross. There is a wealth of outdoor recreational opportunities available in the area, with the historic ruins of Loch Leven Castle nearby.





### Our Services

- Free pre-sale property valuations
- Great value fixed estate agency fees
- Extensive buyer matching database
- Purchase and sale conveyancing

### Contact Us

0345 646 0208

sales@mov8realestate.com

www.mov8.com

### Head Office

6 Redheughs Rigg, Edinburgh, EH12 9DQ

### Glasgow Office

77 Renfrew Street, Glasgow, G2 3BZ



Estate Agents and Solicitors

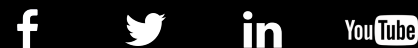

These particulars do not form part of any contract and the statements or plans contained herein are not warranted nor are they to scale. All descriptions, dimensions, areas, reference to condition and necessary permissions for use and occupation and other details are given in good faith, and are believed to be correct, but any prospective purchaser should not rely on them as statements or representations of fact, and any prospective purchaser must satisfy themselves by inspection or otherwise as to the correctness of each of them. The Seller shall not be bound to accept the highest or any offer nor to accept a full offer of the Fixed Price where this is applicable. Approximate measurements have been taken by sonic device and measurements are most often taken to the widest point of any room or space. Services and appliances have not been tested for efficiency or safety and no warranty is given as to their compliance with any Regulations. Offers should be made using the Combined Standard Clauses.