



Thorntons
The right way to move

Pitnappie Farm House,
Newtyle, Blairgowrie, Angus
PH12 8UR





Summary

Nestled in the heart of the Angus countryside, Pitnappie Farm House offers a rare opportunity to enjoy rural tranquillity while remaining within easy reach of Perth (18 miles) and Dundee (10 miles). This charming two bedroom detached cottage sits in an idyllic, elevated position, boasting panoramic views across open farmland and rolling hills. The accommodation comprises: bright and spacious lounge, dining kitchen, 2 double bedrooms and family bathroom. The cottage would further benefit from modernisation.

Features

- Charming detached cottage in a rural location
- Stunning panoramic countryside views
- Bright and spacious lounge
- Well-equipped kitchen with room for dining
- Two double bedrooms
- Three Piece Bathroom
- Substantial garden grounds
- Ideal as a permanent home or investment property
- Convenient access to local amenities
- Oil Central Heating

Room Measurements

Front Porch: 2.01m x 1.85m (6'7" x 6'1")
 Bedroom 1: 4.29m x 4.09m (14'1" x 13'5")
 Bedroom 2: 5.31m x 2.59m (17'5" x 8'6")
 Kitchen: 5.08m x 4.75m (16'8" x 15'7")
 Living Room: 5.94 x 4.06m (19'6" x 13'4")
 Study: 2.59m x 1.42m (8'6" x 4'8")
 Rear Porch: 1.88m x 1.57m (6'2" x 5'2")
 Boot Room: 2.62m x 2.62m (8'7" x 8'7")
 Garage: 5.46m x 5.31m (17'11" x 17'5")



Charming detached cottage in a rural
location enjoying excellent countryside
views







This property makes an ideal
permanent home, holiday
accommodation or investment
opportunity



Floorplan

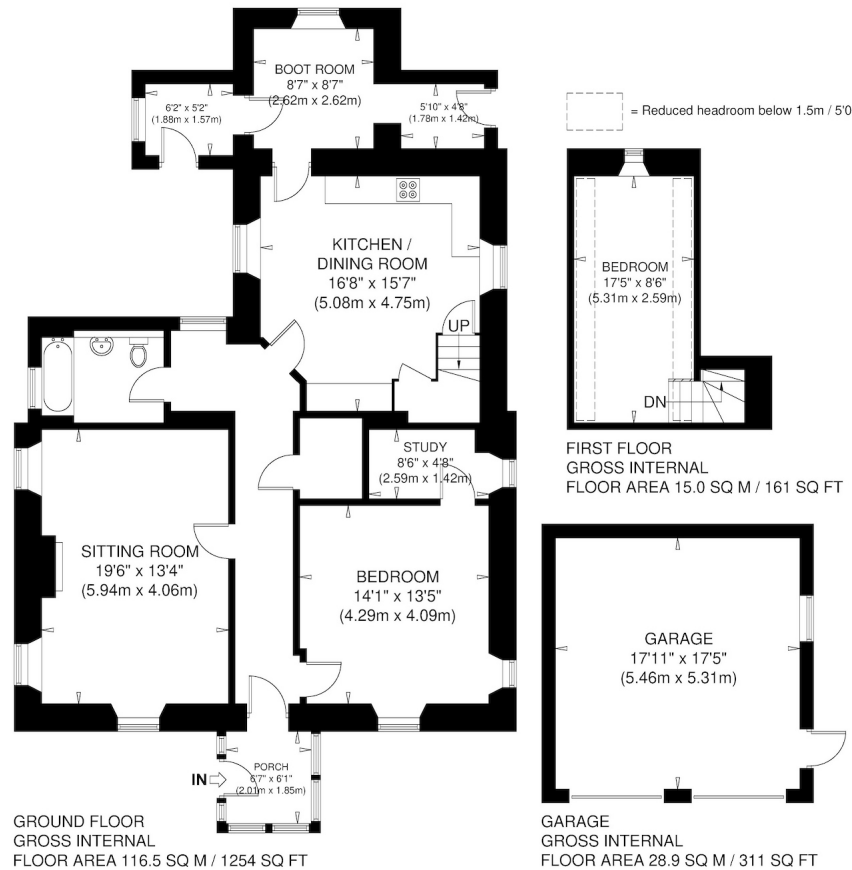

PITNAPPIE FARMHOUSE
NOT TO SCALE - FOR ILLUSTRATIVE PURPOSES ONLY
APPROXIMATE GROSS INTERNAL FLOOR AREA 131.5 SQ M / 1415 SQ FT
GARAGE FLOOR AREA 28.9 SQ M / 311 SQ FT
TOTAL COMBINED FLOOR AREA 160.4 SQ M / 1726 SQ FT
All measurements and fixtures including doors and windows
are approximate and should be independently verified.

Copyright © exposure
www.photographyandfloorplans.co.uk

Thorntons

The right way to move



Our Branches

ANSTRUTHER

5A Shore Street, Anstruther, KY10
3EA
01333 310481
anstrutherea@thorntons-law.co.uk

ARBROATH

Brothockbank House, Arbroath,
DD11 1NE
01241 876633
arbroathea@thorntons-law.co.uk

BONNYRIGG

3-5 High Street, Bonnyrigg, EH19
2DA
0131 663 7135
bonnyriggea@thorntons-law.co.uk

EDINBURGH

Citypoint, 3rd Floor, 65 Haymarket
Terrace, Edinburgh, EH12 5HD
0131 297 5980
edinburghea@thorntons-law.co.uk

CUPAR

49 Bonnygate, Cupar, KY15 4BY
01334 656564
cuparea@thorntons-law.co.uk

DUNDEE

Whitehall House, 33 Yeaman Shore,
Dundee DD1 4BJ
01382 200099
dundeaea@thorntons-law.co.uk

FORFAR

53 East High Street, Forfar, DD8 2EL
01307 466886
forfarea@thorntons-law.co.uk

PERTH

7 Whitefriars Crescent, Perth, PH2
0PA
01738 443456
perthea@thorntons-law.co.uk

INVERNESS

Kintail House, 2 Sir Walter Scott
Drive, Inverness, IV2 3BW
01463 383977
genea@thorntons-law.co.uk

ST ANDREWS

19-21 Bell Street, St Andrews
01334 474200
standrewsea@thorntons-law.co.uk

Thorntons is a trading name of Thorntons Law LLP Regulated by The Law Society of Scotland



@ThorntonsPropertyServices



@ThorntonsProperty



@ThorntonsPS