

# Frenchfields Crescent, Clock Face, £450,000

Offers Over



Nestled in the Bold Forest Park, between the Cheshire village of Burtonwood and the St Helens sits this exclusive development of 17 individually built houses, this dwelling offers a unique and contemporary design with high-quality fixtures and fittings throughout and really must be viewed internally in order to fully appreciate exactly what is on offer here.



x 4



x 3

[See more of this house at ashtons.net](https://www.ashtons.net)



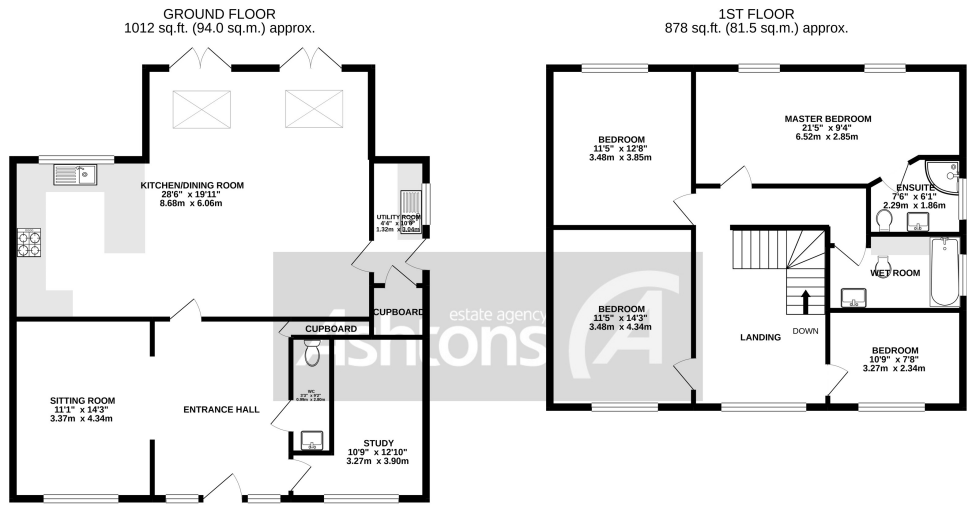

TOTAL FLOOR AREA : 1890 sq.ft. (175.6 sq.m.) approx.  
 Whilst every attempt has been made to ensure the accuracy of the floorplan contained here, measurements of doors, windows, rooms and any other items are approximate and no responsibility is taken for any error, omission or mis-statement. This plan is for illustrative purposes only and should be used as such by any prospective purchaser. The services, systems and appliances shown have not been tested and no guarantee as to their operability or efficiency can be given.  
 Made with Metropac ©2021

Nestled in the Bold Forest Park, between the Cheshire village of Burtonwood and the St Helens sits this exclusive development of 17 individually built houses, this dwelling offers a unique and contemporary design with high quality fixtures and fittings throughout and really must be viewed internally in order to fully appreciate exactly what is on offer here.

Situated within green belt land, nestling between the towns of St Helens and Warrington, this development stands opposite Clock Face country park and is well placed for access to all motorway networks, bringing the



The family bathroom offers a four piece bathroom with Roca furnishings, low level W.C., wash basin with LED mirror, panel bath and shower.

[www.ashtons.net](http://www.ashtons.net)



To the side of the property there is a large sample off road parking and rear garden with a lot of space for entertaining and family BBQs with a laid lawn set behind timber fencing.

**Fixtures and fittings:** A list of the fixtures and fittings included in the purchase price will be provided by the Seller's Solicitors. **Important Notice:** 1. Particulars: These particulars are not an offer or contract, nor part of one. You should not rely on statements by Ashtons in the particulars or by word of mouth or in writing ("information") as being factually accurate about the property, its condition or its value. Neither Ashtons nor any joint agent has any authority to make any representations about the property, and accordingly any information given is entirely without responsibility on the part of the agents, seller(s) or lessor(s). 2. Photos, Videos etc: The photographs, property videos and virtual viewings etc. show only certain parts of the property as they appeared at the time they were taken. Areas, measurements and distances given are approximate only. 3. Regulations etc: Any reference to alterations to, or use of, any part of the property does not mean that any necessary planning, building regulations or other consent has been obtained. A buyer or lessee must find out by inspection or in other ways that these matters have been properly dealt with and that all information is correct. 4. To find out how we process Personal Data, please refer to our Group Privacy Statement and other notices at <https://www.ashtons.net/privacy-policy/>

This property must be viewed to be fully appreciated. Contact us today to discuss this further 01744 754120.