



Sandon Street,
Etruria



OneAgency

01782 970222

hello@oneagencygroup.co.uk



£595 pcm

A two bedroom mid terraced house in the popular location of Etruria. The property is within walking distance to Festival Park & Hanley Town Centre as well as being close to commuter links such as A500, A50 & M6. An ideal rental property for a couple or single occupier which has recently been refurbished. Viewing is highly advised!





Ground Floor

Reception Room

3.51m x 3.34m (11' 6" x 10' 11") UPVC front door, double glazed window to the front, radiator and laminate flooring.

Kitchen

3.49m x 3.44m (11' 5" x 11' 3") A range of wall and base units with worktops, stainless steel sink basin, integral oven and gas hobs with hood over, space for fridge/freezer, plumbing for a washing machine, double glazed window, radiator and laminate flooring.

Bathroom

2.04m x 1.79m (6' 8" x 5' 10") A white suite with bath and overhead shower unit, pedestal hand wash basin, low level W/C, double glazed window, radiator and vinyl flooring.

First Floor

Bedroom One

3.49m x 3.48m (11' 5" x 11' 5") A double glazed window to the rear, radiator and carpet flooring.

Bedroom Two

3.54m x 3.37m (11' 7" x 11' 1") A double glazed window to the front, radiator and carpet flooring.

External

A paved rear yard with gated access.

AGENTS NOTES

The council tax band is A. The local authority is Stoke-on-Trent.



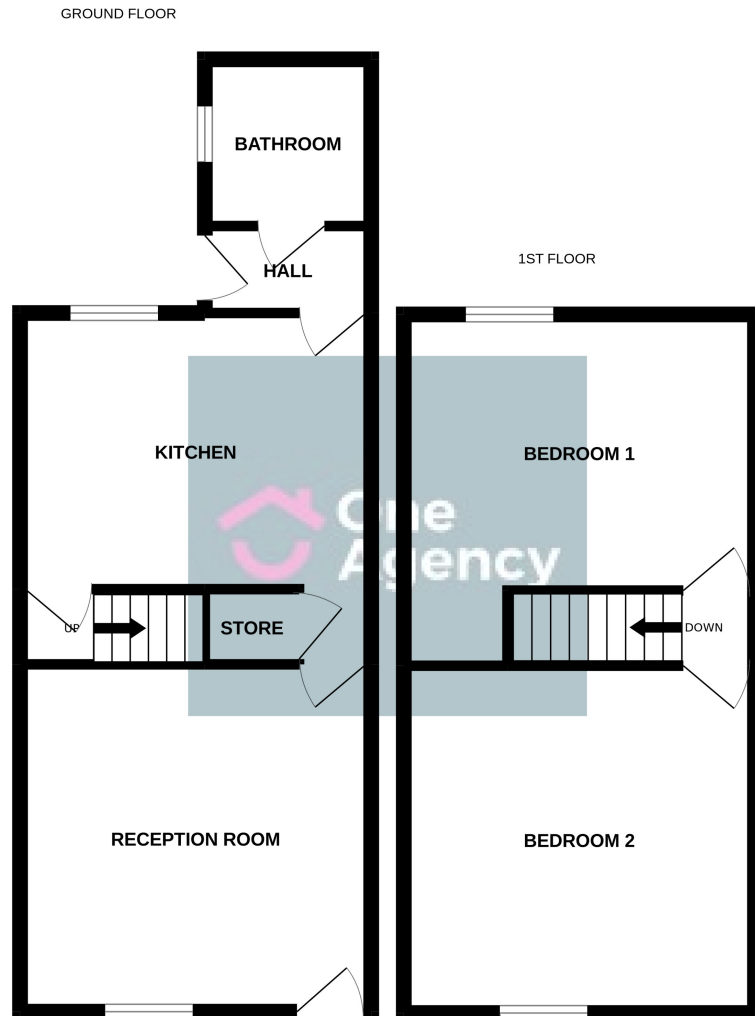

Whilst every attempt has been made to ensure the accuracy of the floorplan contained here, measurements of doors, windows, rooms and any other items are approximate and no responsibility is taken for any error, omission or mis-statement. This plan is for illustrative purposes only and should be used as such by any prospective purchaser. The services, systems and appliances shown have not been tested and no guarantee as to their operability or efficiency can be given.
Made with Metropix ©2022

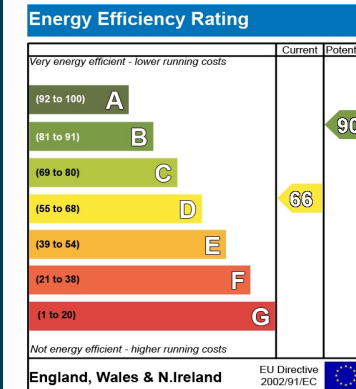

OneAgency, 9 & 10 Ridge House Drive, Festival Park, Stoke-on-Trent, ST1 5SJ

01782 970222

hello@oneagencygroup.co.uk

Every attempt has been made to ensure accuracy, however, all measurements are approximate and for illustrative purposes only. **Not to scale.**

In accordance with The Consumer Protection from Unfair Trading Regulations 2008 the following particulars have been prepared in good faith and they are not intended to constitute part of an offer or contract. We have not carried out a structural survey and the services, appliances and specific fittings have not been tested. All photographs, measurements, floor plans and distances referred to are given as a guide only and should not be relied upon for the purchase of carpets or any other fixtures and fittings. Lease details, service charges and ground rent (where applicable) are given as a guide only and should be checked and confirmed by your Solicitor prior to exchange of contracts.