



26 Windsor Way, Langford, Bedfordshire, SG18 9PB

£399,995

Bright and spacious two double bedroom semi-detached bungalow situated in a quiet cul-de-sac location yet close at hand to village amenities. Offered with re-fitted kitchen with built in appliances plus useful utility room, large living room with bi-fold doors overlooking the rear garden and good sized shower room. Off road parking is provided by a driveway and a larger than average garage with electric up and over door. The secluded rear garden extends to approx 100ft and enjoys views over countryside. NO CHAIN - WELL WORTH A LOOK



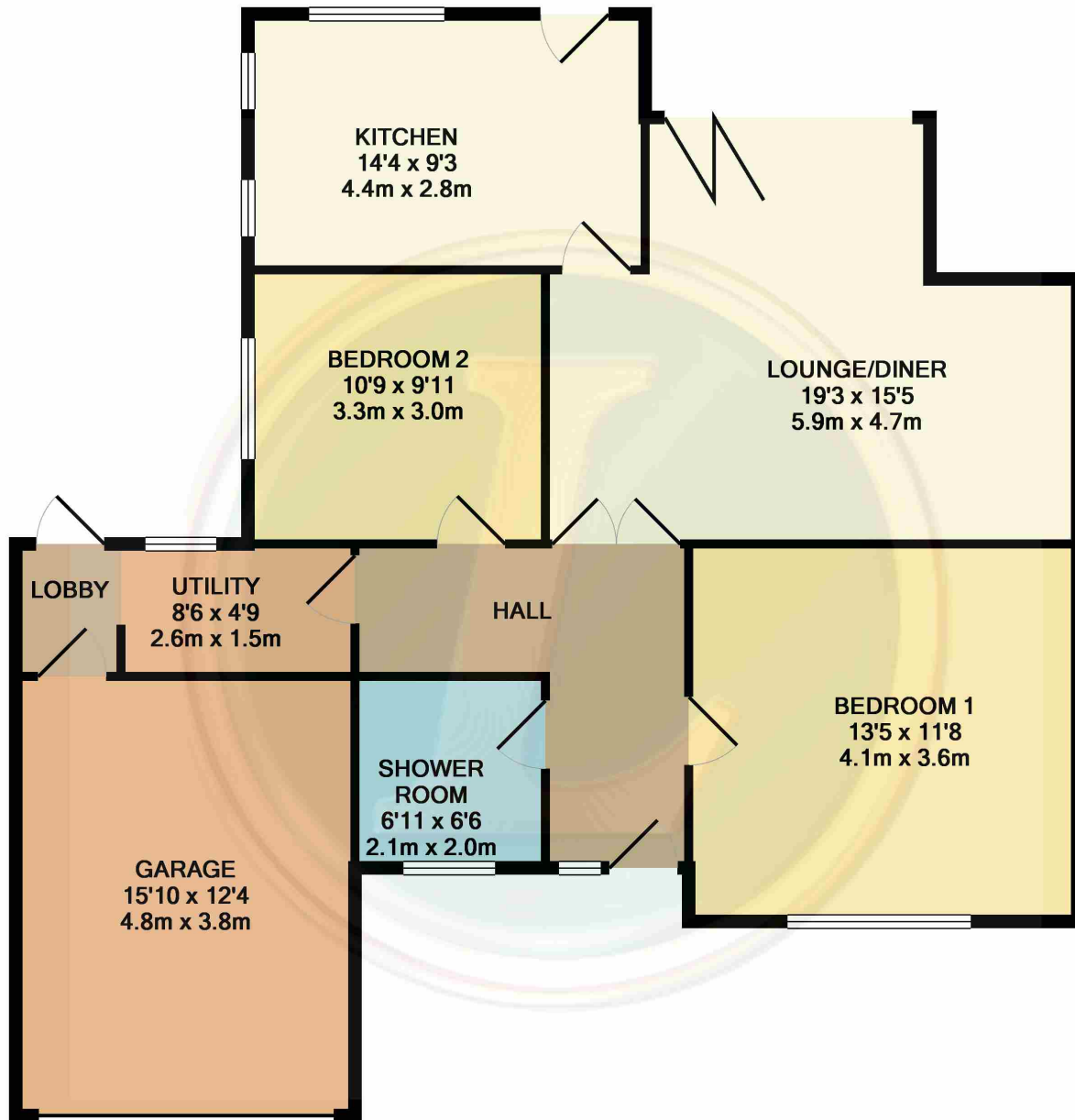

TOTAL APPROX. FLOOR AREA 1073 SQ.FT. (99.6 SQ.M.)
Measurements are approximate. Not to scale. Illustrative purposes only
Made with Metropix ©2018

- TWO DOUBLE BEDROOM SEM-DETACHED BUNGALOW
- LOUNGE/DINING ROOM WITH BI-FOLDING DOORS TO REAR
- KITCHEN/BREAKFAST ROOM WITH BUILT IN APPLIANCES
- 100ft GARDEN WITH VIEWS OVER FARMLAND
- LARGE GARAGE + DRIVEWAY
- UTILITY ROOM
- GOOD SIZED SHOWER ROOM
- NO CHAIN
- QUIET CUL DE SAC LOCATION
- CLOSE AT HAND TO VILLAGE AMENITIES + BUS STOP

