



26 Windsor Way, Langford, Bedfordshire, SG18 9PB

£399,995

Bright and spacious two double bedroom semi-detached bungalow situated in a quiet cul-de-sac location yet close at hand to village amenities. Offered with re-fitted kitchen with built in appliances plus useful utility room, large living room with bi-fold doors overlooking the rear garden and good sized shower room. Off road parking is provided by a driveway and a larger than average garage with electric up and over door. The secluded rear garden extends to approx 100ft and enjoys views over countryside.



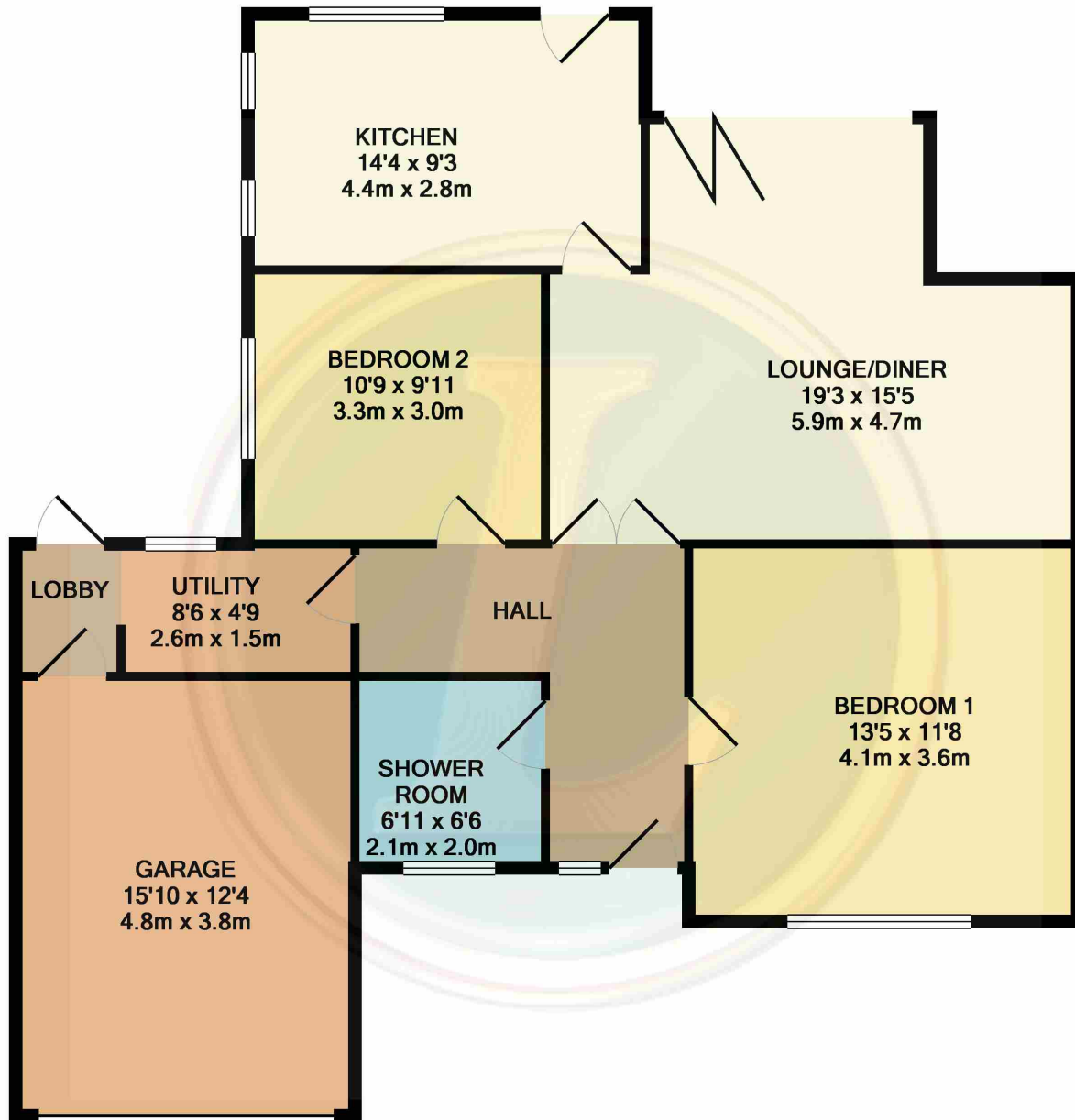

TOTAL APPROX. FLOOR AREA 1073 SQ.FT. (99.6 SQ.M.)
Measurements are approximate. Not to scale. Illustrative purposes only
Made with Metropix ©2018

- TWO DOUBLE BEDROOM SEM-DETACHED BUNGALOW
- LOUNGE/DINING ROOM WITH BI-FOLDING DOORS TO REAR
- KITCHEN/BREAKFAST ROOM WITH BUILT IN APPLIANCES
- 100ft GARDEN WITH VIEWS OVER FARMLAND
- LARGE GARAGE + DRIVEWAY
- UTILITY ROOM
- GOOD SIZED SHOWER ROOM
- QUIET CUL DE SAC LOCATION
- CLOSE AT HAND TO VILLAGE AMENITIES + BUS STOP

