

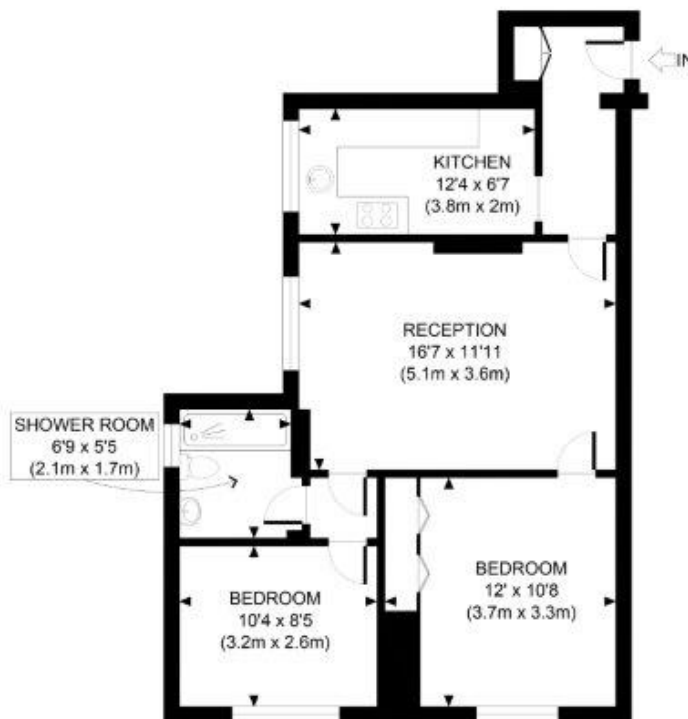

Beacon House, Hemstal Road, London, NW6 2AG

£525,000

- Two Double Bedroom Apartment
- Fitted Kitchen
- Walking Distance to local shops and transport links
- Heating & Hot Water included in Service Charge
- Lower Ground Floor
- Tiled Bathroom
- Chain Free
- 142yr Lease Remaining



LOWER GROUND FLOOR
GROSS INTERNAL
FLOOR AREA 641 SQ FT

APPROX. GROSS INTERNAL FLOOR AREA 641 SQ FT / 60 SQM

Ref: Copyright **photoplan**

Disclaimer: Floor plan measurements are approximate and are for illustrative purposes only. While we do not doubt the floor plan accuracy and completeness, you or your advisors should conduct a careful, independent investigation of the property in respect of monetary valuation

