

Offers in Excess of £265,000
Manse Court, Sidcup Hill, Sidcup, Kent,
DA14 6HX



AGENTS NOTES: No statement in these particulars is to be relied upon as representations of fact and purchasers should satisfy themselves by inspection, or otherwise, as to the accuracy of the statements contained herein. These details do not constitute any part of any offer or contract. Christopher Russell have not tested any equipment or heating system mentioned and purchasers are advised to satisfy themselves as to their working order. Great care is taken when measuring but measurements should not be relied upon for ordering carpets, equipment etc.

Christopher Russell LLP. Registered in Cardiff. Partnership No. OC329088

Extremely well presented two bedroom first floor flat situated in an ideal location for Sidcup High Street and Station ideal for buy to let investors, first time buyers or those looking to downsize.

Having been finished to a very good standard the property comprises of two double bedrooms, a bathroom, a lounge/diner and a modern fitted kitchen.

There is an allocated parking space as well as several visitors bays.

The property benefits from a long lease and well maintained communal garden and features gas central heating, double glazing and an entry phone system.

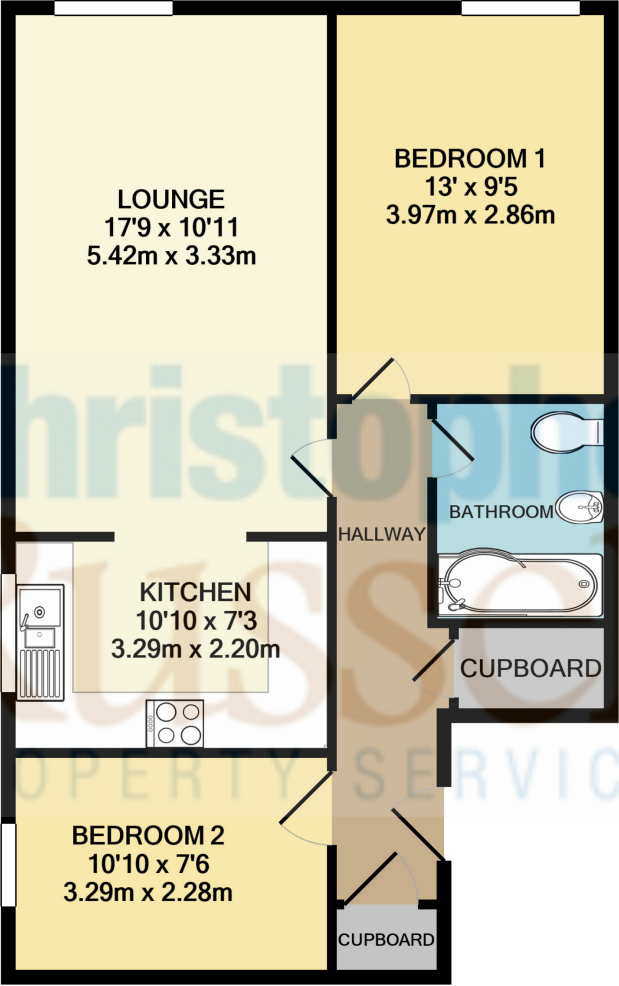

TOTAL APPROX. FLOOR AREA 602 SQ.FT. (55.9 SQ.M.)

Whilst every attempt has been made to ensure the accuracy of the floor plan contained here, measurements of doors, windows, rooms and any other items are approximate and no responsibility is taken for any error, omission, or mis-statement. This plan is for illustrative purposes only and should be used as such by any prospective purchaser. The services, systems and appliances shown have not been tested and no guarantee as to their operability or efficiency can be given

Made with Metropix ©2020

