



## St Faiths Close

Hitchin | Hertfordshire | SG4 0AX

[www.stonegate-estates.co.uk](http://www.stonegate-estates.co.uk)



# ST FAITHS CLOSE

---

## Property Description

Set within easy walking distance of the train station and offered with no upward chain is this well presented and much sought after one bedroom apartment.

Having been well maintained by the current owners, the apartment offers gas central heating, double glazing, a fitted kitchen and a modern bathroom suite.

There is parking and communal gardens along with a large storage cupboard.

The apartment is placed on the first floor of this well maintain and popular development and would suite any first time buyer or investor.

The lease has 101 years remaining and a £10 pa ground rent. Service charge at present is £1244 pa.

Hitchin town provides a broad range of shops and a regular traditional market, together with a good selection of restaurants, bars and pubs within its historic centre. The town also provides a swimming centre, theatres and a library, whilst the commuter is served by the main line railway station (Kings Cross - 30 minutes) and direct links to the A1(M).

**£200,000 Leasehold**





Approximate Gross Internal Area = 47.8 sq m / 514 sq ft

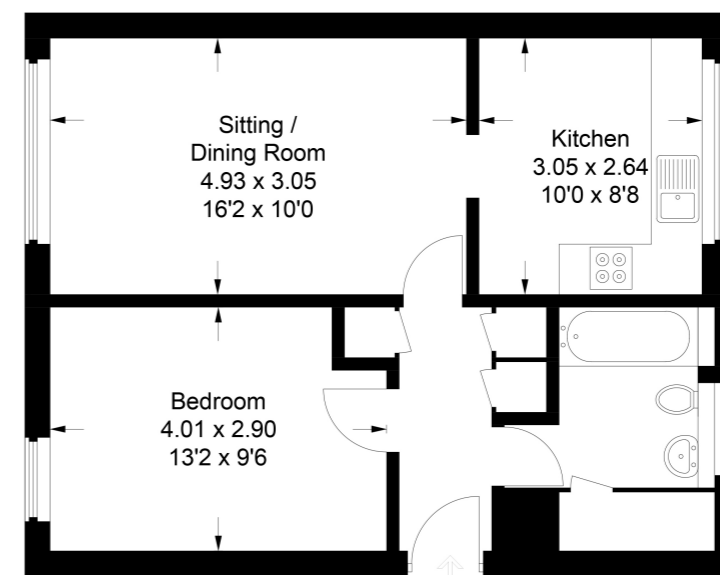

This plan is for layout guidance only. Not drawn to scale unless stated. Windows and door openings are approximate. Whilst every care is taken in the preparation of this plan, please check all dimensions, shapes and compass bearings before making any decisions reliant upon them.  
© CJ Property Marketing Ltd Produced for Stonegate Estates



- One Bedroom Apartment
- First Floor
- Walking distance to Main Line Station
- 101 Year Lease
- Ideal First Time Buy or Investment
- No Chain
- Gas Central Heating
- Modern Bathroom
- Fitted Kitchen

EPC Rating: C

## Stonegate Estate Agents

01462 438979

[sales@stonegate-estates.co.uk](mailto:sales@stonegate-estates.co.uk) | [www.stonegate-estates.co.uk](http://www.stonegate-estates.co.uk)

