



Harrison Court

Hitchin | Hertfordshire |

www.stonegate-estates.co.uk



HARRISON COURT

Property Description

We are delighted to offer for sale this beautifully presented and much improved two bed roomed retirement apartment situated within the ever popular Harrison Court development.

Ideally situated within walking distance of the town centre and the train station, this light and airy apartment has a large bay window to the lounge, a shower room, generous accommodation and no onward chain.

The development has a communal lounge and hairdressing, residents gardens and parking, an on site development manager and laundry facilities and a lift to all floors.

Hitchin town provides a broad range of shops and a regular traditional market, together with a good selection of restaurants, bars and pubs within its historic centre. The town also provides a swimming centre, theatres and a library, whilst the commuter is served by the main line railway station (Kings Cross - 30 minutes) and direct links to the A1(M).

£285,000 Leasehold





Floor Plan
Approx. 62.4 sq. metres (671.8 sq. feet)

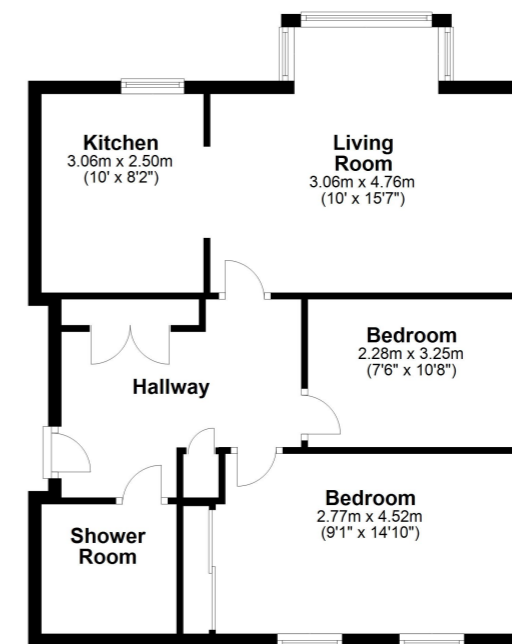

Total area: approx. 62.4 sq. metres (671.8 sq. feet)

All measurements shown are approximate and for guidance only. Garages and workshops are not included in any gross floor areas unless integral to the main building where they will be included.
Plan produced using PlanUp.



- Two Bedroom Retirement Apartment
- Town Centre Location
- Careline 24hr System
- Residents Lounge
- Bay Window to Lounge
- Shower Room
- No Onward Chain
- Development Manager on Site

EPC Rating:

Stonegate Estate Agents

01462 438979

sales@stonegate-estates.co.uk | www.stonegate-estates.co.uk

