



Cormie Close,  
Chell Heath



**OneAgency**

01782 970222

[hello@oneagencygroup.co.uk](mailto:hello@oneagencygroup.co.uk)



£650 pcm

A well presented two bedroom semi-detached house in a popular location. The property benefits from off road parking, kitchen/diner and front and rear gardens. The property is local to amenities, commuter links and schools. Ready to move in. Viewing is highly advised!





## Ground Floor

### Lounge

4.03m x 3.79m (13' 3" x 12' 5") A double glazed window to the front, radiator and carpet flooring.

### Kitchen/Diner

4.01m x 2.92m (13' 2" x 9' 7") A range of wall and base units with worktops, stainless steel sink basin, space for a cooker, plumbing for a washing machine, space for a fridge/freezer, double glazed window to the rear, sliding door to the garden, radiator and vinyl flooring.

## First Floor

### Bedroom One

4.03m x 2.44m (13' 3" x 8' 0") A double glazed window to the rear, radiator and carpet flooring.

### Bedroom Two

4.04m x 2.30m (13' 3" x 7' 7") A double glazed window to the front, storage space, radiator and carpet flooring.

### Bathroom

2.09m x 1.89m (6' 10" x 6' 2") A suite with bath, pedestal hand wash basin, low level W/C, radiator, double glazed window and vinyl flooring.

### External

Front - A driveway providing off road parking and lawned section.

Rear - A paved patio area, lawned section and fenced borders.



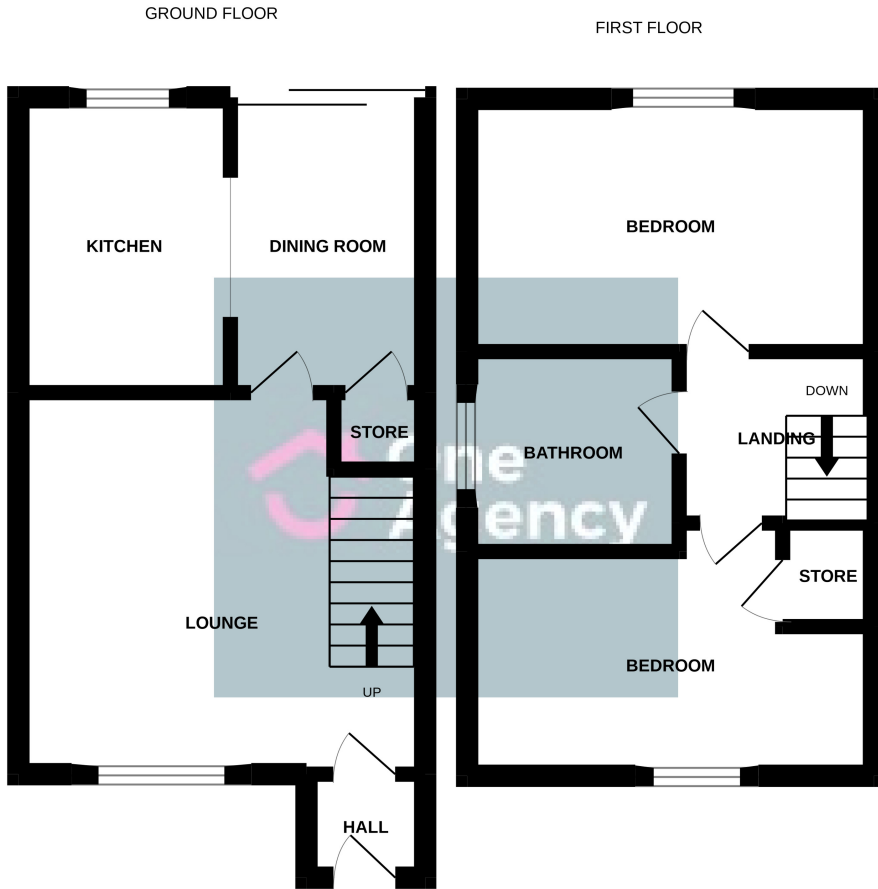

Whilst every attempt has been made to ensure the accuracy of the floorplan contained here, measurements of doors, windows, rooms and any other items are approximate and no responsibility is taken for any error, omission or mis-statement. This plan is for illustrative purposes only and should be used as such by any prospective purchaser. The services, systems and appliances shown have not been tested and no guarantee as to their operability or efficiency can be given.  
Made with Metropix ©2022.

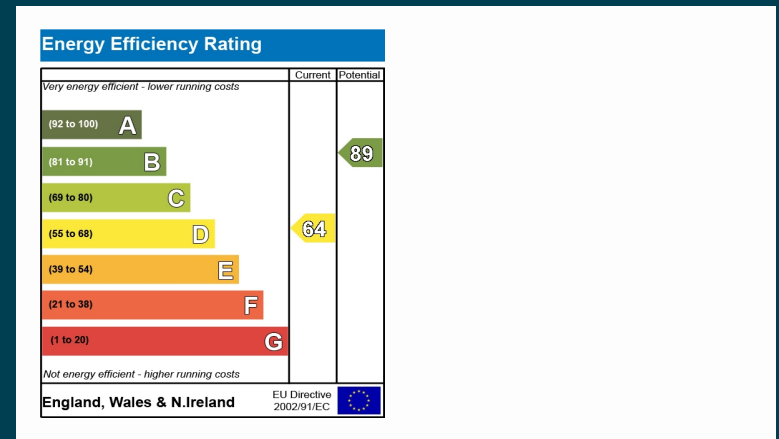

OneAgency, 9 & 10 Ridge House Drive, Festival Park, Stoke-on-Trent, ST1 5SJ

01782 970222

hello@oneagencygroup.co.uk

Every attempt has been made to ensure accuracy, however, all measurements are approximate and for illustrative purposes only. **Not to scale.**

In accordance with The Consumer Protection from Unfair Trading Regulations 2008 the following particulars have been prepared in good faith and they are not intended to constitute part of an offer or contract. We have not carried out a structural survey and the services, appliances and specific fittings have not been tested. All photographs, measurements, floor plans and distances referred to are given as a guide only and should not be relied upon for the purchase of carpets or any other fixtures and fittings. Lease details, service charges and ground rent (where applicable) are given as a guide only and should be checked and confirmed by your Solicitor prior to exchange of contracts.